



EBARA

ISO 9002
KEMA
CERT. NR. 98922
DUTCH COUNCIL FOR ACCREDITATION



SELF PRIMING PUMP

MODEL SQPB



APPLICATIONS

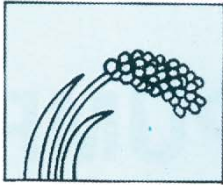

Irrigation



Drainage

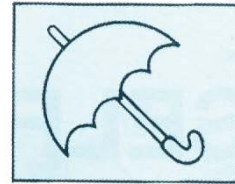

Sprinklers

FEATURES

1. No priming is required excepting for initial use.
2. Special designed casing provides very rapid priming for extended piping
3. Maintenance is facilitated due to packing type.
4. Water mixed with a little sand or mud can be pumped up due to semi - open impeller design.
5. Easy installation with engine for belt driven due to c.c.w rotation.

SPECIFICATION MODEL SQPB

| DISCRIPTION | STANDARD | OPTION |
|--------------|---|-----------------|
| Liquid | Fresh water, river water rain water | sea water |
| Temperature | 0-40°C | |
| Reg.NPSH | 4 m | |
| Rotation | Counter clockwise when viewed from drive end | |
| Installation | Outdoors | |
| Material | | |
| Casing | Cast iron | Bronze |
| Impeller | Cast iron | Bronze |
| Shaft | Carbon steel | Stainless steel |
| Constraction | | |
| Impeller | Semi open | |
| Stuffing box | Packing | |
| Bearing | Sealed ball bearing | |
| Accessories | Strainer, Discharge elbow Hose clamp, Suction hose nipple Standard V - pulley | |

SELECTION OF THE PUMP CALCULATION FOR PADDY FIELD

Water Consumption of paddy field is 60 l/min/Ha

Example : Paddy field : 5 Ha

what is the model of pump

Pump head: 10 m

Result : water consumption (Q) : 5 Ha x 60 l/min/Ha
: 300 l/min = 0.3 m³/min

The pump model is 50 SQPB

SECTIONAL VIEW

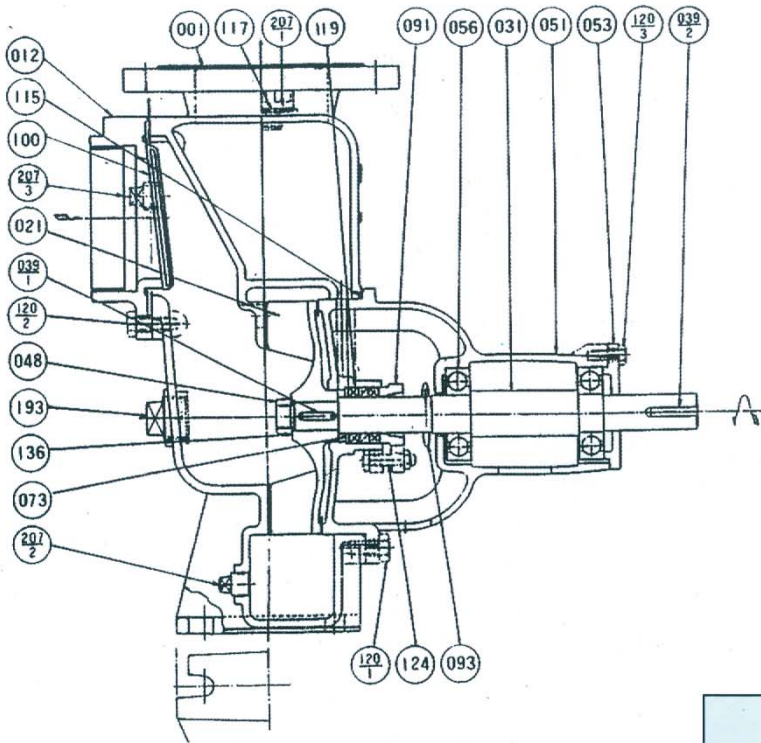

| 207 - 3 | PLUG | CAST IRON | 1 |
|---------|--------------------|--------------|---------------|
| 207 - 2 | DRAIN PLUG | CAST IRON | 1 |
| 207 - 1 | PRIMING PLUG | PLASTIC | 1 |
| 193 | PLUG | CAST IRON | 2 |
| 136 | WASHER | BRASS | 1 |
| 124 | GLAND BOLT AND NUT | STEEL | 1 |
| 120 - 3 | BOLT | STEEL | 2 |
| 120 - 2 | SUCTION COVER BOLT | STEEL | 3 |
| 120 - 1 | CASING BOLT | STEEL | 4 |
| 119 | GLAND PACKING | ASBESTOS | 3 |
| 117 | GASKET | RUBBER | 1 |
| 115 | O-RING | NBR | 1 |
| 100 | CHECK VALVE | RUBBER | 1 |
| 093 | DEFLECTOR | NBR | 1 |
| 091 | GLAND | CAST IRON | 1 |
| 073 | STAGE PIECE | STEEL | 1 |
| 056 | BALL BEARING | - | 2 |
| 053 | BEARING COVER | CAST IRON | 1 |
| 051 | BEARING HOUSING | CAST IRON | 1 |
| 048 | IMPELLER NUT | BRASS | 1 |
| 039 - 2 | KEY | CARBON STEEL | 1 |
| 039 - 1 | KEY | CARBON STEEL | 1 |
| 031 | SHAFT | CARBON STEEL | 1 |
| 021 | IMPELLER | CAST IRON | 1 |
| 012 | SUCTION COVER | CAST IRON | 1 |
| 001 | CASING | CAST IRON | 1 |
| PART NO | PART NAME | MATERIAL | NO.FOR 1 UNIT |



SEMI OPEN IMPELLER

OTHER

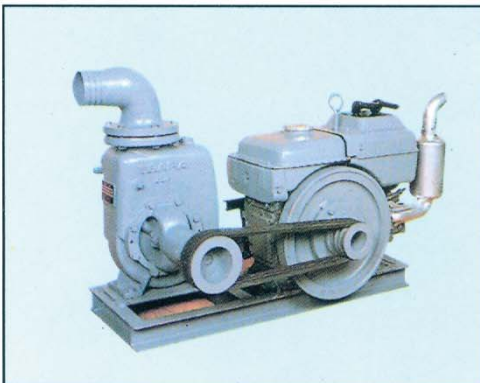

PUMP COUPLED WITH ENGINE

* This picture doesn't show belt cover.
for safety belt cover should be install.

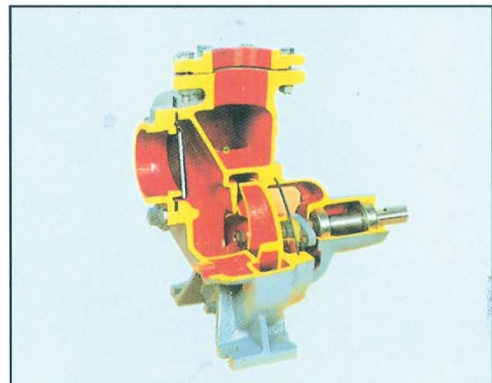

CUT MODEL

BARE SHAFT PUMP DIMENSIONS

50 SQPB

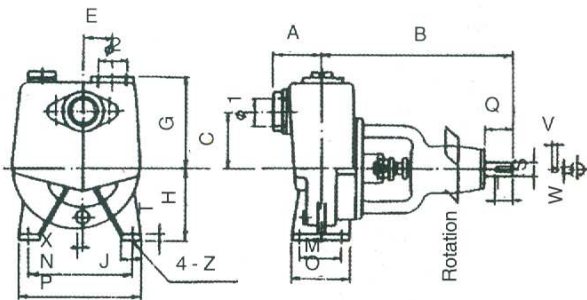

80 SQPB

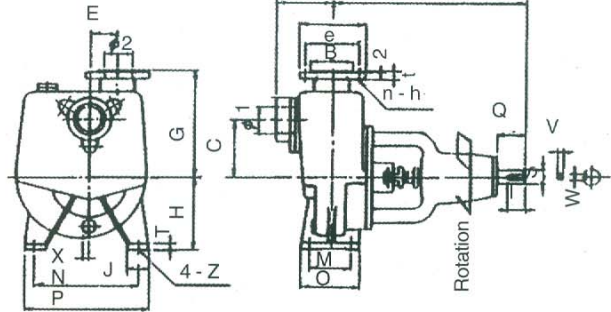

100 SQPB

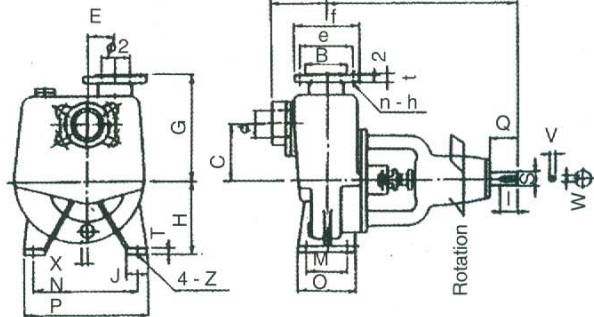

150 SQPB

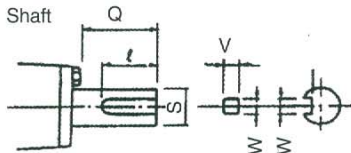
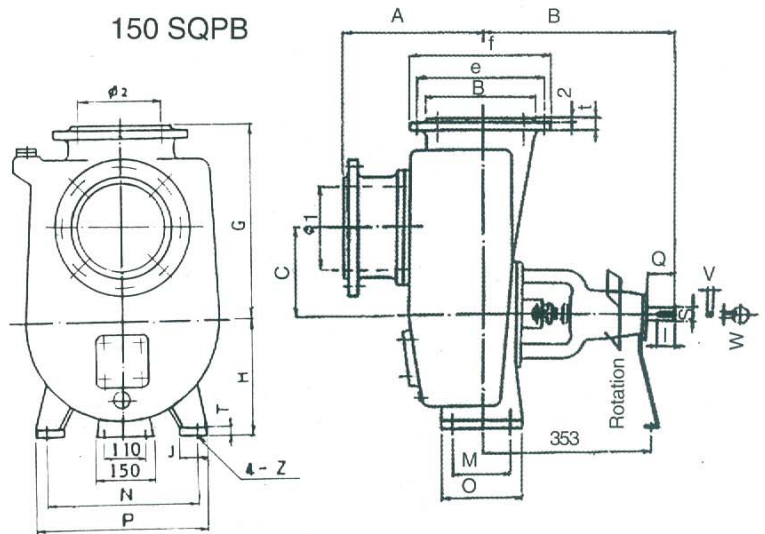

Unit:mm

| MODEL | Ø2 | g | e | f | t | n | h |
|----------|------|-----|-----|-----|----|---|----|
| 50 SQPB | PS-2 | - | - | - | - | - | - |
| 80 SQPB | PS-3 | 130 | 150 | 185 | 18 | 4 | 15 |
| 100 SQPB | PS-4 | 155 | 175 | 210 | 20 | 4 | 15 |
| 150 SQPB | 150 | 215 | 240 | 280 | 22 | 8 | 19 |

Unit:mm

| MODEL | Pump | | | | | | | | | | | | | | Shaft End | | | | | | Weight (Mass) Kg |
|----------|------|-----|-----|-----|----|-----|-----|----|----|-----|-----|-----|-----|----|-----------|----|----|----|---|----|------------------|
| | Ø1 | A | B | C | E | G | H | J | T | M | N | O | P | X | Z | S | Q | I | V | W | |
| 50 SQPB | PS-2 | 100 | 240 | 100 | 40 | 165 | 112 | 35 | 10 | 50 | 150 | 80 | 180 | 0 | 12 | 19 | 34 | 27 | 6 | 6 | 17 |
| 80 SQPB | PS-3 | 120 | 275 | 120 | 25 | 225 | 132 | 40 | 12 | 70 | 190 | 100 | 230 | 10 | 12 | 24 | 50 | 40 | 8 | 7 | 27 |
| 100 SQPB | PS-4 | 130 | 330 | 155 | 25 | 275 | 160 | 50 | 12 | 100 | 230 | 140 | 280 | 20 | 15 | 28 | 55 | 50 | 8 | 7 | 42 |
| 150 SQPB | 150 | 280 | 470 | 180 | - | 400 | 225 | 80 | 16 | 120 | 315 | 160 | 400 | - | 19 | 32 | 80 | 68 | 8 | 10 | 130 |

PERFORMANCE CURVE

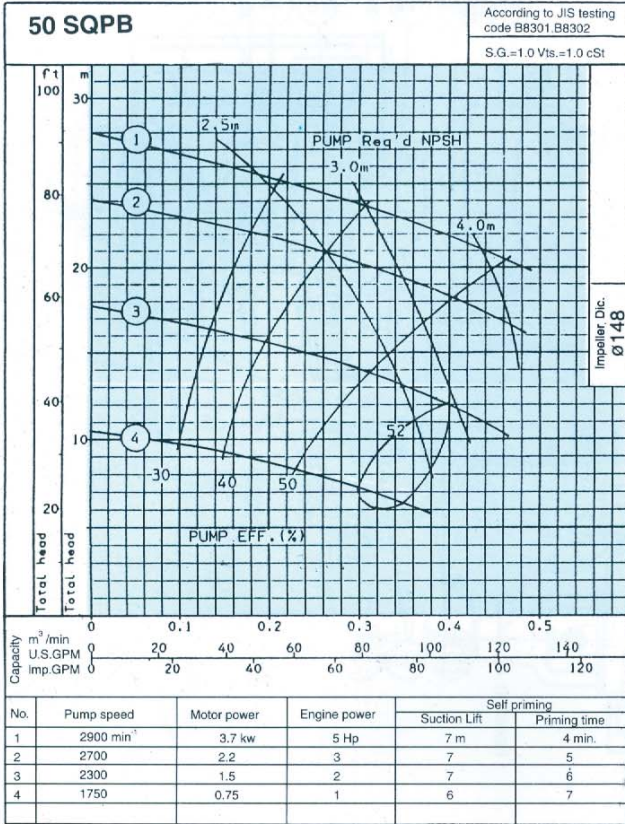

SQPB5401

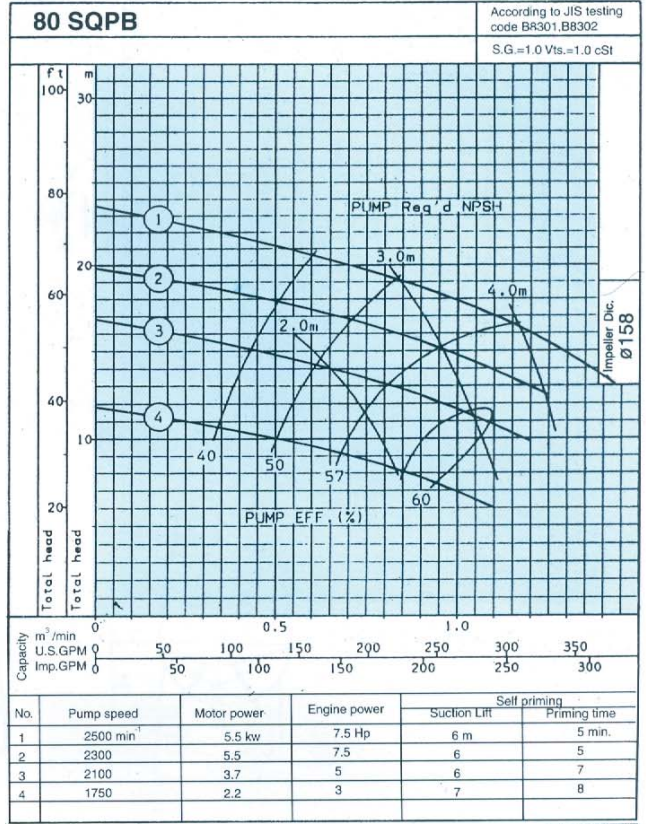

SQPB5402

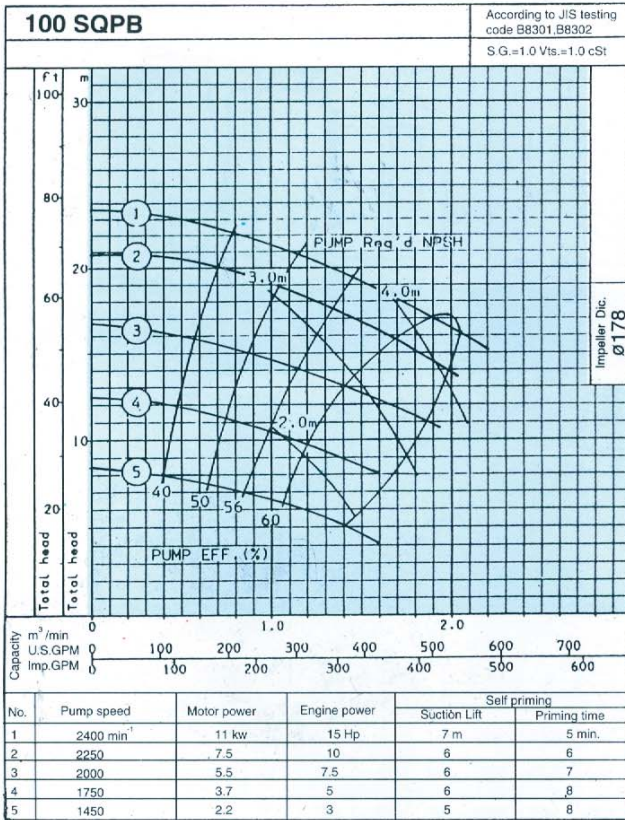

SQPB5403

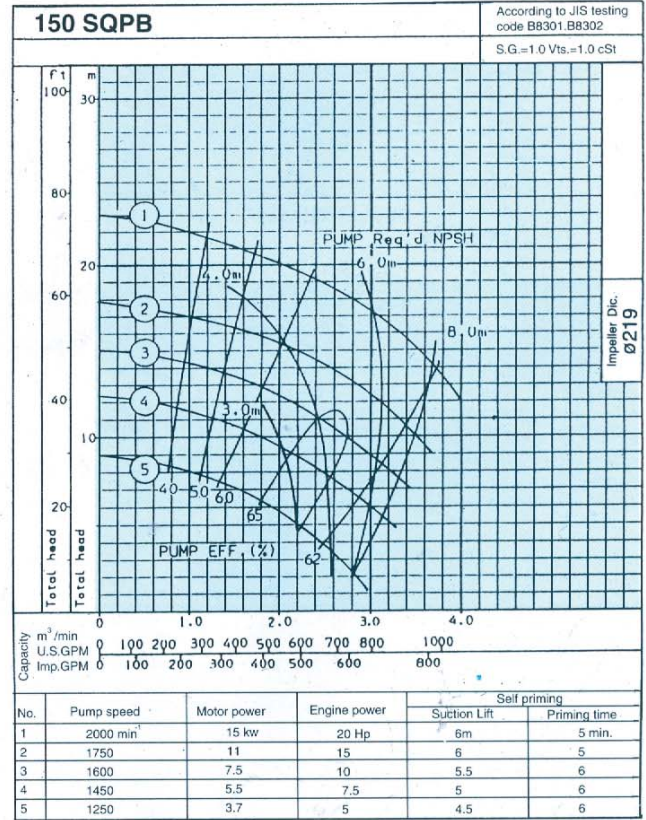

SQPB5404

DISASSEMBLY

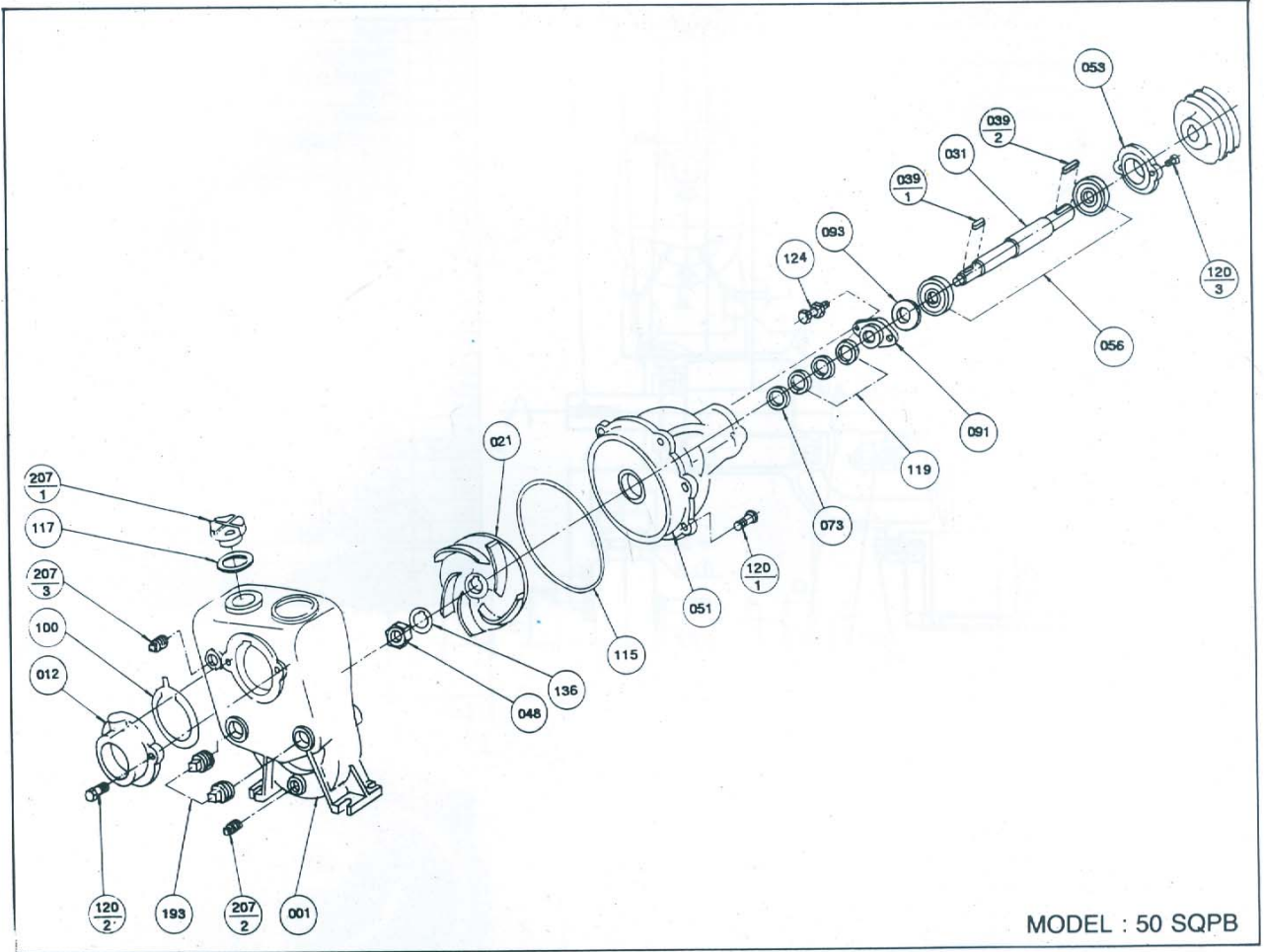

All specifications are subject to change without notice

