



EBARA

CMA-B-D-CMR
SINGLE IMPELLER CENTRIFUGAL ELECTRIC PUMPS

60 Hz



CMA-B-D-CMR

SINGLE IMPELLER CENTRIFUGAL ELECTRIC PUMPS

in cast iron



CMA-B-D



CMR

Cast iron single impeller centrifugal electric pumps.

APPLICATIONS

- Pressure boosting domestic plants
- Small-scale irrigation
- Moving non-aggressive liquids for civil and industrial use
- Washing plants
- Washing vehicles

TECHNICAL DETAILS

- The CMR version is equipped with an open impeller
- They can be inserted into machinery for industrial use

PUMP TECHNICAL DATA

- Maximum working pressure:
 - 6 bar for CMA 056 - 076 - 106, CMB 076 - 106 - 156 - 206 - 306, CMD, CMR
 - 8 bar for the rest of the range
- Maximum temperature of the liquid:
 - 40°C for CMA 056 - 076 - 106
 - 90°C for the rest of the range
- Suction connection: G1 for CMA 056 - 076 - 106, G1¼ for CMA 156 - 206 - 306, G1½ for CMR, G2 for CMB, G2½ for CMD
- Discharge connection: G1 for CMA, G1¼ for CMB, G1½ for CMR, G2½ for CMD

MOTOR TECHNICAL DATA

- CMA-B IE3 high energy-efficiency motors starting from 0.75 kW up to 4 kW (only for 460V) (CMD 406T not available IE3*)
- CMD IE3 high energy-efficiency motors for 0.75 kW 460V
- Self-ventilated 2 pole asynchronous motor
- Class of insulation F
- IP44 Protection rating
- 220-230V ±6%, 60Hz single phase voltage
- 220/380V -6% +10% (from 0.4 kW up to 0.6 kW), 60Hz three phase voltage
- 220/380V ±10% (from 0.75 kW up to 4 kW), 60Hz three phase voltage
- 220/460V ±10% (IE3* 0.75 kW up to 4 kW), 60Hz three phase voltage *for CMR only 0.75 kW version
- Permanent capacitor inserted and thermo-amperometric protection with automatic rearm incorporated for the single phase motor
- Protection under user's responsibility for the three phase version

IDENTIFICATION CODE

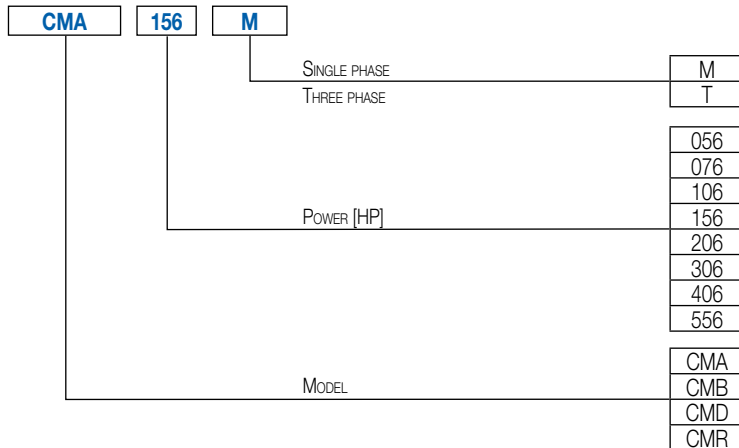

MATERIALS

- Cast iron pump body
- Mechanical seal in Carbon/Ceramic/NBR
- Impeller:
 - in PPE+PS reinforced with fibreglass for CMA 056 - 076 - 106
 - in brass for CMA 156 - 206 - 306, CMB 206 - 306 - 406 - 556, CMR
 - in cast iron for CMB 076 - 106 - 156, CMD
- Shaft:
 - in AISI 303 (part in contact with the liquid) for CMA 076 - 106 - 156 - 206 - 306, CMB 076 - 106 - 156 - 206 - 306, CMD 206 - 306 - CMR
 - in AISI 304 (part in contact with the liquid) for CMB 406 - 556, CMD 406
 - in AISI 416 (integral) for CMA 056
- Bracket:
 - in aluminium for CMA 056 - 076 - 106, CMB 076 - 106, CMR
 - in cast iron for the rest of the range



CMA-B-D-CMR

SINGLE IMPELLER CENTRIFUGAL ELECTRIC PUMPS in cast iron

CMA range PERFORMANCE CURVES (according to ISO 9906 Attachment A)

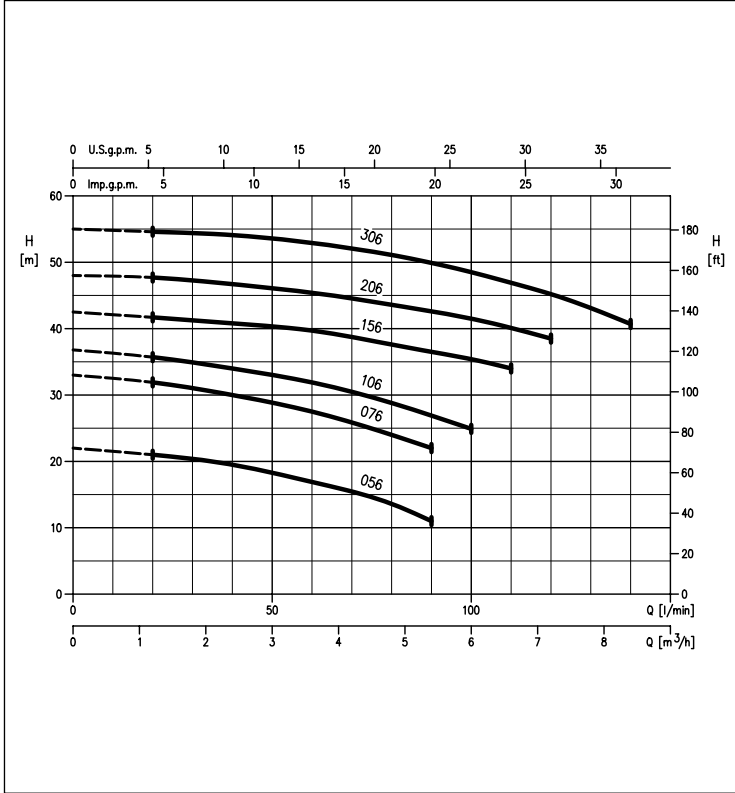

CMB range PERFORMANCE CURVES (according to ISO 9906 Attachment A)

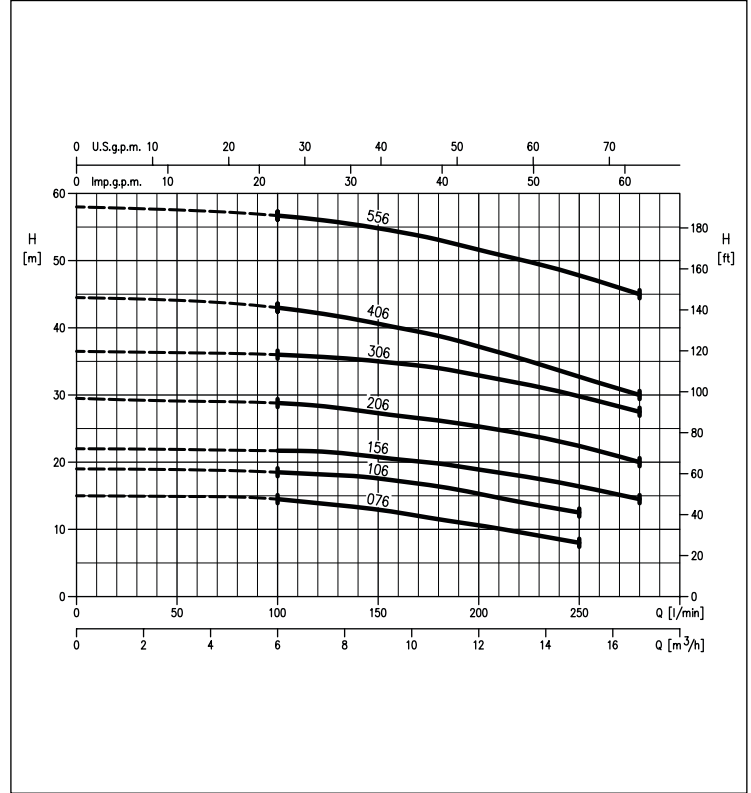

CMD range PERFORMANCE CURVES (according to ISO 9906 Attachment A)

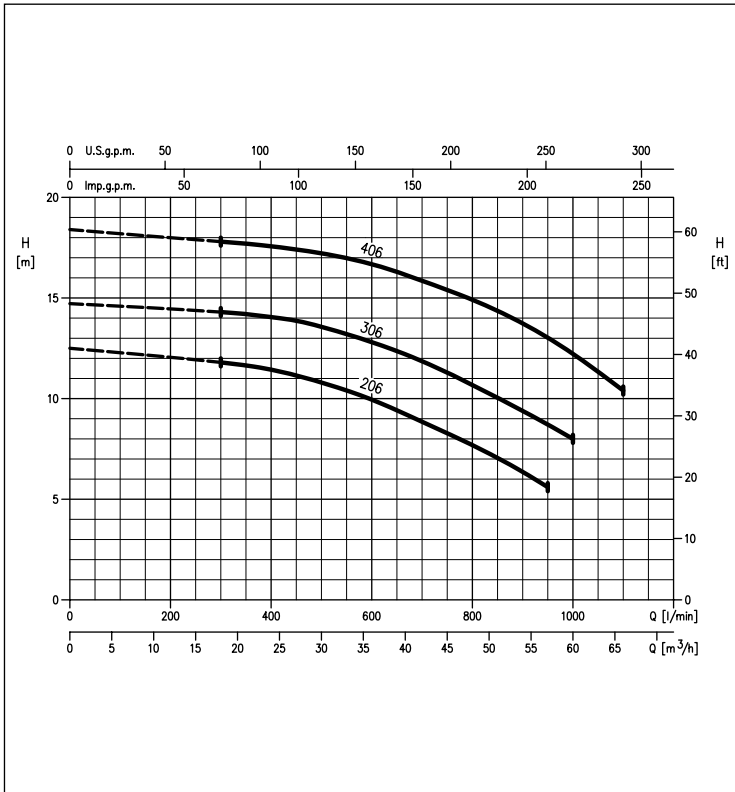

CMR range PERFORMANCE CURVES (according to ISO 9906 Attachment A)

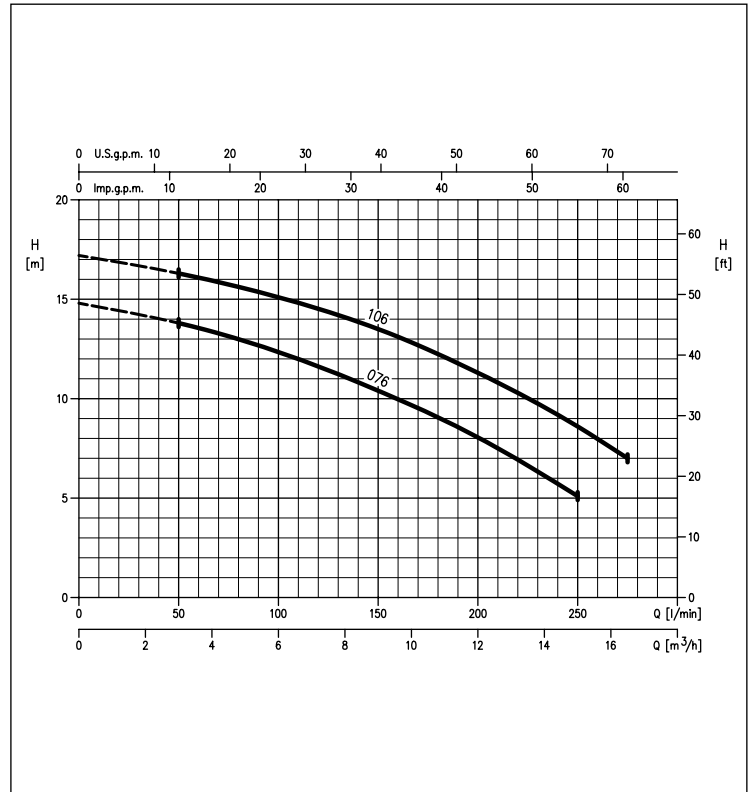

The content of this publication should not be considered mandatory. EBARA Pumps Europe S.p.A. reserves the right to change the content without prior notice.

CMA-B-D-CMR

SINGLE IMPELLER CENTRIFUGAL ELECTRIC PUMPS

in cast iron

CMA PERFORMANCE TABLE

Model		P ₂		Q = Flow Rate													
Single phase 220-230V	Three phase 220/380V	[HP]	[kW]	l/min m ³ /h	20	30	40	50	60	70	80	90	100	110	120	130	140
				H=Head [m]													
CMA 056 M	CMA 056 T	0,5	0,37	21,0	20,5	19,5	18,0	16,9	15,5	13,6	11,0	-	-	-	-	-	-
CMA 076 M	CMA 076 T	0,75	0,55	31,9	31,0	30,0	28,5	27,5	26,0	24,0	22,0	-	-	-	-	-	-
CMA 106 M	CMA 106 T	1	0,75	35,7	35,0	34,0	33,0	32,0	30,5	29,0	27,0	24,9	-	-	-	-	-
CMA 156 M	CMA 156 T	1,5	1,1	41,5	41,0	40,5	40,0	39,5	38,5	37,5	36,5	35,5	34,0	-	-	-	-
CMA 206 M	CMA 206 T	2	1,5	47,5	47,0	46,5	46,0	45,5	44,5	43,5	42,5	41,5	40,0	38,5	-	-	-
-	CMA 306 T	3	2,2	54,5	54,3	54,0	53,5	53,0	52,0	51,0	50,0	48,5	47,0	45,0	43,0	40,5	-

CMB PERFORMANCE TABLE

Model		P ₂		Q = Flow Rate									
Single phase 220-230V	Three phase 220/380V	[HP]	[kW]	l/min m ³ /h	100	120	140	160	180	200	220	250	280
				H=Head [m]									
CMB 076 M	CMB 076 T	0,75	0,55	14,5	13,9	13,3	12,5	11,5	10,6	9,6	8,0	-	-
CMB 106 M	CMB 106 T	1	0,75	18,5	18,2	17,9	17,2	16,4	15,3	14,1	12,5	-	-
CMB 156 M	CMB 156 T	1,5	1,1	21,7	21,6	21,1	20,4	19,8	18,9	18,0	16,4	14,5	-
CMB 206 M	CMB 206 T	2	1,5	28,8	28,4	27,7	26,9	26,2	25,3	24,3	22,4	20,0	-
-	CMB 306 T	3	2,2	36,0	35,7	35,3	34,7	34,0	32,9	31,8	29,8	27,5	-
-	CMB 406 T	4	3	43,0	42,0	41,0	40,0	38,8	37,2	35,5	32,7	30,0	-
-	CMB 556 T	5,5	4	56,5	56,0	55,0	54,0	53,0	51,5	50,0	48,0	45,0	-

CMD PERFORMANCE TABLE

Model		P ₂		Q = Flow Rate												
Single phase 220-230V	Three phase 220/380V	[HP]	[kW]	l/min m ³ /h	300	350	400	450	500	600	700	800	900	950	1000	1100
				H=Head [m]												
CMD 206 M	CMD 206 T	2	1,5	11,8	11,6	11,4	11,1	10,8	9,9	8,8	7,7	6,3	5,6	-	-	-
-	CMD 306 T	3	2,2	14,3	14,2	14,0	13,9	13,6	12,8	11,8	10,7	9,4	8,7	8,0	-	-
-	CMD 406 T	4	3	17,8	17,7	17,6	17,4	17,2	16,7	15,9	14,9	13,7	13,0	12,2	10,4	-

CMR PERFORMANCE TABLE

Model		P ₂		Q = Flow Rate						
Single phase 220-230V	Three phase 220/380V	[HP]	[kW]	l/min m ³ /h	50	100	150	200	250	275
				H=Head [m]						
CMR 076 M	CMR 076	0,75	0,55	13,8	12,3	10,5	8,0	5,1	-	-
CMR 106 M	CMR 106	1	0,75	16,3	15,1	13,5	11,3	8,6	7,0	-

CMA-B-D-CMR

SINGLE IMPELLER CENTRIFUGAL ELECTRIC PUMPS in cast iron

CMA-B-D - CMR DIMENSIONS

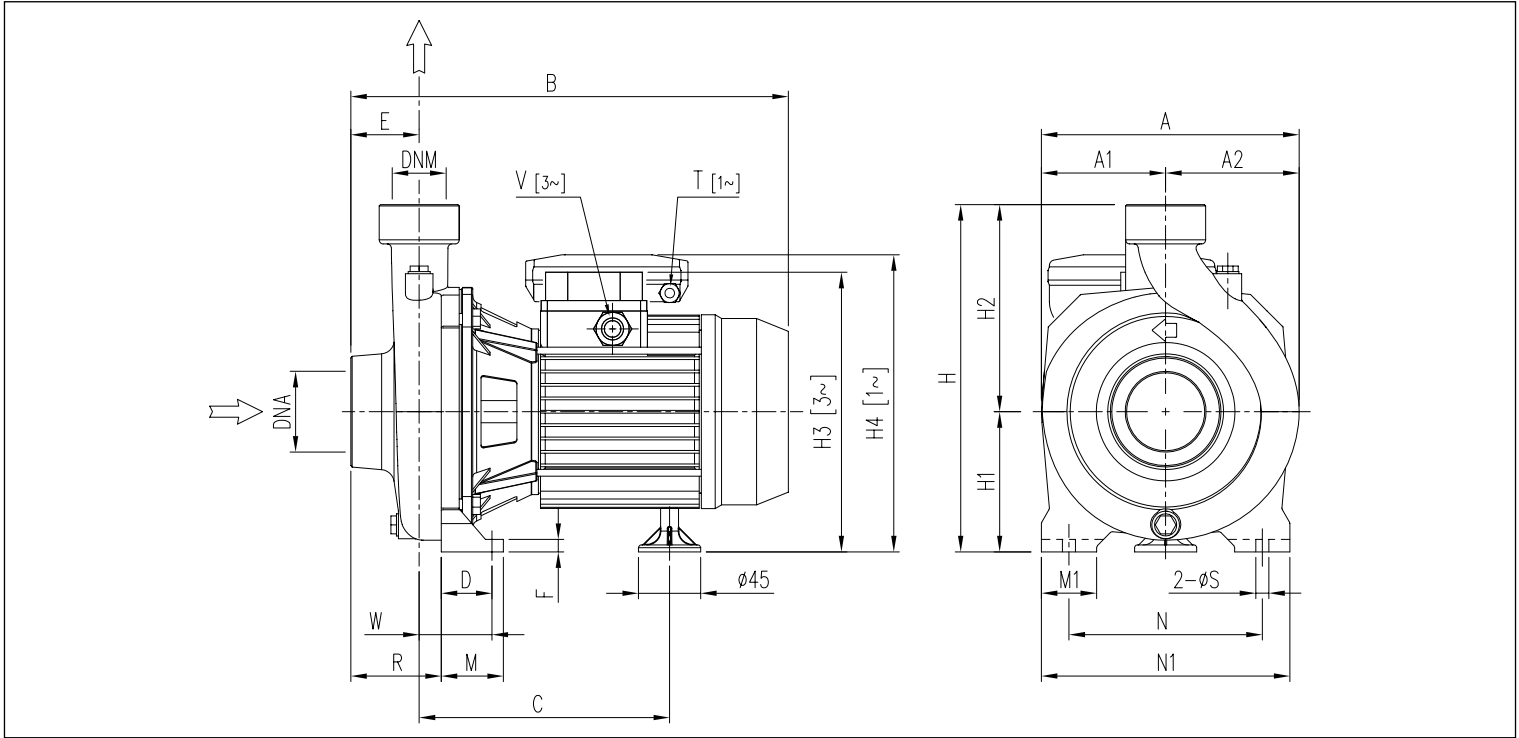

DIMENSIONS TABLE

Model	Dimensions [mm]																							Weight [kg]						
	A	A1	A2	B	C	D	E	F	H	H1	H2	H3	H4	M	M1	N	N1	R	T	V	W	S	DNA		DNM					
CMA 056M	158.5	76.5	82	264	-	156	-	30	44	8	202	82	120	-	-	174.5	40	40	110	150	44	PG11	-	30	9.5	G1	G1	7	-	
CMA 056T	158.5	76.5	82	262	-	159	-	30	44	8	202	82	120	172.5	-	-	40	40	110	150	44	-	PG11	-	30	9.5	G1	G1	7	-
CMA 076M	187	91	96	302	-	171	-	37	45	9	232	97	135	-	-	199	45	40	140	180	45	PG11	-	37	9.5	G1	G1	10	-	
CMA 076T	187	91	96	301	-	172	-	37	45	9	232	97	135	197.5	-	-	45	40	140	180	45	-	PG11	-	37	9.5	G1	G1	10	-
CMA 106M	187	91	96	301	-	172	-	37	45	9	232	97	135	-	-	198	45	40	140	180	45	PG11	-	37	9.5	G1	G1	12	-	
CMA 106T	187	91	96	302	302	171	171	37	45	9	232	97	135	198	198	-	45	40	140	180	45	-	PG11	M16x1.5	37	9.5	G1	G1	12	12.0
CMA 156M	196	97	99	348	-	209	-	42	45.5	9	252	100	152	-	-	232	50	40	155	194	45.5	PG13.5	-	42	9.5	G1½	G1	20	-	
CMA 156T	196	97	99	346	371	207	207	42	45.5	9	252	100	152	219	219	-	50	40	155	194	45.5	-	PG11	M20x1.5	42	9.5	G1½	G1	18	19.0
CMA 206M	223	110.5	112.5	361	-	209	-	42	45.5	9	285	115	170	-	-	247	50	40	180	220	45.5	PG13.5	-	42	9.5	G1½	G1	23	-	
CMA 206T	223	110.5	112.5	346	359	207	207	42	45.5	9	285	115	170	234	234	-	50	40	180	220	45.5	-	PG11	M20x1.5	42	9.5	G1½	G1	22	22.0
CMA 306T	223	110.5	112.5	359	372	207	207	42	45.5	9	285	115	170	234	234	-	50	40	180	220	45.5	-	PG11	M20x1.5	42	9.5	G1½	G1	23	24.0
CMB 076M	188	90	98	316	-	183	-	37	49.5	9	251.5	101.5	150	-	-	127.5	45	40	140	180	65.5	PG11	-	53	9.5	G2	G1½	12	-	
CMB 076T	188	90	98	317	-	182	-	37	49.5	9	251.5	101.5	150	203.5	203.5	-	45	40	140	180	65.5	-	PG11	-	53	9.5	G2	G1½	12	-
CMB 106M	188	90	98	316	-	183	-	37	49.5	9	251.5	101.5	150	-	-	127.5	45	40	140	180	65.5	PG11	-	53	9.5	G2	G1½	14	-	
CMB 106T	188	90	98	317	317	182	182	37	49.5	9	251.5	101.5	150	202.5	202.5	-	45	40	140	180	65.5	-	PG11	M16x1.5	53	9.5	G2	G1½	14	14.0
CMB 156M	188	90	98	350	-	207	-	37	49.5	9	251.5	101.5	150	-	-	233.5	45	40	140	180	65.5	PG13.5	-	53	9.5	G2	G1½	19	-	
CMB 156T	188	90	98	348	373	205	205	37	49.5	9	251.5	101.5	150	220.5	220.5	-	45	40	140	180	65.5	-	PG11	M20x1.5	53	9.5	G2	G1½	18	19.0
CMB 206M	212.5	102	110.5	374	-	210	-	37	57.5	9	271.5	111.5	160	-	-	243.5	45	40	160	200	76.5	PG13.5	-	56	9.5	G2	G1½	21	-	
CMB 206T	212.5	102	110.5	372	385	208	208	37	57.5	9	271.5	111.5	160	230.5	230.5	-	45	40	160	200	76.5	-	PG11	M20x1.5	56	9.5	G2	G1½	20	21.0
CMB 306T	212.5	102	110.5	372	385	208	208	37	57.5	9	271.5	111.5	160	230.5	230.5	-	45	40	160	200	76.5	-	PG11	M20x1.5	56	9.5	G2	G1½	21	22.0
CMB 406T	248.5	121	127.5	427	460	246	286	48	60	12	323.5	133.5	190	274.5	273.5	-	60	50	190	240	77.5	-	PG16	M20x1.5	66	12	G2	G1½	39	39.0
CMB 556T	248.5	121	127.5	467	467	246	246	48	60	12	323.5	133.5	190	274.5	274.5	-	60	50	190	240	77.5	-	PG16	M20x1.5	66	12	G2	G1½	41	41.0
CMD 206M	211	97	114	398	-	223	-	37	68	12	271.5	111.5	160	-	-	243.5	45	40	160	200	100.5	PG13.5	-	70	9.5	G2½	G2½	23	-	
CMD 206T	211	97	114	396	409	221	221	37	68	12	271.5	111.5	160	230.5	230.5	-	45	40	160	200	100.5	-	PG11	M20x1.5	70	9.5	G2½	G2½	21	22.0
CMD 306T	211	97	114	396	409	221	221	37	68	12	271.5	111.5	160	230.5	230.5	-	45	40	160	200	100.5	-	PG11	M20x1.5	70	9.5	G2½	G2½	23	24.0
CMD 406T	211	97	114	444	-	255	-	37	68	12	271.5	111.5	160	252.5	-	-	45	40	160	200	100.5	-	PG16	-	70	9.5	G2½	G2½	30	-
CMR 076M	180	90	90	311	-	182	-	37	45	9	229	97	132	-	-	198	45	40	140	180	60.5	PG11	-	53	9.5	G1½	G1½	10.7	-	
CMR 076T	180	90	90	312	-	181	-	37	45	9	229	97	132	199	-	-	45	40	140	180	60.5	-	PG11	-	53	9.5	G1½	G1½	10.7	-
CMR 106M	180	90	90	311	-	182	-	37	45	9	229	97	132	-	-	198	45	40	140	180	60.5	PG11	-	53	9.5	G1½	G1½	11.9	-	
CMR 106T	180	90	90	312	312	181	-	37	45	9	229	97	132	198	-	-	45	40	140	180	60.5	-	PG11	M16x1.5	53	9.5	G1½	G1½	11.9	11.9

* Models with IE3 motor only

CMA-B-D-CMR

SINGLE IMPELLER CENTRIFUGAL ELECTRIC PUMPS in cast iron

SECTIONAL VIEW for CMA-B-D up to 106

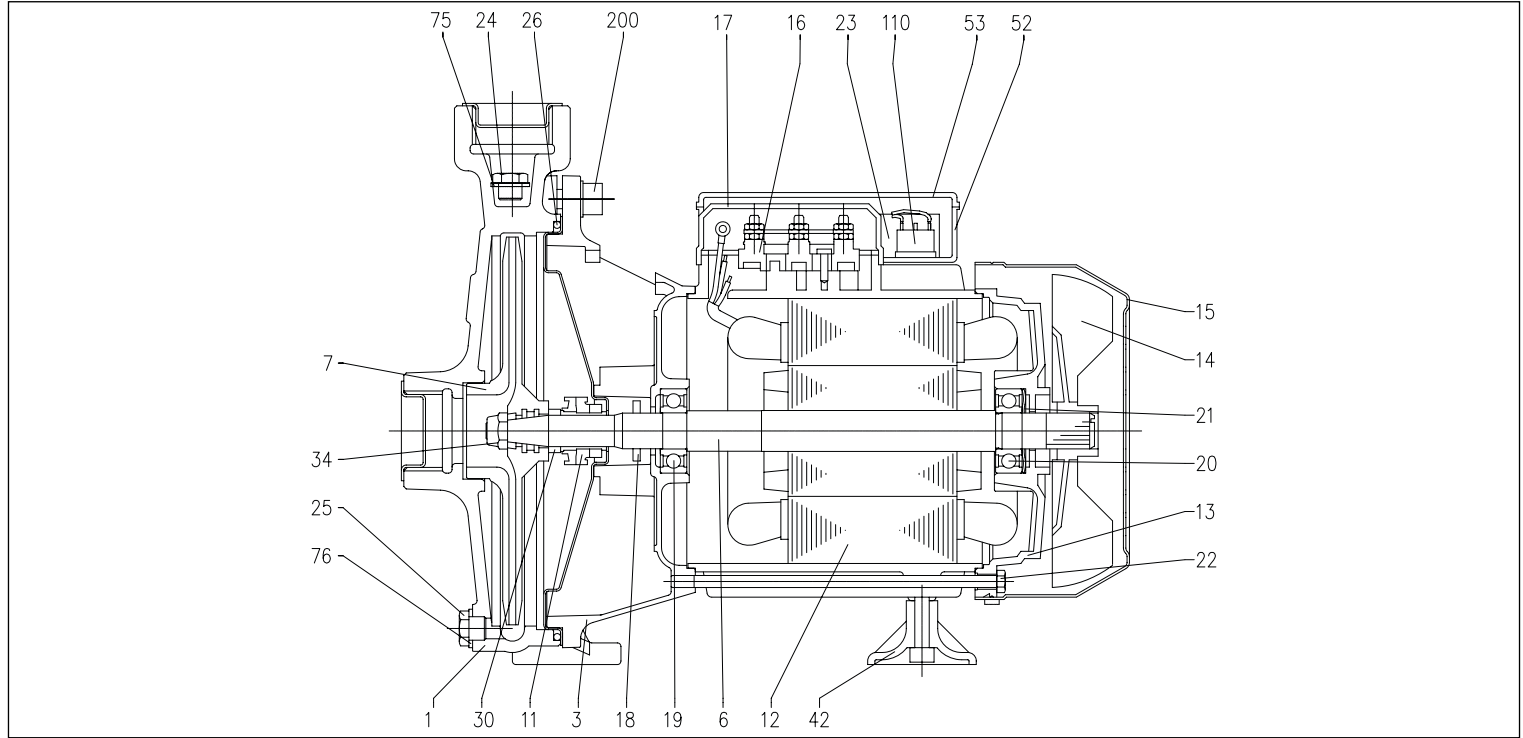

MATERIALS TABLE

Ref.	Name	Material	Ref.	Name	Material
1	Casing	Cast iron	21	Adjusting ring	Steel C70
3	Motor bracket	Aluminium	22	Tie rod	Fe 42 Zincate
4	Casing cover	AISI 304	23	Capacitor [4]	-
6	Shaft with rotor	[1]	24	Priming plug	Brass
7	Impeller	[2]	25	Drain plug	Brass
11	Mechanical seal	Carbon/Ceramic/NBR	26	O-ring	NBR
12	Motor frame with stator	-	30	Mechanical seal spacer [5]	Brass
13	Motor cover	Aluminium	34	Impeller nut [6]	AISI 304
14	Fan	PA6	42	Foot	PP
15	Fan cover	Fe P04 Zincate	52	Capacitor box [4]	ABS class V-0
16	Terminal box	-	53	Capacitor box cover [4] [7]	ABS class V-0 [7]
17	Terminal box cover [3]	Aluminium	75	Washer	Aluminium
18	Splash ring	NBR	76	Washer	Aluminium
19	Pump side ball bearing	-	110	Protector [4]	-
20	Fan side ball bearing	-	200	Screw	Zn Steel Cl. 8.8 ISO 898-1

[1] Material: AISI 416 (integral) for CMA 056, AISI 303 (wet extension) for other model;
 [2] Material: PPE+PS mod. glass fibre reinforced for version CMA, Cast iron for version CMB
 [3] Only for three phase
 [4] Only for single phase

[5] Only for version: CMA 056, CMB 076-106
 [6] Except for CMA 056
 [7] With gasket in NBR only for version single phase CMA 056-076-106, CMB 076-106

SECTIONAL VIEW for CMA-B-D up to 106

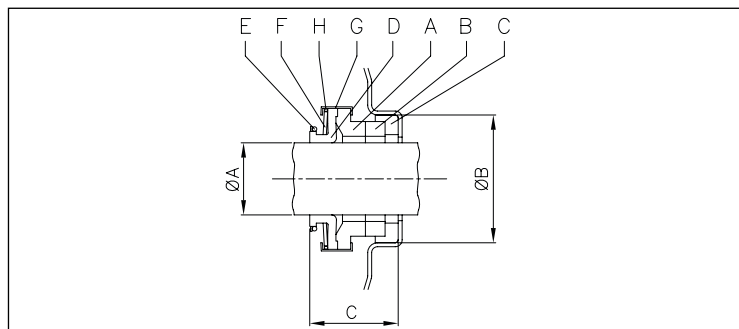

MATERIALS TABLE

Ref.	Name	Material
A	Rotary seal ring	Carbon graphite
B	Stationary seal ring	Ceramic
C	Gasket	NBR
D	Bellows	NBR
E	Ring	AISI 304
F	Self driving spring	AISI 304
G	Frame	AISI 304
H	Retainer ring	AISI 304

CMA-B-D-CMR

SINGLE IMPELLER CENTRIFUGAL ELECTRIC PUMPS in cast iron

SECTIONAL VIEW for CMA-B-D from 156 and above

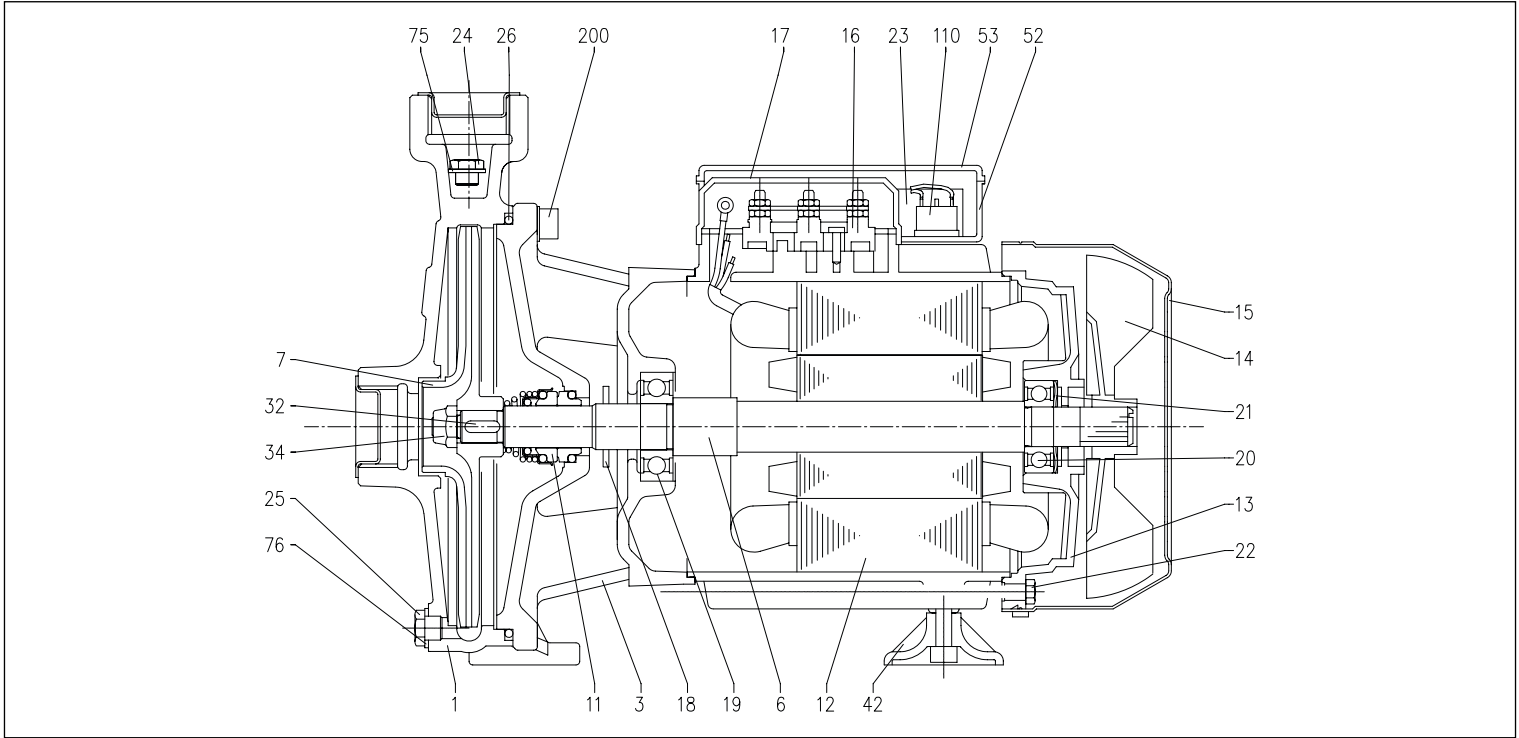

MATERIALS TABLE

Ref.	Name	Material	Ref.	Name	Material
1	Casing	Cast iron	22	Tie rod	Fe 42 Zincate
3	Motor bracket	Cast iron	23	Capacitor [4]	-
6	Shaft with rotor	[1]	24	Priming plug	Brass
7	Impeller	[2]	25	Drain plug	Brass
11	Mechanical seal	Carbon/Ceramic/NBR	26	O-ring	NBR
12	Motor frame with stator	-	32	Key	AISI 316
13	Motor cover	Aluminium	34	Impeller nut	AISI 304
14	Fan	PA6	42	Foot	PP
15	Fan cover	Fe P04 Zincate	52	Capacitor box [4]	ABS class V-0
16	Terminal board	-	53	Capacitor box cover [4]	ABS class V-0
17	Terminal box cover [3]	Aluminium	75	Washer	Aluminium
18	Splash ring	NBR	76	Washer	Aluminium
19	Pump side ball bearing	-	101	Seeger ring	AISI 420
20	Fan side ball bearing	-	110	Protector [4]	-
21	Adjusting ring	Steel C70	200	Screw	Zn Steel Cl. 8.8 ISO 898-1

[1] Material: AISI 303 (wet extension) for version CMA, CMB 156-206-306, CMD 206-306
AISI 304 (wet extension) for version CMB 406-556, CMD 406

[2] Material: Brass for version: CMA, CMB 206-306-406-556, Cast iron for version: CMB 156, CMD

[3] Only for three phase

[4] Only for single phase

SECTIONAL VIEW for CMA-B-D from 156 and above

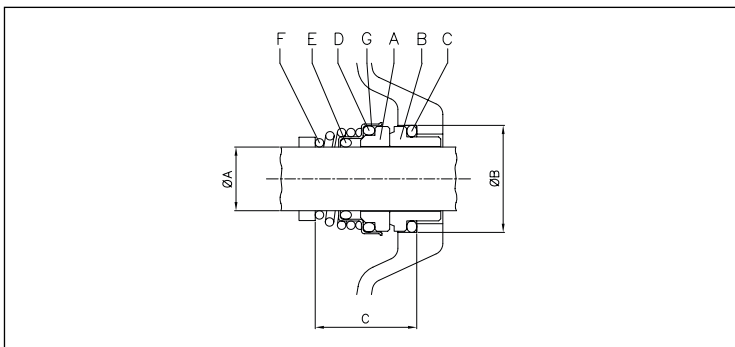

MATERIALS TABLE

Ref.	Name	Material
A	Rotary seal ring	ceramic
B	Stationary seal ring	carbon graphite
C	O Ring	NBR
D	O Ring	NBR
E	O Ring	NBR
F	Self driving spring	AISI 316
G	Frame	AISI 304
H	Retainer ring	AISI 304

CMA-B-D-CMR

SINGLE IMPELLER CENTRIFUGAL ELECTRIC PUMPS

in cast iron

SECTIONAL VIEW for CMR

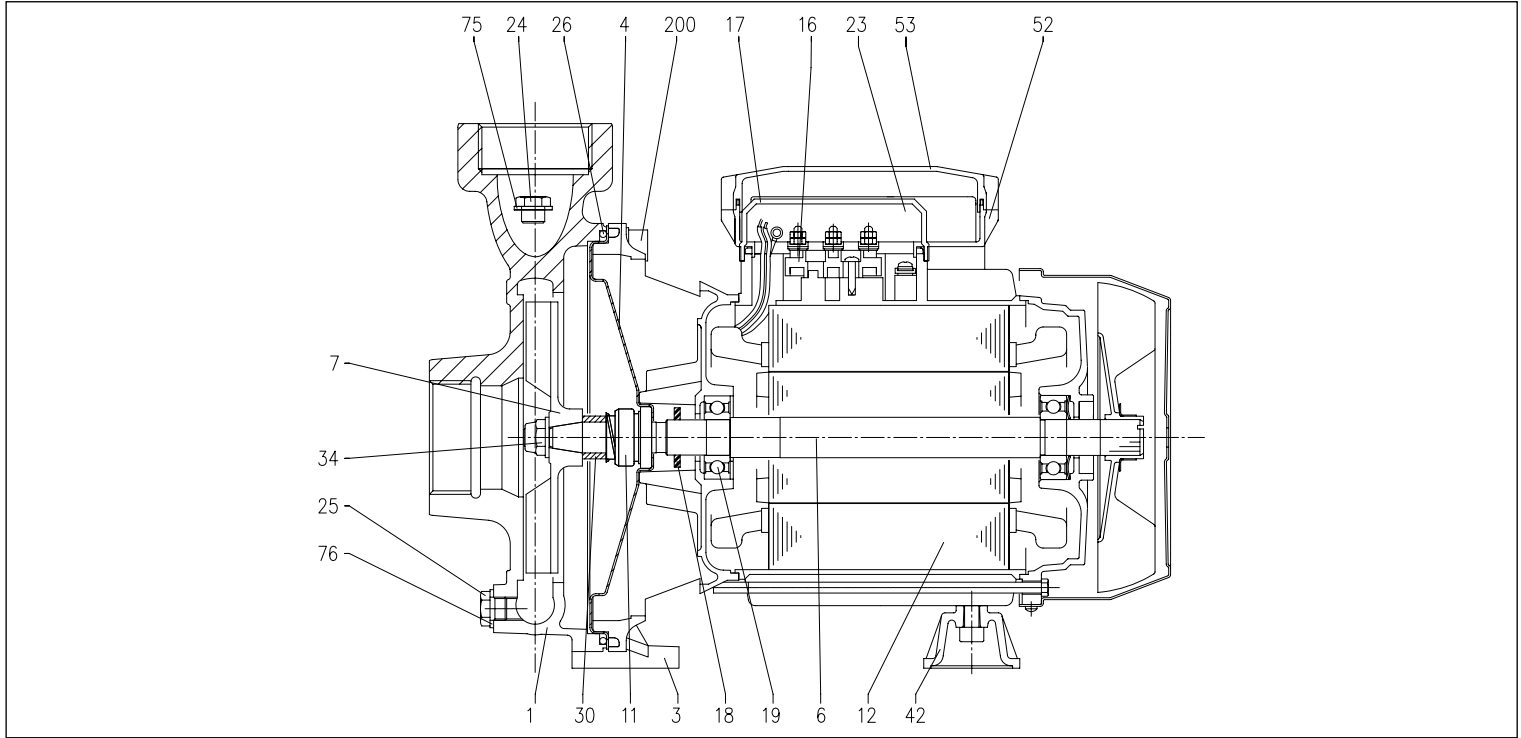

MATERIALS TABLE

Ref.	Name	Material	Ref.	Name	Material
1	Casing	Cast iron	21	Adjusting ring	Steel C70
3	Motor bracket	Aluminium	22	Tie rod	Fe 42 Zincate
4	Casing cover	AISI 304	23	Capacitor [2]	-
6	Shaft with rotor	AISI 303 (wet extension)	24	Priming plug	Brass
7	Impeller	Brass	25	Drain plug	Brass
11	Mechanical seal	Carbon/Ceramic/NBR	26	O-ring	NBR
12	Motor frame with stator	-	30	Mechanical seal spacer	Brass
13	Motor cover [1]	Aluminium	34	Impeller nut	AISI 304
14	Fan	PP	42	Foot	PP
15	Fan cover	Fe P04 Zincate	52	Capacitor box [2]	ABS class V-0
16	Terminal box	-	53	Capacitor box cover with gasket [2]	ABS class V-0 + NBR
17	Terminal box cover [1]	Aluminium	75	Washer	Aluminium
18	Splash ring	NBR	76	Washer	Aluminium
19	Pump side ball bearing	-	200	Screw	Zn Steel Cl. 8.8 ISO 898-1
20	Fan side ball bearing	-			

[1] = Three phase

[2] = Single phase

SECTIONAL VIEW for CMR

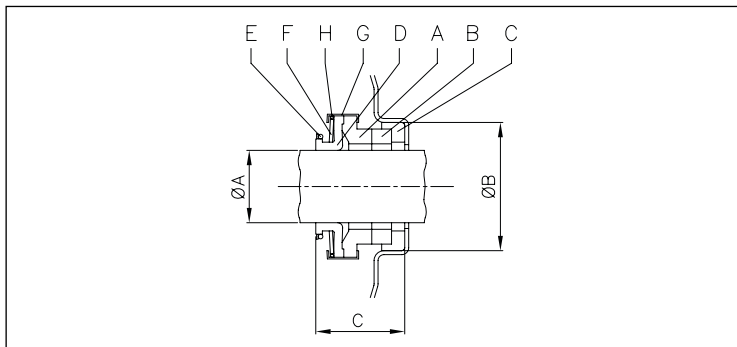

MATERIALS TABLE

Ref.	Name	Material
A	Rotary seal ring	carbon graphite
B	Stationary seal ring	ceramic
C	Gasket	NBR
D	Bellows	NBR
E	Ring	AISI 304
F	Self driving spring	AISI 304
G	Frame	AISI 304
H	Retainer ring	AISI 304

CMA-B-D-CMR

SINGLE IMPELLER CENTRIFUGAL ELECTRIC PUMPS

in cast iron

ELECTRIC DATA TABLE

Model Single phase 230V	Model Three phase 230/400V	P ₂		Efficiency		Capacitor		Efficiency (%)			Efficiency (%)			P ₁		Full load current [A]			
		[HP]	[kW]	Single phase	Three phase	Single phase μF	V.	Three phase 380V			Three phase 460V			Single phase [kW]	Three phase [kW]	Single Phase 220-230 V	Three Phase		
								50%	75%	100%	50%	75%	100%				220 V	380 V	460 V
CMA 056M	CMA 056T	0.37	0.5	-	-	10	450	-	-	-	-	-	-	0.7	-	3.5	-	-	-
CMA 076M	CMA 076T	0.55	0.75	-	-	16	450	-	-	-	-	-	-	1.2	-	5.6	-	-	-
CMA 106M	CMA 106T	0.75	1.0	-	-	20	450	77.2	79.5	79.3	76.6	80.9	82.3	1.3	1.0	6.3	2.9	1.7	-
-	CMA 106T	0.75	1.0	-	IE3*	-	-	80.7	81.9	81.3	78.4	81.6	83.1	-	0.9	-	2.8	1.6	1.5
CMA 156M	CMA 156T	1.1	1.5	-	-	35	450	78.3	80.4	81.0	76.5	81.3	83.4	1.9	2.00	9.2	5.7	3.3	-
-	CMA 156T	1.1	1.5	-	IE3*	-	-	85.4	86.5	85.7	83.0	85.8	86.6	-	1.75	-	5.3	3.1	2.9
CMA 206M	CMA 206T	1.5	2.0	-	-	35	450	82.4	83.0	82.2	79.5	82.9	83.8	2.33	2.90	10.9	8.1	4.7	-
-	CMA 206T	1.5	2.0	-	IE3*	-	-	88.9	88.8	87.2	86.3	88.5	88.4	-	2.48	-	7.5	4.3	4.1
-	CMA 306T	2.2	3.0	-	-	-	-	82.4	83.0	82.2	79.5	82.9	83.8	-	2.90	-	8.1	4.7	-
-	CMA 306T	2.2	3.0	-	IE3*	-	-	88.9	88.8	87.2	86.3	88.5	88.4	-	2.48	-	7.5	4.3	4.1
CMB 076M	CMB 076T	0.55	0.75	-	-	14	450	-	-	-	-	-	-	0.93	0.84	4.5	2.6	1.5	-
CMB 106M	CMB 106T	0.75	1.0	-	-	20	450	77.2	79.5	79.3	76.6	80.9	82.3	1.3	1.0	6.4	2.9	1.7	-
-	CMB 106T	0.75	1.0	-	IE3*	-	-	80.7	81.9	81.3	78.4	81.6	83.1	-	0.9	-	2.8	1.6	1.5
CMB 156M	CMB 156T	1.1	1.5	-	-	35	450	78.3	80.4	81.0	76.5	81.3	83.4	1.6	2.00	7.8	5.7	3.3	-
-	CMB 156T	1.1	1.5	-	IE3*	-	-	85.4	86.5	85.7	83.0	85.8	86.6	-	1.75	-	5.3	3.1	2.9
CMB 206M	CMB 206T	1.5	2.0	-	-	35	450	82.4	83.0	82.2	79.5	82.9	83.8	2.0	2.90	9.8	8.1	4.7	-
-	CMB 206T	1.5	2.0	-	IE3*	-	-	88.9	88.8	87.2	86.3	88.5	88.4	-	2.48	-	7.5	4.3	4.1
-	CMB 306T	2.2	3.0	-	-	-	-	82.4	83.0	82.2	79.5	82.9	83.8	-	2.90	-	8.1	4.7	-
-	CMB 306T	2.2	3.0	-	IE3*	-	-	88.9	88.8	87.2	86.3	88.5	88.4	-	2.48	-	7.5	4.3	4.1
-	CMB 406T	3	4.0	-	-	-	-	83.1	85.2	85.9	79.9	84.0	85.7	-	3.80	-	11.1	6.4	-
-	CMB 406T	3	4.0	-	IE3*	-	-	-	-	87.5	-	-	88.5	-	3.42	-	10.2	5.9	5.6
-	CMB 556T	4	5.5	-	-	-	-	83.2	85.8	86.1	81.0	85.1	86.7	-	5.10	-	14.7	8.5	-
-	CMB 556T	4	5.5	-	IE3*	-	-	89.7	89.6	88.6	86.1	88.4	88.5	-	4.52	-	13.5	7.8	7.6
CMD 206M	CMD 206T	1.5	2.0	-	-	31.5	450	82.4	83.0	82.2	79.5	82.9	83.8	2.3	2.90	10.5	8.1	4.7	-
-	CMD 206T	1.5	2.0	-	IE3*	-	-	88.9	88.8	87.2	86.3	88.5	88.4	-	2.48	-	7.5	4.3	4.1
-	CMD 306T	2.2	3.0	-	-	-	-	82.4	83.0	82.2	79.5	82.9	83.8	-	2.90	-	8.1	4.7	-
-	CMD 306T	2.2	3.0	-	IE3*	-	-	88.9	88.8	87.2	86.3	88.5	88.4	-	2.48	-	7.5	4.3	4.1
-	CMD 406T	3	4.0	-	-	-	-	83.1	85.2	85.9	79.9	84.0	85.7	-	3.80	-	11.1	6.4	-
CMR 076 M	CMR 076 T	0.55	0.75	-	-	12.5	450	-	-	-	-	-	-	0.84	0.73	3.9	2.3	1.3	-
CMR 106 M	CMR 106 T	0.75	1	-	-	20	450	77.2	79.5	79.3	76.6	80.9	82.3	1.07	1.00	5.0	2.9	1.7	-
-	CMR 106 T	0.75	1	-	IE3*	-	-	80.7	81.9	81.3	78.4	81.6	83.1	-	0.90	-	2.8	1.6	1.5

* Only for 460V

The content of this publication should not be considered mandatory. EBARA Pumps Europe S.p.A. reserves the right to change the content without prior notice.

EBARA Pumps Europe network

HEAD OFFICE

EBARA Pumps Europe S.p.A.
Via Pacinotti, 32
36040 Brendola (VI), Italy
Phone +39 0444 706811 - Fax +39 0444 405811

Italian Sales (for order only):
e-mail: ordini@ebaraeurope.com

Export Sales (for order only):
e-mail: exportsales@ebaraeurope.com

Technical Customer Service (TCS):
e-mail: tcs@ebaraeurope.com
Phone +39 0444 706869/902/923/833

Marketing & Marketing Communication:
e-mail: marketing@ebaraeurope.com

ITALIAN SALES NETWORK

NORTH-EAST Region:
(Trentino Alto Adige, Veneto, Friuli Venezia Giulia, Emilia Romagna)
Regional Manager mobile: +39 335 6423308
e-mail: nord@ebaraeurope.com
Phone +39 0444 706811 - Fax +39 0444 405811

NORTH-WEST Region:
(Valle d'Aosta, Piemonte, Lombardia, Liguria)
Regional Manager mobile: +39 335 5327276
e-mail: mktgmi@ebaraeurope.com
Phone +39 0444 706811 - Fax +39 0444 405975

CENTRAL Region:
(Toscana, Umbria, Marche, Lazio, Abruzzo, Molise)
Regional Manager mobile: +39 335 6423286
e-mail: centro@ebaraeurope.com
Phone +39 0444 706811 - Fax +39 0444 405811

SOUTH Region:
(Campania, Basilicata, Puglia, Calabria, Sicilia)
Regional Manager mobile: +39 335 6423316
e-mail: sud@ebaraeurope.com
Phone +39 0444 706811 - Fax +39 0444 405811

INDUSTRIAL Division:
Manager mobile: +39 335 6423302
e-mail: industry@ebaraeurope.com
Phone +39 0444 706811 - Fax +39 0444 405811

WASTEWATER Division:
Manager mobile: +39 335 6423290
e-mail: ses@ebaraeurope.com
Phone +39 0444 706811 - Fax +39 0444 405811

CAGLIARI Branch:
Via del Fangario, 29
09122 Cagliari
Phone +39 070 274281 - Fax +39 0444 405960
Branch Manager mobile: +39 335 6423320
e-mail: mktgca@ebaraeurope.com

PALERMO Branch:
Via Don L. Sturzo, 181/183
Z.I. - 90044 Carini (PA)
Phone +39 091 8669790 - Fax +39 0444 405980
Branch Manager mobile: +39 335 6423316
e-mail: mktgpa@ebaraeurope.com

EXPORT NETWORK

EBARA Pumps Europe S.p.A. UNITED KINGDOM
Unit 7 - Zodiac Business Park
High Road - Cowley Uxbridge
Middlesex - UB8 2GU, United Kingdom
Phone +44 1895 439027 - Fax +44 1895 439028
e-mail: mktguk@ebaraeurope.com

EBARA ESPAÑA BOMBAS S.A.
C/Cormoranes 6 Y 8
Poligono Ind. La Estación
28320 Pinto (Madrid), Spain
Phone +34 916.923.630 - Fax +34 916.910.818
e-mail: marketing@ebara.es

EBARA Pumps Europe S.p.A. FRANCE
555, Rue Juliette Recamier
69970 Chaponnay, France
Phone +33 4 72769482 - Fax +33 805101071
e-mail: mktgfr@ebaraeurope.com

EBARA Pumps Europe S.p.A. GERMANY
Ferdinand-Porsche-Ring 7
63110 Rodgau-Jügesheim, Germany
Phone +49 (0) 6106-660 99-0
Fax +49 (0) 6106-660 99-45
e-mail: mktgde@ebaraeurope.com

EBARA POMPY POLSKA Sp. z o.o.
ul. Działkowa 115
02-234 Warszawa, Poland
Phone +48 22 3909920 - Fax +48 22 3909929
e-mail: mktgpl@ebaraeurope.com

EBARA Pumps Europe S.p.A INDIA LIAISON OFFICE
1503, Bhumiraj Costarica,
Sector-18, Palm Beach Rd.
Sanpada, Navi Mumbai
Maharashtra, Pin: 400705 - India
Phone +91 22 2781 2862
Fax +91 22 2781 2865
e-mail: mktgind@ebaraeurope.com

EBARA Pumps RUS Ltd.
Prospekt Andropov 18, building 7, floor 11
115432 Moscow
Japan
Tel. +7 499 6830133
e-mail: mktgrus@ebaraeurope.com



The contents of this publication should not be considered binding. EBARA Pumps Europe S.p.A. reserves the right to make changes considered appropriate without prior notice.

S.C. 03/16



EBARA Pumps Europe S.p.A.

Via Pacinotti, 32
36040 Brendola (Vicenza), Italy
Phone +39 0444 706811 - Fax +39 0444 405811
e-mail: ebara_pumps@ebaraeurope.com
www.ebaraeurope.com



EBARA Corporation

11-1, Haneda Asahi-cho, Ohta-ku,
Tokyo 144-8510
Japan
Phone +81 3 6275 7598 - Fax +81 3 5736 3193
www.ebara.com

