



EBARA

3D SERIES

CENTRIFUGAL PUMPS CLOSE COUPLED
AND STANDARDIZED EN733

60 Hz



3D SERIES

CENTRIFUGAL PUMPS CLOSE COUPLED AND STANDARDIZED EN 733



Centrifugal pumps close coupled (3D) and standardized EN 733 (3DS-3DP) in cast iron.

APPLICATIONS

- Water and clean liquids not chemically aggressive handling
- Water supply
- Pressure boosting
- Washing and industrial plants
- Water circulation in air-conditioning systems
- Irrigation and agriculture

TECHNICAL DETAILS

- Highly resistant construction
- Impeller in stainless steel
- High efficiency

PUMP TECHNICAL DATA

- Maximum working pressure: 10 bar
- Temperature of the liquid:
 - 5°C ÷ +90°C
 - 5°C ÷ +110°C (H-HS-HW-HSW versions)
 - 5°C ÷ +120°C (E version)

MOTOR TECHNICAL DATA

- Self-ventilated asynchronous motor
- Insulation class: 3D = F
 - 3DS - 3DP = F (B for high temperatures)
- Protection degree IP 55
- 220/380-460V ±10% for 3D (up to 4.0kW included), 380-460/660V ±10% for 3D (from 5,5 kW and above), 265/460V ±10% for 3DS - 3DP (up to 4.0kW included), 460V ±10% for 3DS - 3DP (from 5,5 kW and above),
- Protection is user's responsibility

MATERIALS

- Pump casing in cast iron EN-GJL-250-EN 1561
- Impeller in:
 - AISI 304 for 3D(.) SERIES 32, 40, 50
 - AISI 316 microcasted for 3D(.) SERIES 65
- Shaft in AISI 304 (part in contact with the liquid)
- Mechanical seal in:
 - Ceramic/Carbon/NBR (standard)
 - Ceramic/Carbon/FPM (H version)
 - SiC/SiC/FPM (HS version)
 - Tungsten Carbide/Tungsten Carbide/FPM (HW version)
 - SiC/Tungsten Carbide/FPM (HSW version)
 - Ceramic/Carbon/EPDM (E version)

SPECIAL VERSIONS

- Special voltages
- Special mechanical seals

Available in 3 different versions with 2 and poles motors

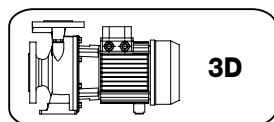

3D

Monobloc with extended motor shaft

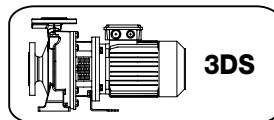

3DS

Monobloc with standard motor and rigid joint

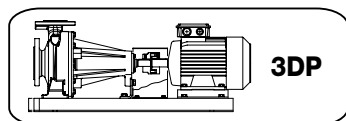

3DP

On base, with standard motor and flexible coupling



3D SERIES

CENTRIFUGAL PUMPS CLOSE COUPLED AND STANDARDIZED EN 733

IDENTIFICATION CODE

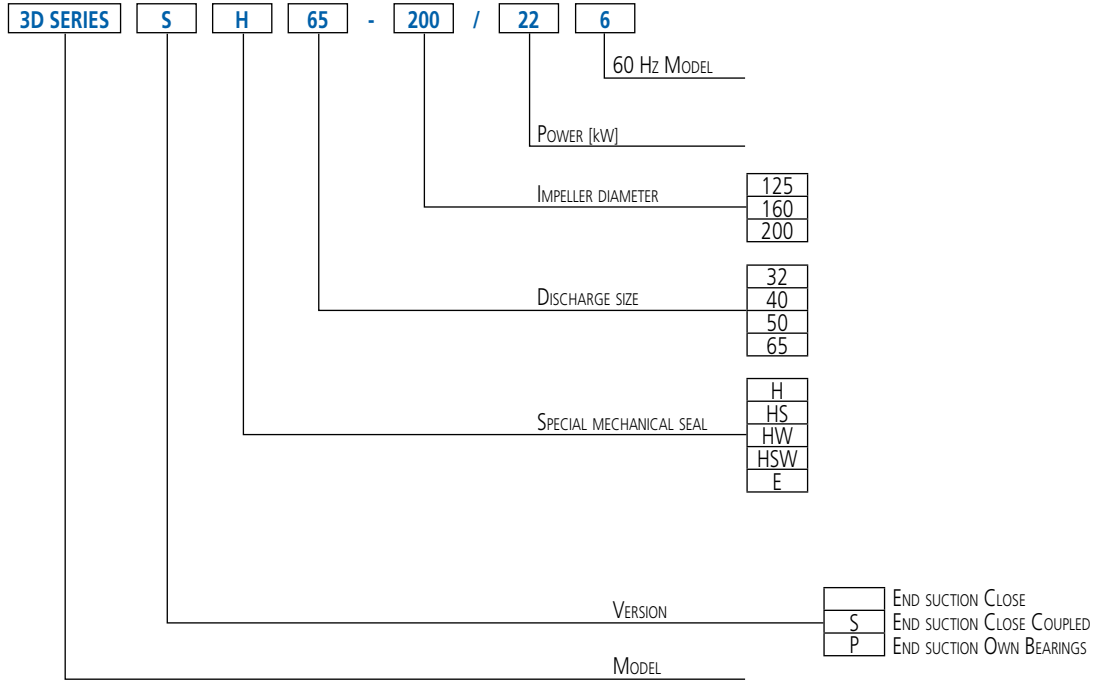

The contents of this publication must not be regarded as binding. EBARA Pumps Europe S.p.A. reserves the right to effect any modification it deems necessary, without prior notice.



3D SERIES

CENTRIFUGAL PUMPS CLOSE COUPLED AND STANDARDIZED EN 733

PERFORMANCE CHART at 2900 min⁻¹ (according to ISO 9906 Attachment A)

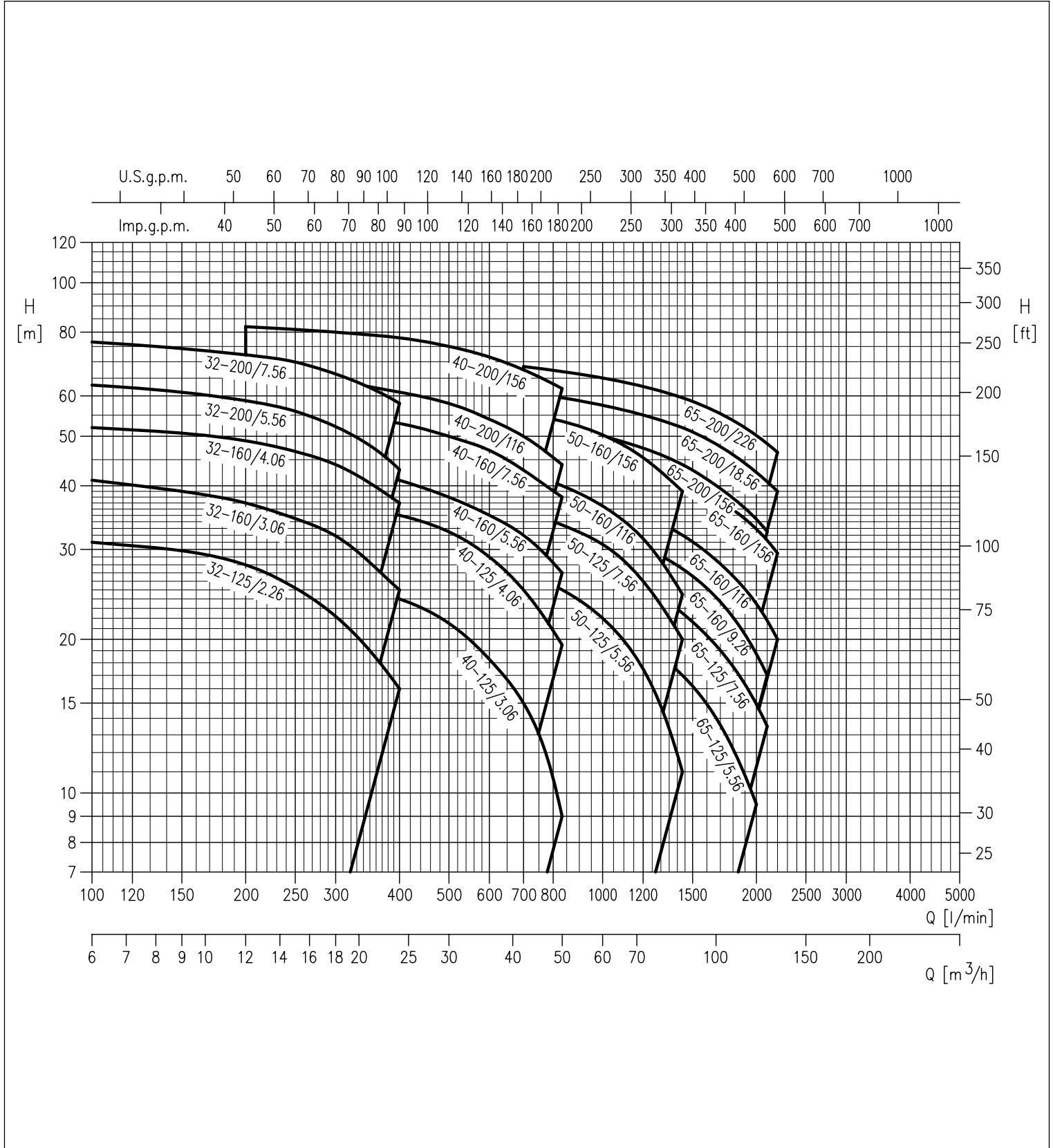

The contents of this publication must not be regarded as binding. EBARA Pumps Europe S.p.A. reserves the right to effect any modification it deems necessary without prior notice.



3D SERIES

CENTRIFUGAL PUMPS CLOSE COUPLED AND STANDARDIZED EN 733

PERFORMANCE CURVES 3D(.) SERIES 32-125 at 2900 min⁻¹ (according to ISO 9906 Attachment A)

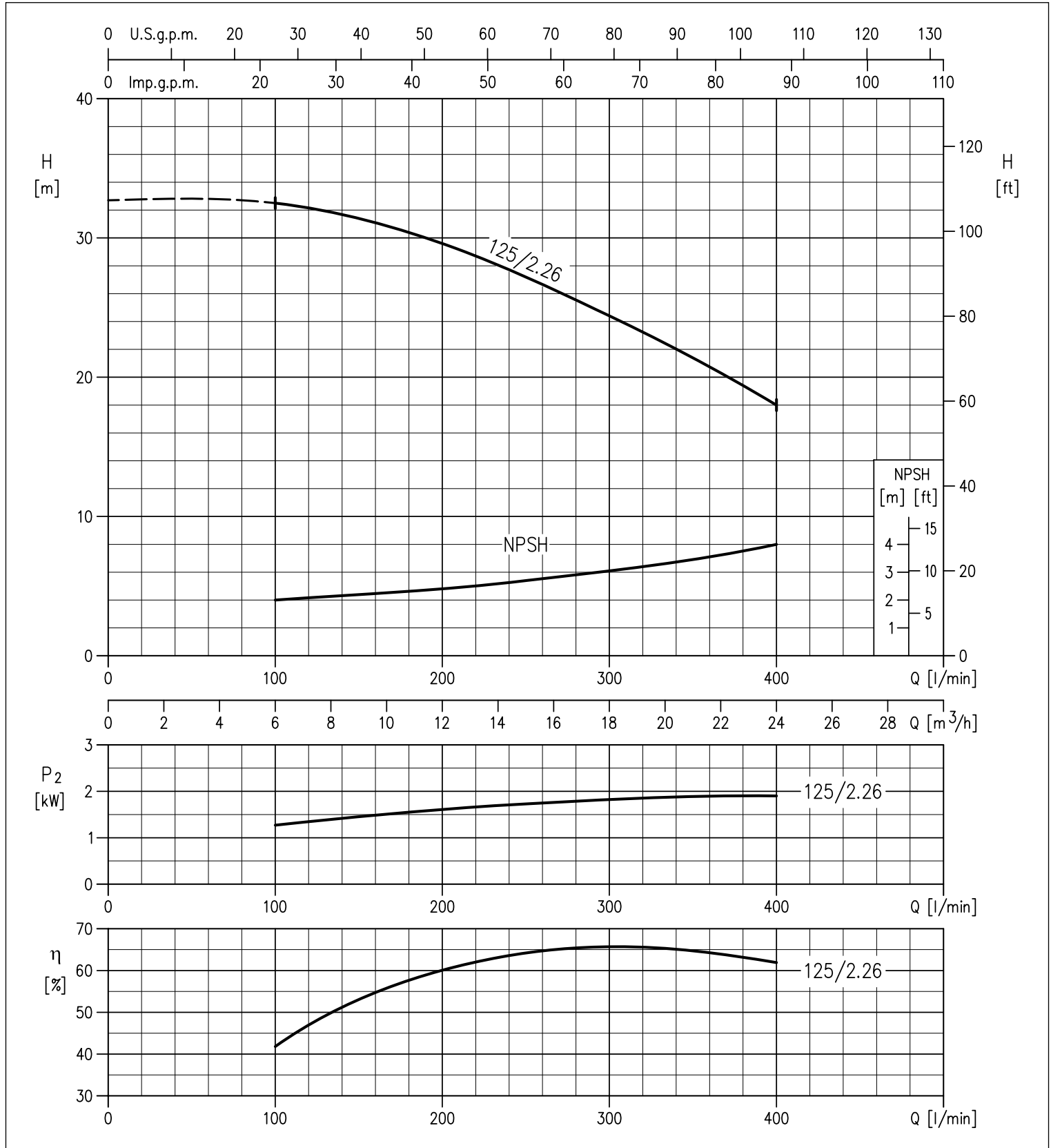

The contents of this publication must not be regarded as binding. EBARA Pumps Europe S.p.A. reserves the right to effect any modification it deems necessary without prior notice.



3D SERIES

CENTRIFUGAL PUMPS CLOSE COUPLED AND STANDARDIZED EN 733

PERFORMANCE CURVES 3D(.) SERIES 32-160 at 2900 min⁻¹ (according to ISO 9906 Attachment A)

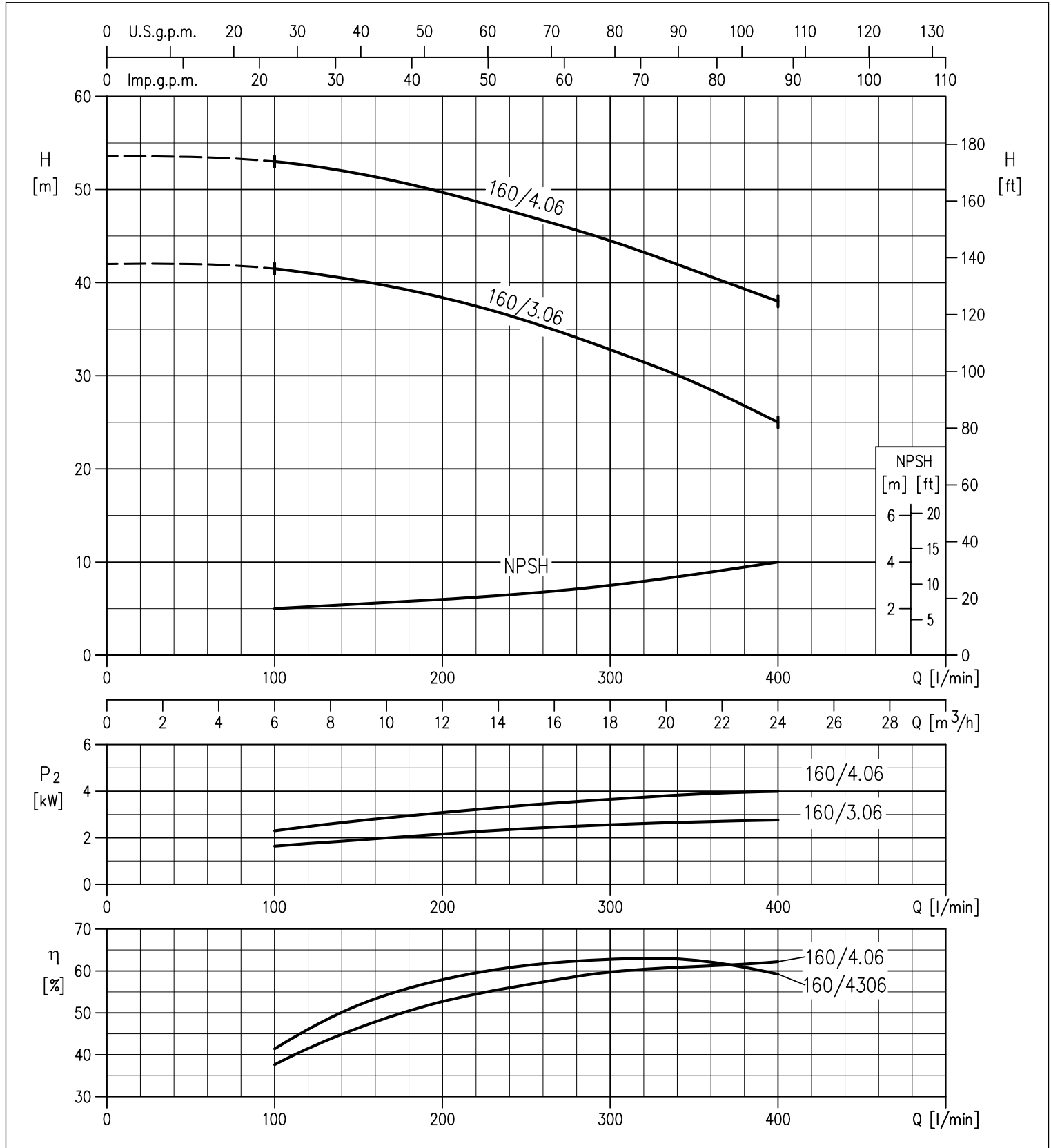

The contents of this publication must not be regarded as binding. EBARA Pumps Europe S.p.A. reserves the right to effect any modification it deems necessary, without prior notice.



3D SERIES

CENTRIFUGAL PUMPS CLOSE COUPLED AND STANDARDIZED EN 733

PERFORMANCE CURVES 3D(.) SERIES 32-200 at 2900 min⁻¹ (according to ISO 9906 Attachment A)

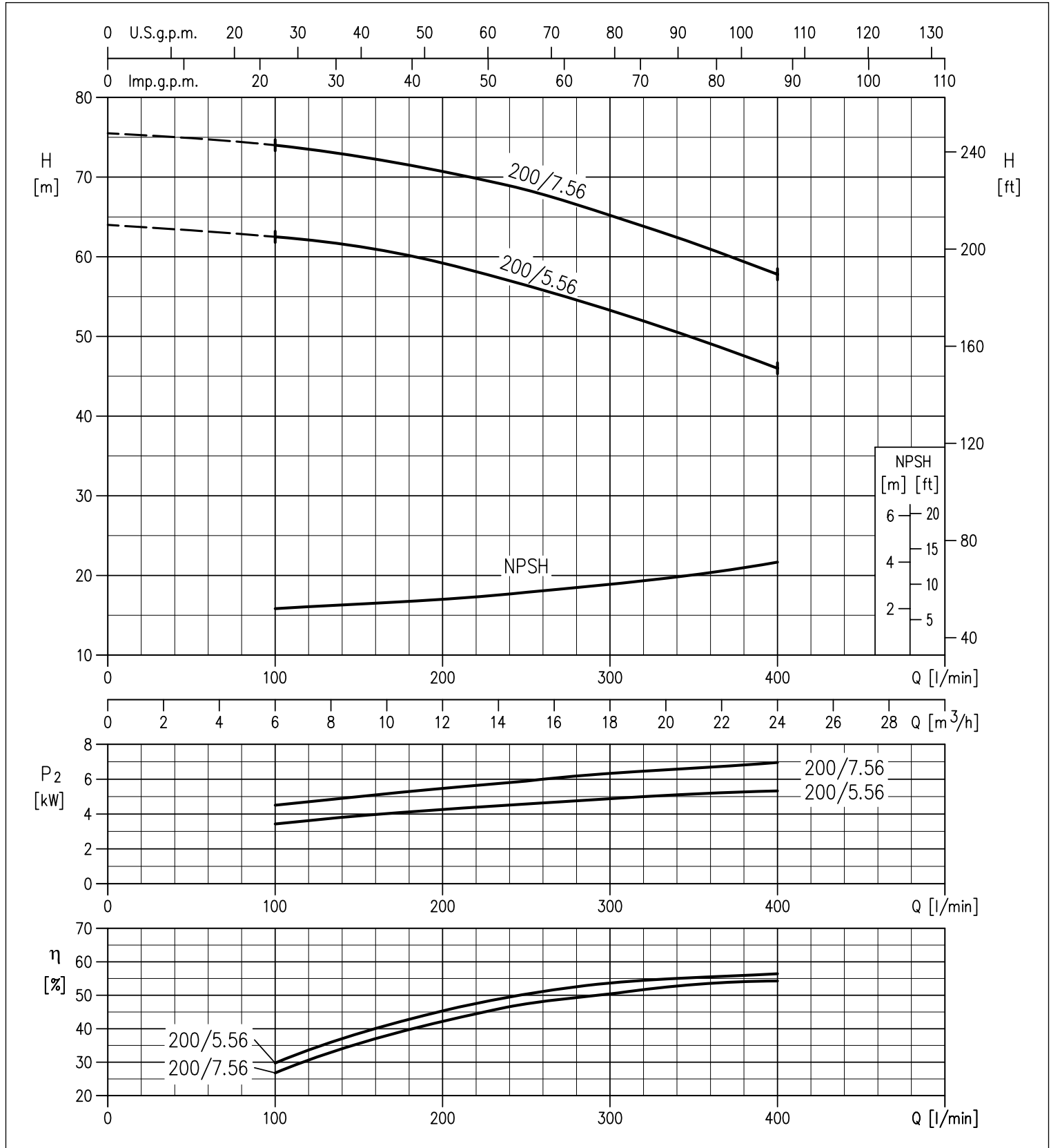

The contents of this publication must not be regarded as binding. EBARA Pumps Europe S.p.A. reserves the right to effect any modification it deems necessary without prior notice.



3D SERIES

CENTRIFUGAL PUMPS CLOSE COUPLED AND STANDARDIZED EN 733

PERFORMANCE CURVES 3D(.) SERIES 40-125 at 2900 min⁻¹ (according to ISO 9906 Attachment A)

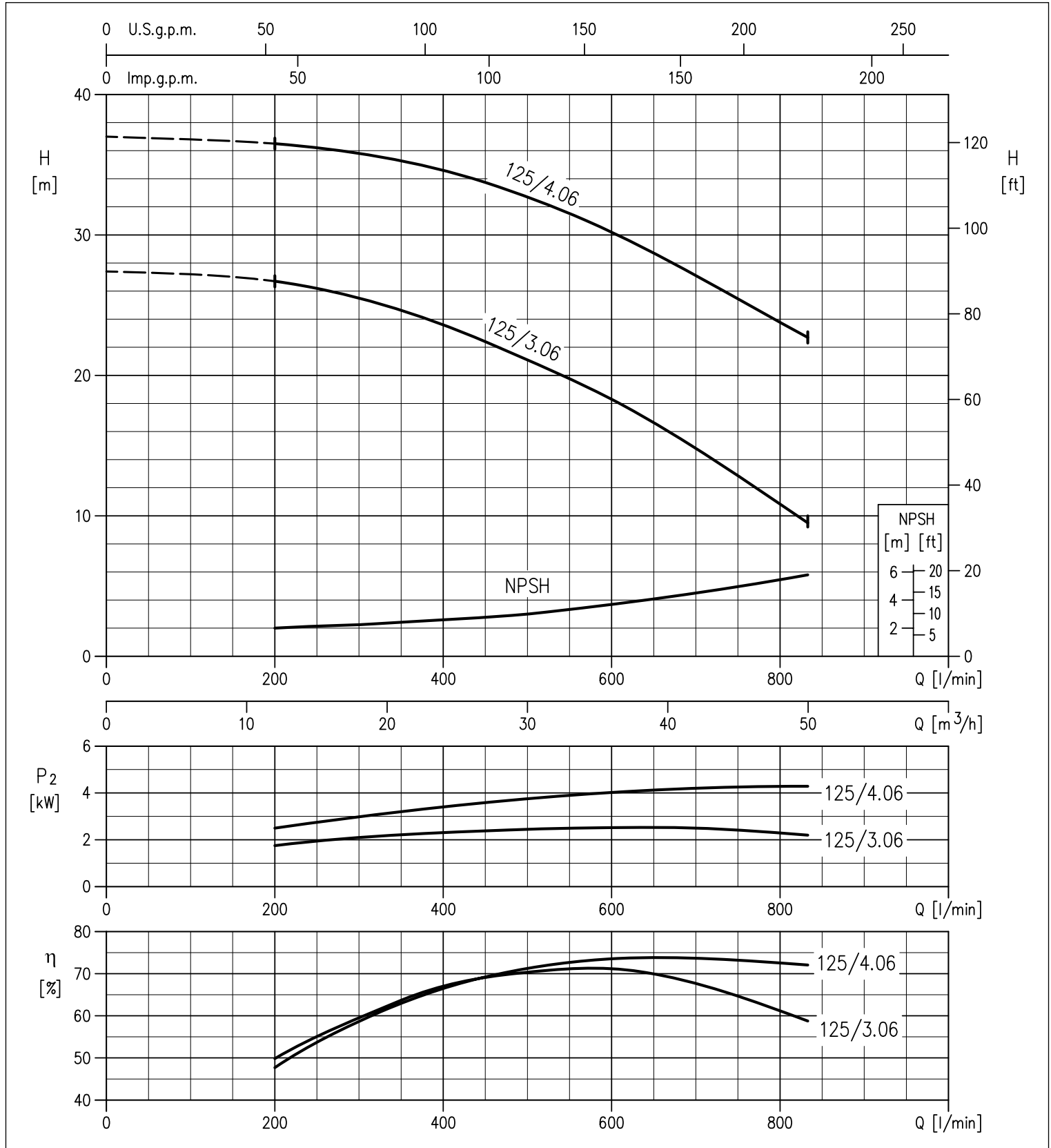

The contents of this publication must not be regarded as binding. EBARA Pumps Europe S.p.A. reserves the right to effect any modification it deems necessary, without prior notice.



3D SERIES

CENTRIFUGAL PUMPS CLOSE COUPLED AND STANDARDIZED EN 733

PERFORMANCE CURVES 3D(.) SERIES 40-160 at 2900 min⁻¹ (according to ISO 9906 Attachment A)

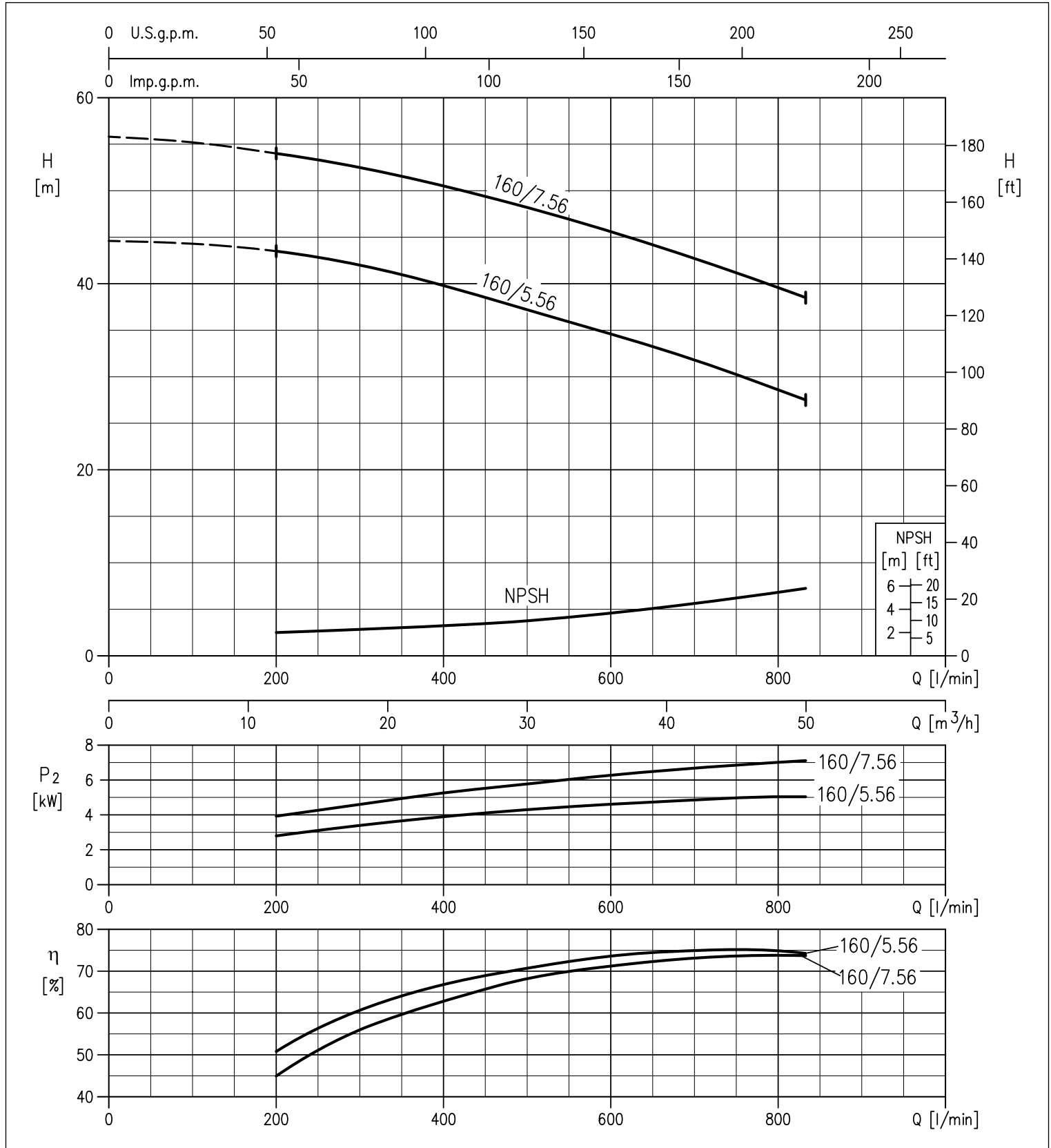

The contents of this publication must not be regarded as binding. EBARA Pumps Europe S.p.A. reserves the right to effect any modification it deems necessary without prior notice.



3D SERIES

CENTRIFUGAL PUMPS CLOSE COUPLED AND STANDARDIZED EN 733

PERFORMANCE CURVES 3D(.) SERIES 40-200 at 2900 min⁻¹ (according to ISO 9906 Attachment A)

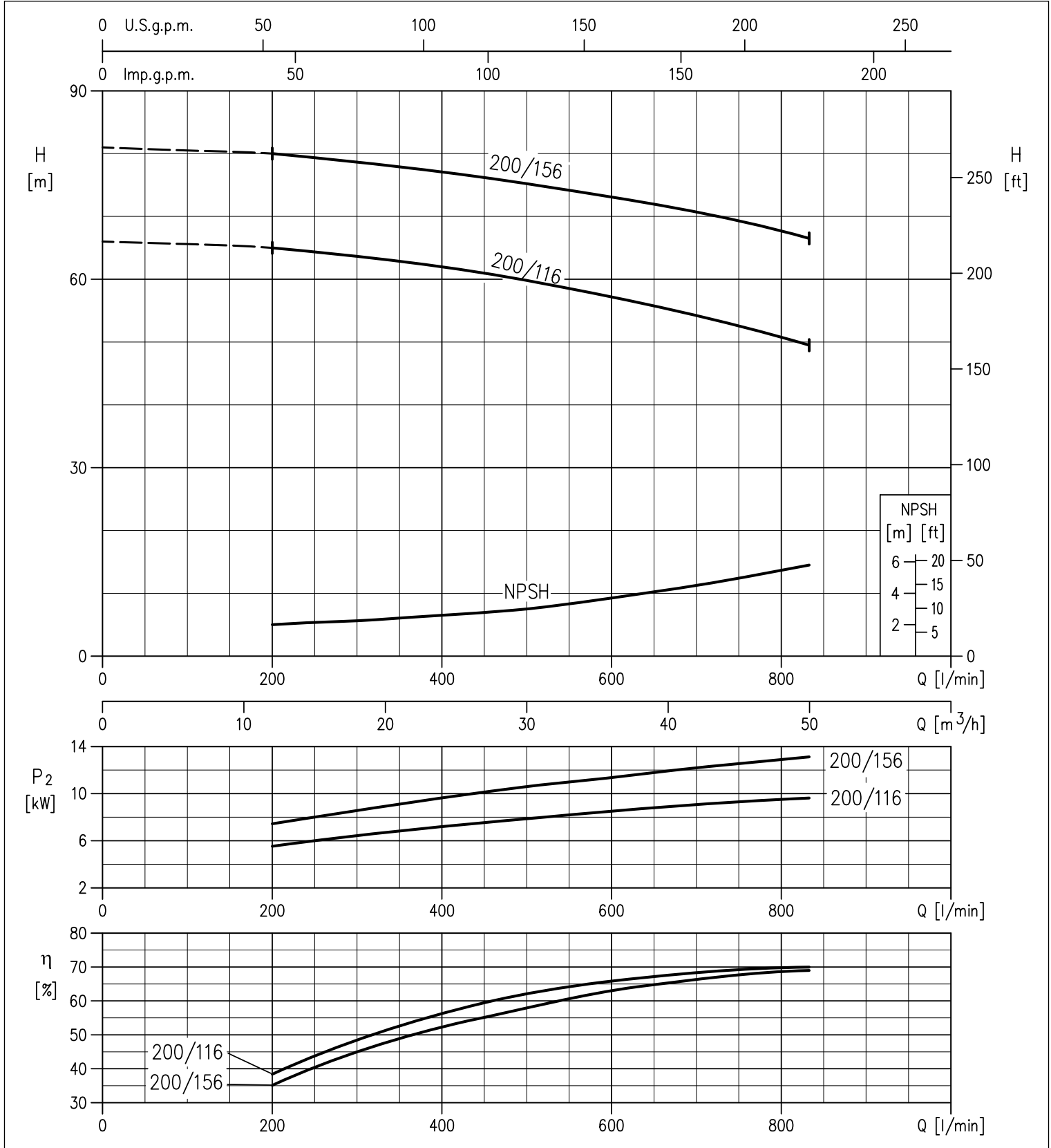

The contents of this publication must not be regarded as binding. EBARA Pumps Europe S.p.A. reserves the right to effect any modification it deems necessary, without prior notice.



3D SERIES

CENTRIFUGAL PUMPS CLOSE COUPLED AND STANDARDIZED EN 733

PERFORMANCE CURVES 3D(.) SERIES 50-125 at 2900 min⁻¹ (according to ISO 9906 Attachment A)

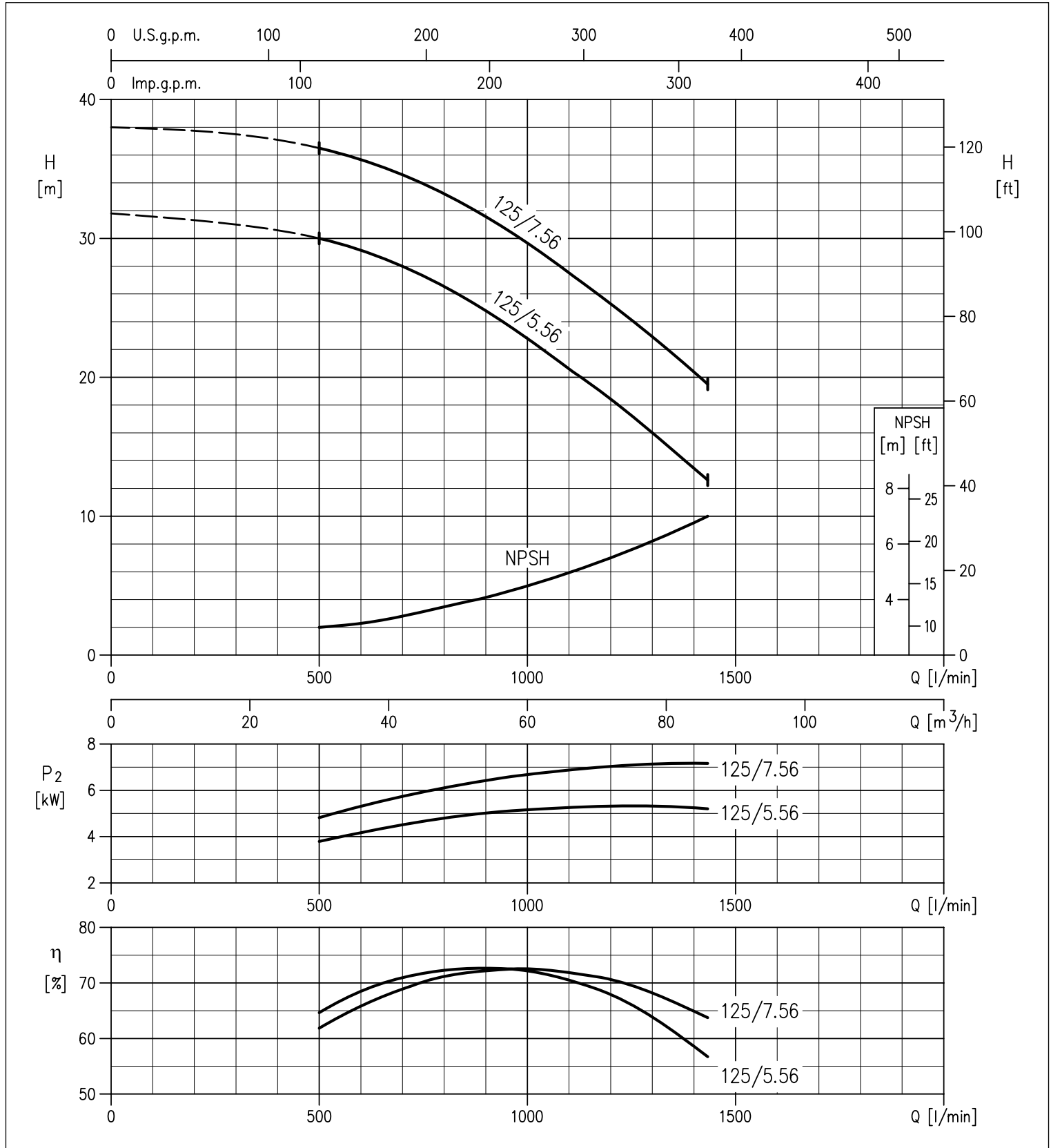

The contents of this publication must not be regarded as binding. EBARA Pumps Europe S.p.A. reserves the right to effect any modification it deems necessary without prior notice.



3D SERIES

CENTRIFUGAL PUMPS CLOSE COUPLED AND STANDARDIZED EN 733

PERFORMANCE CURVES 3D(.) SERIES 50-160 at 2900 min⁻¹ (according to ISO 9906 Attachment A)

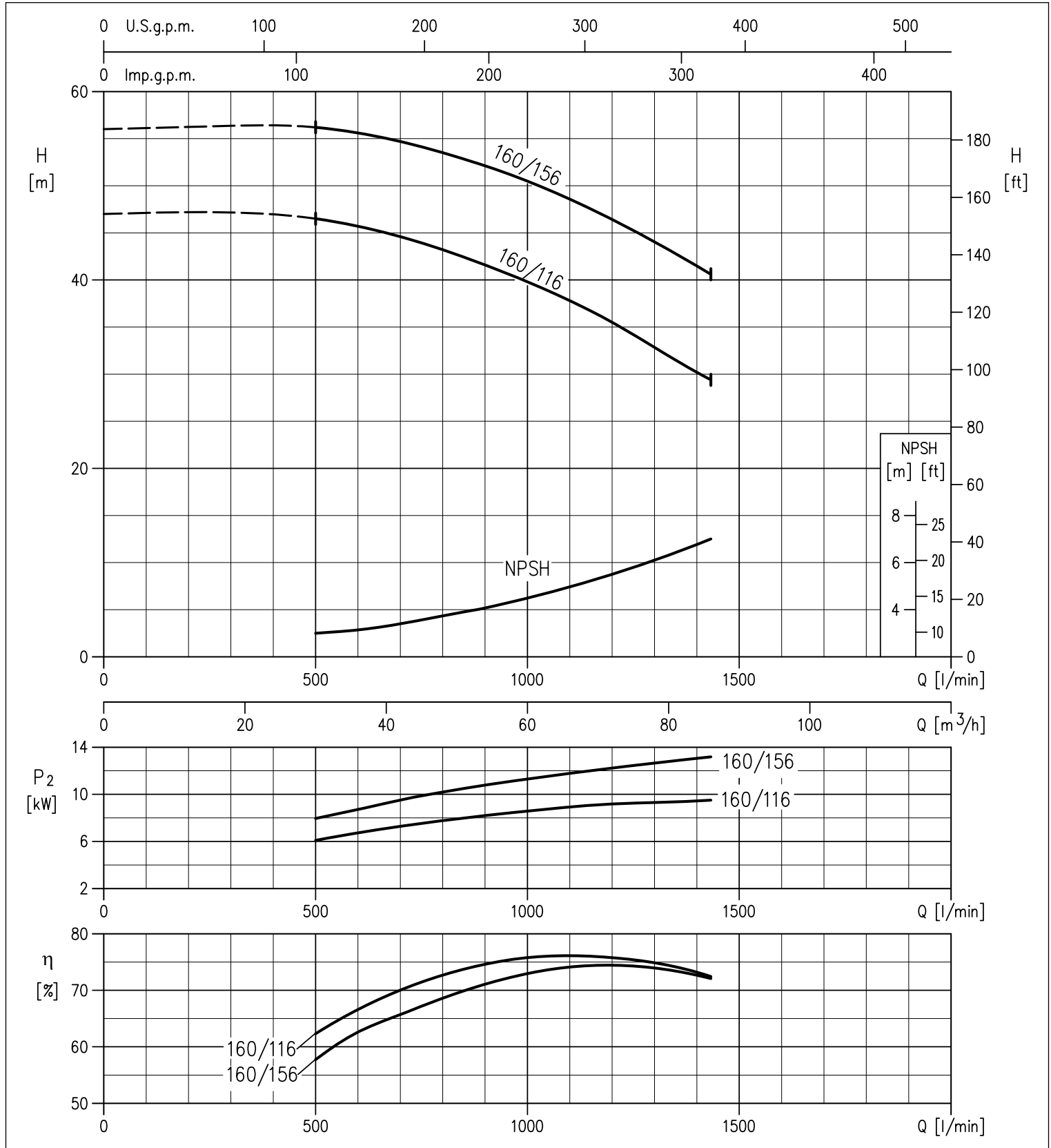

The contents of this publication must not be regarded as binding. EBARA Pumps Europe S.p.A. reserves the right to effect any modification it deems necessary, without prior notice.



3D SERIES

CENTRIFUGAL PUMPS CLOSE COUPLED AND STANDARDIZED EN 733

PERFORMANCE CURVES 3D(.) SERIES 65-125 at 2900 min⁻¹ (according to ISO 9906 Attachment A)

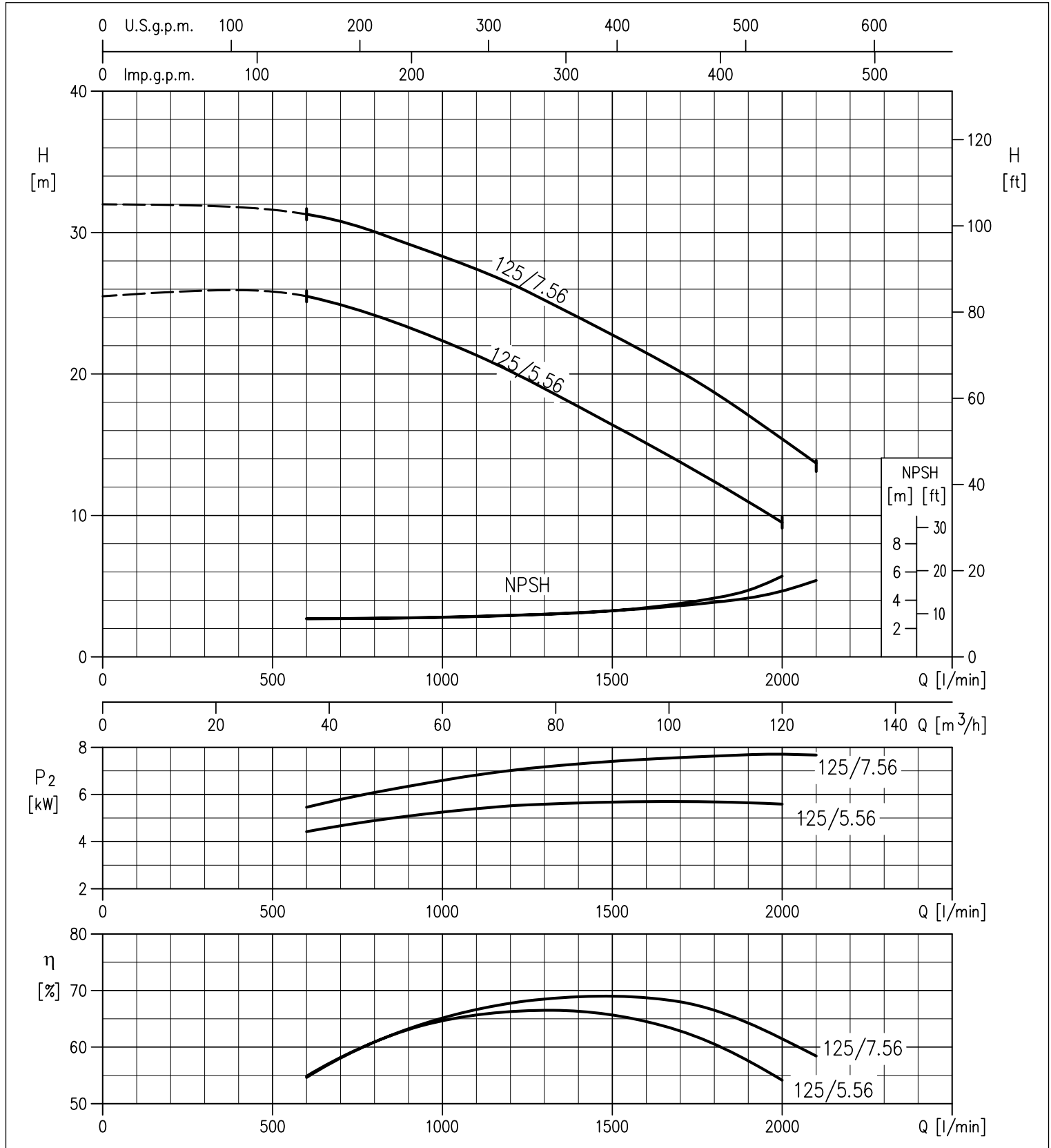

The contents of this publication must not be regarded as binding. EBARA Pumps Europe S.p.A. reserves the right to effect any modification it deems necessary without prior notice.



3D SERIES

CENTRIFUGAL PUMPS CLOSE COUPLED AND STANDARDIZED EN 733

PERFORMANCE CURVES 3D(.) SERIES 65-160 at 2900 min⁻¹ (according to ISO 9906 Attachment A)

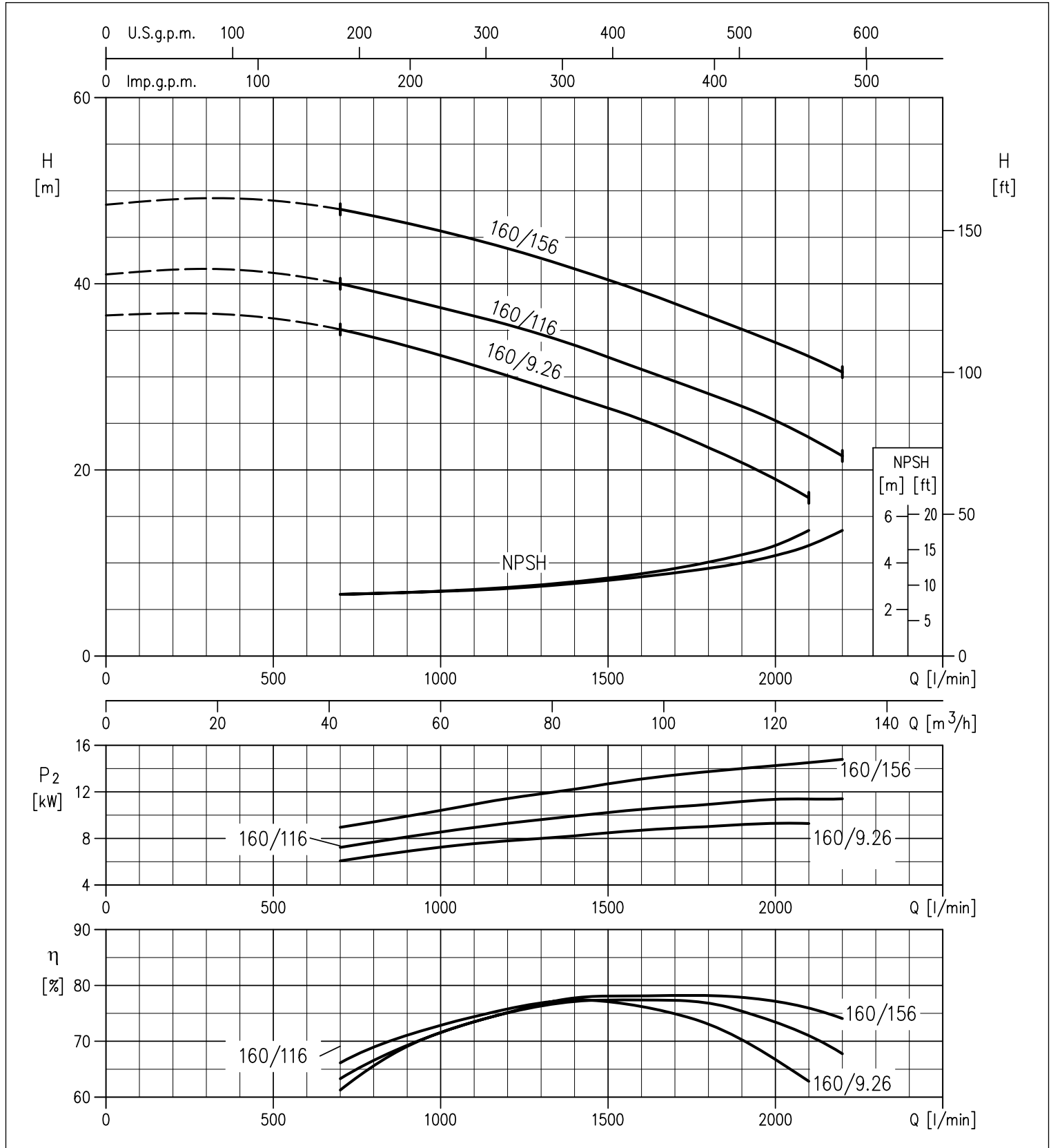

The contents of this publication must not be regarded as binding. EBARA Pumps Europe S.p.A. reserves the right to effect any modification it deems necessary, without prior notice.



3D SERIES

CENTRIFUGAL PUMPS CLOSE COUPLED AND STANDARDIZED EN 733

PERFORMANCE CURVES 3D(.) SERIES 65-200 at 2900 min⁻¹ (according to ISO 9906 Attachment A)

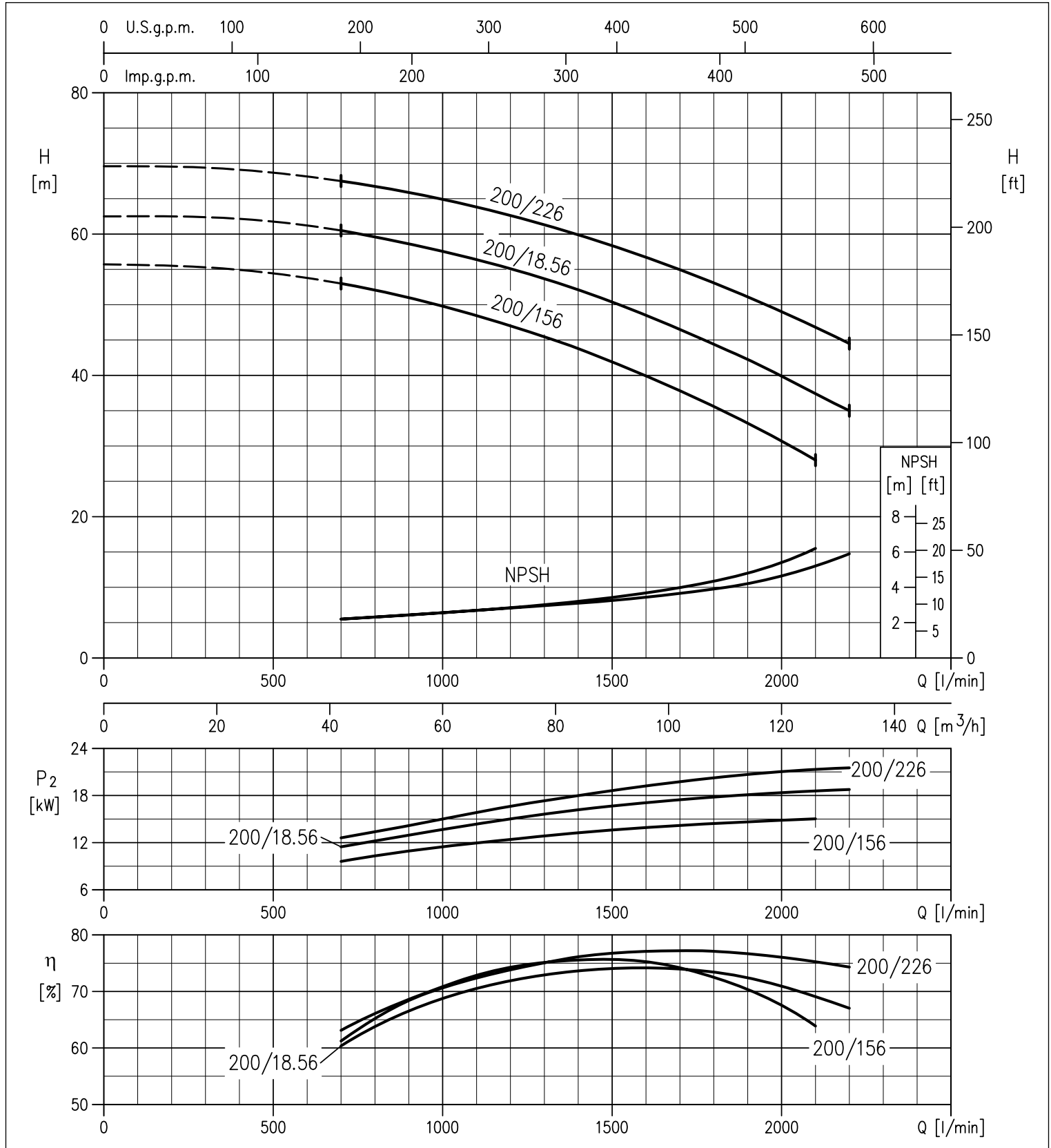

The contents of this publication must not be regarded as binding. EBARA Pumps Europe S.p.A. reserves the right to effect any modification it deems necessary without prior notice.

3D SERIES

CENTRIFUGAL PUMPS CLOSE COUPLED AND STANDARDIZED EN 733

DIMENSIONS 3D SERIES - up to 11kW

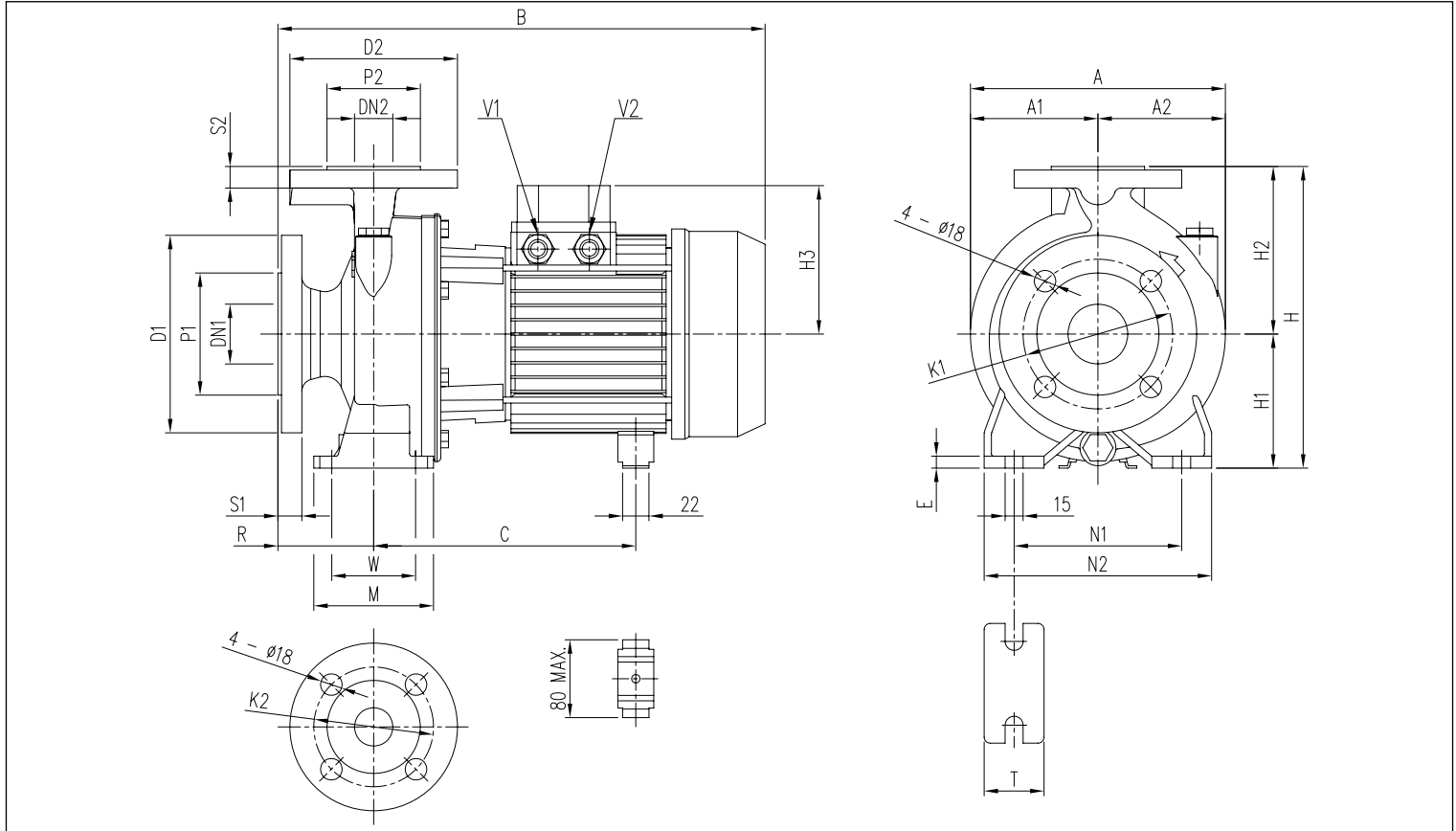

DIMENSIONAL TABLE

Model	Dimensions [mm]																								Weight [kg]				
	DN1 Ø	P1 Ø	K1 Ø	D1 Ø	S1	DN2 Ø	P2 Ø	K2 Ø	D2 Ø	S2	H	H1	H2	H3	R	W	M	N1	N2	T	E	A	A1	A2		B	C	V1	V2
3D 32-125/2.26	50	102	125	165	20	32	78	100	140	18	252	112	140	124	80	70	100	140	190	50	10	213	107	107	432	244±255	-	PG 13,5	31,0
3D 32-160/3.06	50	102	125	165	20	32	78	100	140	18	292	132	160	124	80	70	100	190	240	50	10	254	127	127	471	244±255	-	PG 13,5	37,6
3D 32-160/4.06	50	102	125	165	20	32	78	100	140	18	292	132	160	141	80	70	100	190	240	50	10	254	127	127	494	253	-	PG 16	45,9
3D 32-200/5.56	50	102	125	165	20	32	78	100	140	18	340	160	180	150	80	70	100	190	240	50	10	296	148	148	519	275	PG13,5	PG 16	59,9
3D 32-200/7.56	50	102	125	165	20	32	78	100	140	18	340	160	180	150	80	70	100	190	240	50	10	296	148	148	519	275	PG13,5	PG 16	59,4
3D 40-125/3.06	65	122	145	185	20	40	88	110	150	18	252	112	140	124	80	70	100	160	210	50	10	213	108	112	471	244±255	-	PG 13,5	32,1
3D 40-125/4.06	65	122	145	185	20	40	88	110	150	18	252	112	140	141	80	70	100	160	210	50	10	213	108	112	494	253	-	PG 16	45,7
3D 40-160/5.56	65	122	145	185	20	40	88	110	150	18	292	132	160	150	80	70	100	190	240	50	12	254	127	127	519	275	PG13,5	PG 16	54,3
3D 40-160/7.56	65	122	145	185	20	40	88	110	150	18	292	132	160	150	80	70	100	190	240	50	12	254	127	127	519	275	PG13,5	PG 16	62,2
3D 40-200/116	65	122	145	185	20	40	88	110	150	18	340	160	180	178	100	70	100	212	265	50	12	296	148	148	595	359	PG13,5	PG 21	74,7
3D 50-125/5.56	65	122	145	185	20	50	102	125	165	20	292	132	160	150	100	70	100	190	240	50	10	254	127	127	539	275	PG13,5	PG 16	56,2
3D 50-125/7.56	65	122	145	185	20	50	102	125	165	20	292	132	160	150	100	70	100	190	240	50	10	254	127	127	539	275	PG13,5	PG 16	62,8
3D 50-160/116	65	122	145	185	20	50	102	125	165	20	340	160	180	178	100	70	100	212	265	50	10	296	148	148	595	359	PG13,5	PG 21	76,6
3D 65-125/5.56	80	138	160	200	22	65	122	145	185	20	340	160	180	150	100	95	125	212	280	65	12	254	127	136	539	275	PG13,5	PG 16	67,3
3D 65-125/7.56	80	138	160	200	22	65	122	145	185	20	340	160	180	150	100	95	125	212	280	65	23	254	127	136	539	275	PG13,5	PG 16	68,3
3D 65-160/9.26	80	138	160	200	22	65	122	145	185	20	360	160	200	178	100	95	125	212	280	65	12	296	148	148	595	359	PG13,5	PG 21	71,9
3D 65-160/116	80	138	160	200	22	65	122	145	185	20	360	160	200	178	100	95	125	212	280	65	12	296	148	148	595	359	PG13,5	PG 21	81,0

DIMENSIONS 3D SERIES - from 15kW and above

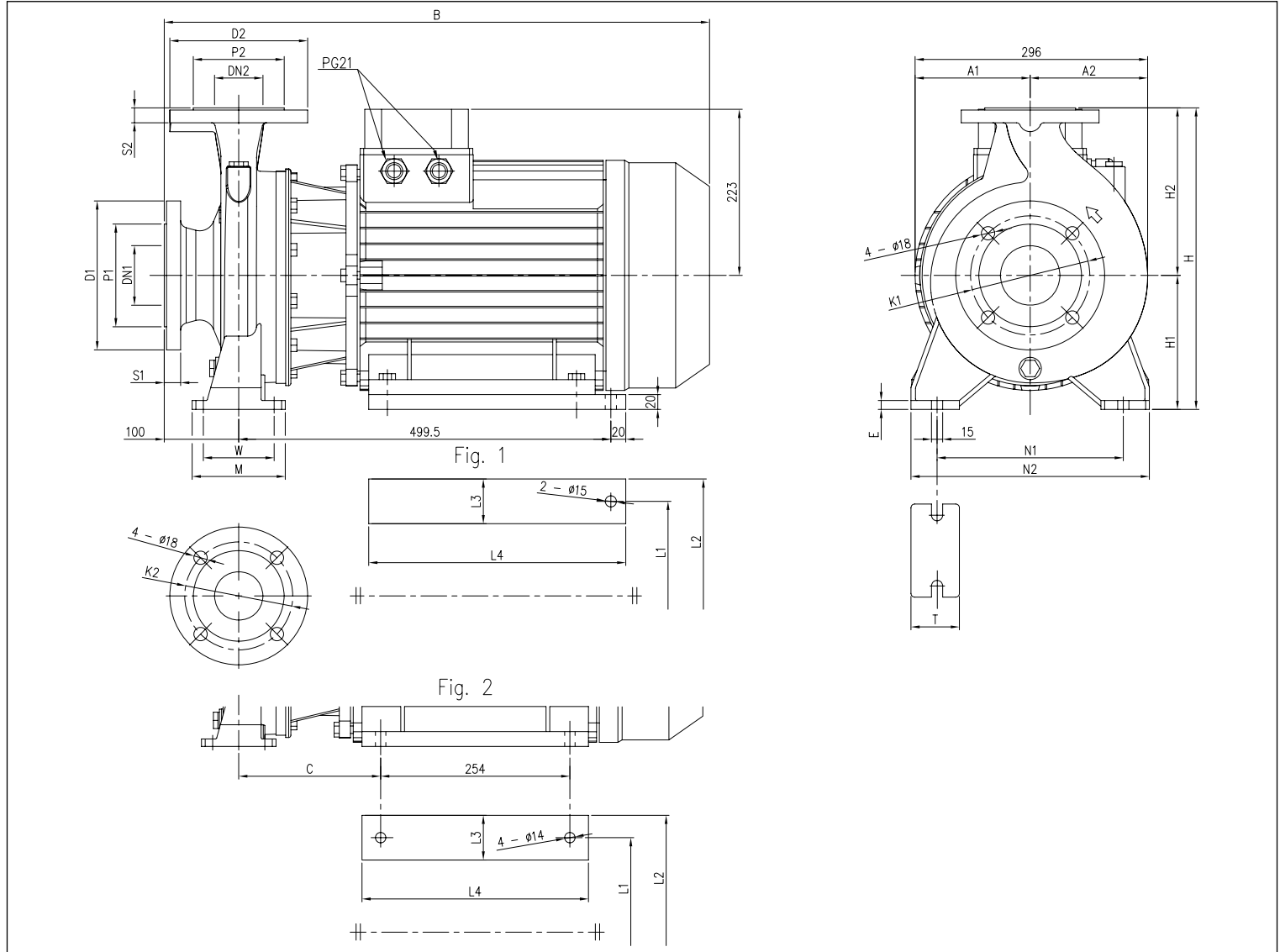

DIMENSIONAL TABLE

Model	Dimensions [mm]																				Weight [kg]								
	DN1 Ø	P1 Ø	K1 Ø	D1 Ø	S1	DN2 Ø	P2 Ø	K2 Ø	D2 Ø	S2	Fig.	H	H1	H2	W	M	N1	N2	T	E		A1	A2	B	C	L1	L2	L3	L4
3D 40-200/156	65	122	145	185	20	40	88	110	150	18	2	340	160	180	70	100	212	265	50	12	148	148	723	190,5	254	318	64	304	115,7
3D 50-160/156	65	122	145	185	20	50	102	125	165	20	2	340	160	180	70	100	212	265	50	10	148	148	723	190,5	254	318	64	304	93,1
3D 65-160/156	80	138	160	200	22	65	122	145	185	20	2	360	160	200	95	125	212	280	65	12	148	148	732	199,5	254	318	64	304	119,0
3D 65-200/156	80	138	160	200	22	65	122	145	185	20	1	405	180	225	95	125	250	320	65	12	154,5	157,5	732	-	254	314	60	345	122,5
3D 65-200/18.56	80	138	160	200	22	65	122	145	185	20	1	405	180	225	95	125	250	320	65	12	154,5	157,5	732	-	254	314	60	345	136,5
3D 65-200/226	80	138	160	200	22	65	122	145	185	20	1	405	180	225	95	125	250	320	65	12	154,5	157,5	732	-	254	314	60	345	144,5

The contents of this publication must not be regarded as binding. EBARA Pumps Europe S.p.A. reserves the right to effect any modification it deems necessary without prior notice.

DIMENSIONS 3DS SERIES 32, 65

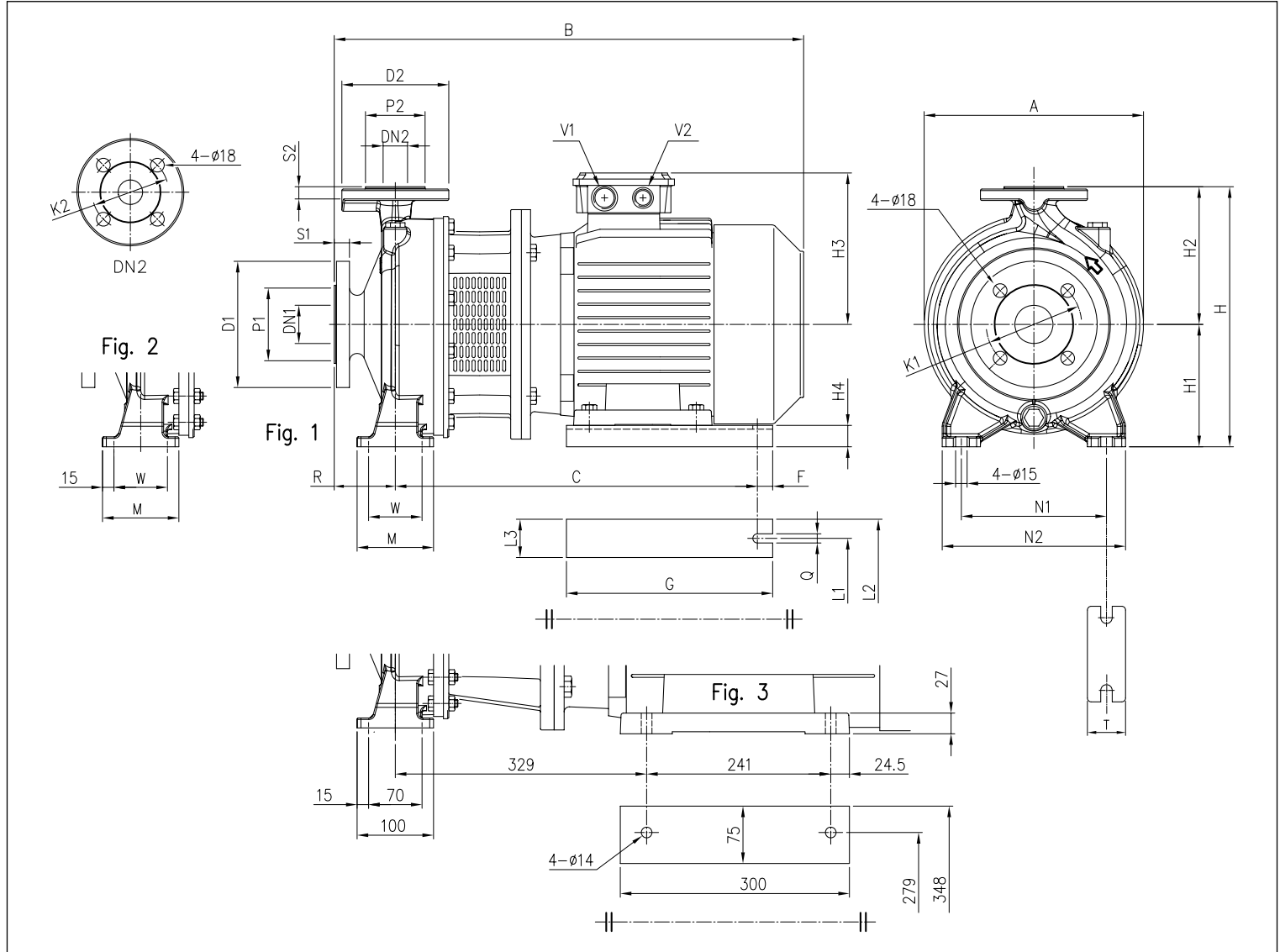

DIMENSIONAL TABLE

Model	Dimensions [mm]																										Weight [kg]									
	DN1 Ø	P1 Ø	K1 Ø	D1 Ø	S1	DN2 Ø	P2 Ø	K2 Ø	D2 Ø	S2	Fig.	H	H1	H2	H3	H4	R	W	M	N1	N2	T	A	B	C	F		G	Q	L1	L2	L3	V1	V2		
3DS 32-160/3.06	50	102	125	165	20	32	78	100	140	18	1	292	132	160	155	32	80	70	100	190	240	50	254	528	388	15	220	12	160	200	40	M25X1,5	M20X1,5	49,8		
3DS 32-160/4.06	50	102	125	165	20	32	78	100	140	18	1	292	132	160	171	20	80	70	100	190	240	50	254	550	395	15	220	12	190	240	50	M25X1,5	M20X1,5	51,4		
3DS 32-200/5.56	50	102	125	165	20	32	78	100	140	18	1	340	160	180	198	28	80	70	100	190	240	50	300	607	479	15	270	12	216	266	50	M32X1,5	M32X1,5	83,2		
3DS 32-200/7.56	50	102	125	165	20	32	78	100	140	18	1	340	160	180	198	28	80	70	100	190	240	50	300	607	479	15	270	12	216	266	50	M32X1,5	M32X1,5	96,4		
3DS 65-125/5.56	80	138	160	200	22	65	122	145	185	20	2	340	160	180	198	28	100	95	125	212	280	65	300	627	479	15	270	12	216	266	50	M32X1,5	M32X1,5	75,3		
3DS 65-125/7.56	80	138	160	200	22	65	122	145	185	20	2	340	160	180	198	28	100	95	125	212	280	65	300	627	479	15	270	12	216	266	50	M32X1,5	M32X1,5	92,7		
3DS 65-160/9.26	80	138	160	200	22	65	122	145	185	20	2	360	160	200	198	28	100	95	125	212	280	65	300	667	479	15	270	12	216	266	50	M32X1,5	M32X1,5	103,0		
3DS 65-200/15.6	80	138	160	200	22	65	122	145	185	20	2	405	180	225	238	20	100	95	125	250	320	65	350	806	621	20	350	14	254	314	60	M40X1,5	M40X1,5	137,6		
3DS 65-200/18.56	80	138	160	200	22	65	122	145	185	20	2	405	180	225	238	20	100	95	125	250	320	65	350	850	621	20	350	14	254	314	60	M40X1,5	M40X1,5	147,2		
3DS 65-200/22.6	80	138	160	200	22	65	122	145	185	20	3	405	180	225	268	-	100	-	-	250	320	65	360	885	-	-	-	-	-	-	-	-	-	M32X1,5	M32X1,5	184,5

3D SERIES

CENTRIFUGAL PUMPS CLOSE COUPLED AND STANDARDIZED EN 733

DIMENSIONS 3DS SERIES 40, 50, 65

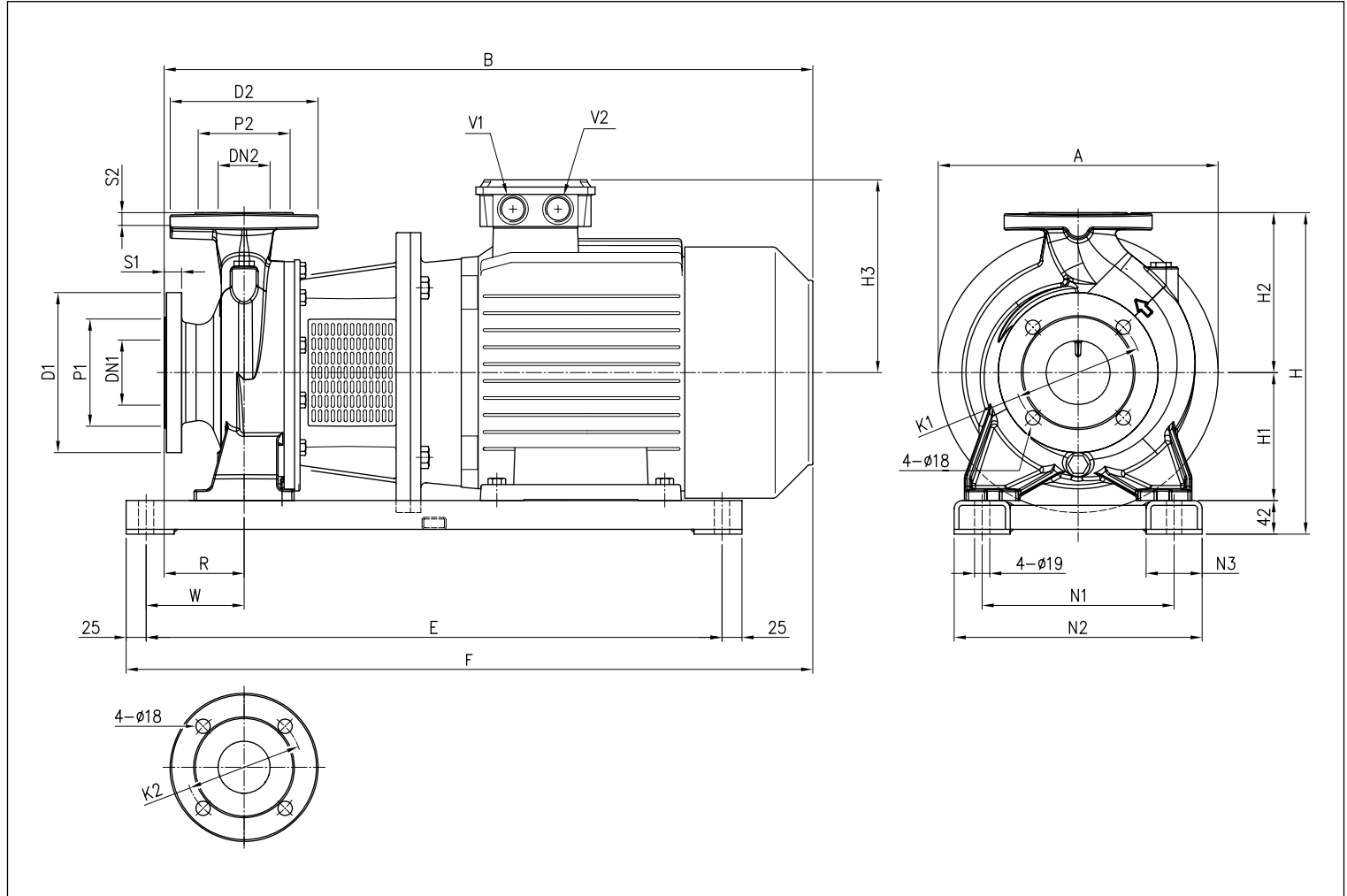

DIMENSIONAL TABLE

Model	Dimensions [mm]																							Weight [kg]		
	DN1	P1	K1	D1	S1	DN2	P2	K2	D2	S2	H	H1	H2	H3	R	W	N1	N2	N3	A	B	E	F		V1	V2
3DS 40-125/3.06	65	122	145	185	20	40	88	110	150	18	294	112	140	155	80	90	180	240	60	250	528	500	563	M25x1,5	M20x1,5	43,6
3DS 40-125/4.06	65	122	145	185	20	40	88	110	150	18	294	112	140	171	80	90	180	240	60	250	550	500	585	M25x1,5	M20x1,5	53,7
3DS 40-160/5.56	65	122	145	185	20	40	88	110	150	18	334	132	160	198	80	110	210	270	60	300	607	600	662	M32x1,5	M32x1,5	83,2
3DS 40-160/7.56	65	122	145	185	20	40	88	110	150	18	334	132	160	198	80	110	210	270	60	300	607	600	662	M32x1,5	M32x1,5	91,0
3DS 40-200/116	65	122	145	185	20	40	88	110	150	18	382	160	180	238	100	110	240	310	70	350	796	720	831	M40x1,5	M40x1,5	119,7
3DS 40-200/156	65	122	145	185	20	40	88	110	150	18	382	160	180	238	100	110	240	310	70	350	796	720	831	M40x1,5	M40x1,5	143,7
3DS 50-125/5.56	65	122	145	185	20	50	102	125	165	20	334	132	160	198	100	110	210	270	60	300	627	600	662	M32x1,5	M32x1,5	75,1
3DS 50-125/7.56	65	122	145	185	20	50	102	125	165	20	334	132	160	198	100	110	210	270	60	300	627	600	662	M32x1,5	M32x1,5	100,3
3DS 50-160/116	65	122	145	185	20	50	102	125	165	20	382	160	180	238	100	110	240	310	70	350	796	720	831	M40x1,5	M40x1,5	88,6
3DS 50-160/156	65	122	145	185	20	50	102	125	165	20	382	160	180	238	100	110	240	310	70	350	796	720	831	M40x1,5	M40x1,5	116,6
3DS 65-160/116	80	138	160	200	22	65	122	145	185	20	402	160	200	238	100	122,5	240	310	70	350	796	720	844	M40x1,5	M40x1,5	89,6
3DS 65-160/156	80	138	160	200	22	65	122	145	185	20	402	160	200	238	100	122,5	240	310	70	350	806	720	854	M40x1,5	M40x1,5	117,6

DIMENSIONS 3DP 32, 40, 50, 65

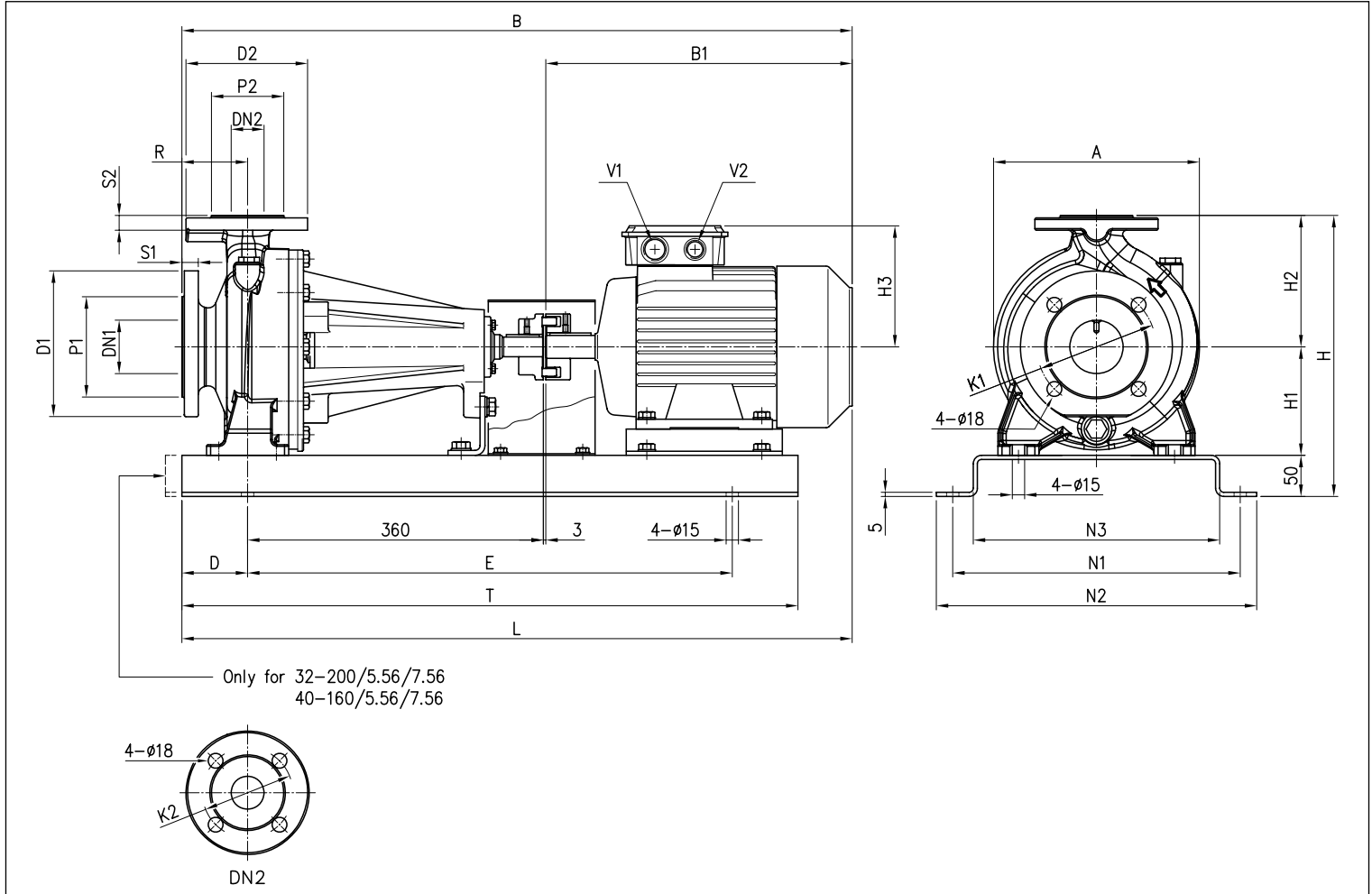

DIMENSIONAL TABLE

Model	Dimensions [mm]																								Weight [kg]			
	DN1 Ø	P1 Ø	K1 Ø	D1 Ø	S1	DN2 Ø	P2 Ø	K2 Ø	D2 Ø	S2	H	H1	H2	H3	R	A	B	B2	D	E	N1	N2	N3	T		L	V1	V2
3DP 32-125/2.26	50	102	125	165	20	32	78	100	140	18	302	112	140	148	80	213	760	760	80	550	300	340	250	710	760	M25x1,5	M20x1,5	61,4
3DP 32-160/3.06	50	102	125	165	20	32	78	100	140	18	342	132	160	155	80	254	831	831	80	590	350	390	300	750	809	M25x1,5	M20x1,5	81,9
3DP 32-160/4.06	50	102	125	165	20	32	78	100	140	18	342	132	160	171	80	254	831	831	80	590	350	390	300	750	831	M25x1,5	M20x1,5	85,5
3DP 32-200/5.56	50	102	125	165	20	32	78	100	140	18	390	160	180	198	80	296	885	885	100	650	350	390	300	850	905	M32x1,5	M32x1,5	108,4
3DP 32-200/7.56	50	102	125	165	20	32	78	100	140	18	390	160	180	198	80	296	885	885	100	650	350	390	300	850	905	M32x1,5	M32x1,5	121,6
3DP 40-125/3.06	65	122	145	185	20	40	88	110	150	18	302	112	140	155	80	213	809	809	80	590	300	340	250	750	809	M25x1,5	M20x1,5	89,1
3DP 40-125/4.06	65	122	145	185	20	40	88	110	150	18	302	112	140	171	80	213	831	831	80	590	300	340	250	750	831	M25x1,5	M20x1,5	75,7
3DP 40-160/5.56	65	122	145	185	20	40	88	110	150	18	342	132	160	198	80	254	885	885	100	650	350	390	300	850	905	M32x1,5	M32x1,5	109,0
3DP 40-160/7.56	65	122	145	185	20	40	88	110	150	18	342	132	160	198	80	254	885	885	100	650	350	390	300	850	905	M32x1,5	M32x1,5	115,9
3DP 40-200/116	65	122	145	185	20	40	88	110	150	18	390	160	180	238	100	296	1071	1071	100	800	380	420	330	1000	1071	M40x1,5	M40x1,5	129,7
3DP 40-200/156	65	122	145	185	20	40	88	110	150	18	390	160	180	238	100	296	1071	1071	100	800	380	420	330	1000	1071	M40x1,5	M40x1,5	130,7
3DP 50-125/5.56	65	122	145	185	20	50	102	125	165	20	342	132	160	198	100	254	905	905	100	650	350	390	300	850	905	M32x1,5	M32x1,5	110,3
3DP 50-125/7.56	65	122	145	185	20	50	102	125	165	20	342	132	160	198	100	254	905	905	100	650	350	390	300	850	905	M32x1,5	M32x1,5	117,2
3DP 50-160/116	65	122	145	185	20	50	102	125	165	20	390	160	180	238	100	296	1071	1071	100	800	380	420	330	1000	1071	M40x1,5	M40x1,5	130,1
3DP 50-160/156	65	122	145	185	20	50	102	125	165	20	390	160	180	238	100	296	1071	1071	100	800	380	420	330	1000	1071	M40x1,5	M40x1,5	131,1
3DP 65-125/5.56	80	138	160	200	22	65	122	145	185	20	390	160	180	198	100	254	905	905	100	650	350	390	300	850	905	M32x1,5	M32x1,5	114,3
3DP 65-125/7.56	80	138	160	200	22	65	122	145	185	20	390	160	180	198	100	254	905	905	100	650	350	390	300	850	905	M32x1,5	M32x1,5	122,7
3DP 65-160/9.26	80	138	160	200	22	65	122	145	185	20	410	160	200	198	100	296	945	945	100	650	350	390	300	850	945	M32x1,5	M32x1,5	133,0
3DP 65-160/116	80	138	160	200	22	65	122	145	185	20	410	160	200	238	100	296	1071	1071	100	800	380	420	330	1000	1071	M40x1,5	M40x1,5	130,0
3DP 65-160/156	80	138	160	200	22	65	122	145	185	20	410	160	200	238	100	296	1071	1071	100	800	380	420	330	1000	1071	M40x1,5	M40x1,5	128,1
3DP 65-200/156	80	138	160	200	22	65	122	145	185	20	455	180	225	238	100	296	1071	1071	100	800	380	420	330	1000	1071	M40x1,5	M40x1,5	136,6
3DP 65-200/18.56	80	138	160	200	22	65	122	145	185	20	455	180	225	238	100	296	1115	1115	100	800	380	420	330	1000	1115	M40x1,5	M40x1,5	145,2
3DP 65-200/226	80	138	160	200	22	65	122	145	185	20	455	180	225	268	100	296	1150	1150	100	800	410	450	360	1000	1150	M32x1,5	M32x1,5	198,5

3D SERIES

CENTRIFUGAL PUMPS CLOSE COUPLED AND STANDARDIZED EN 733

Joint for 3DS SERIES

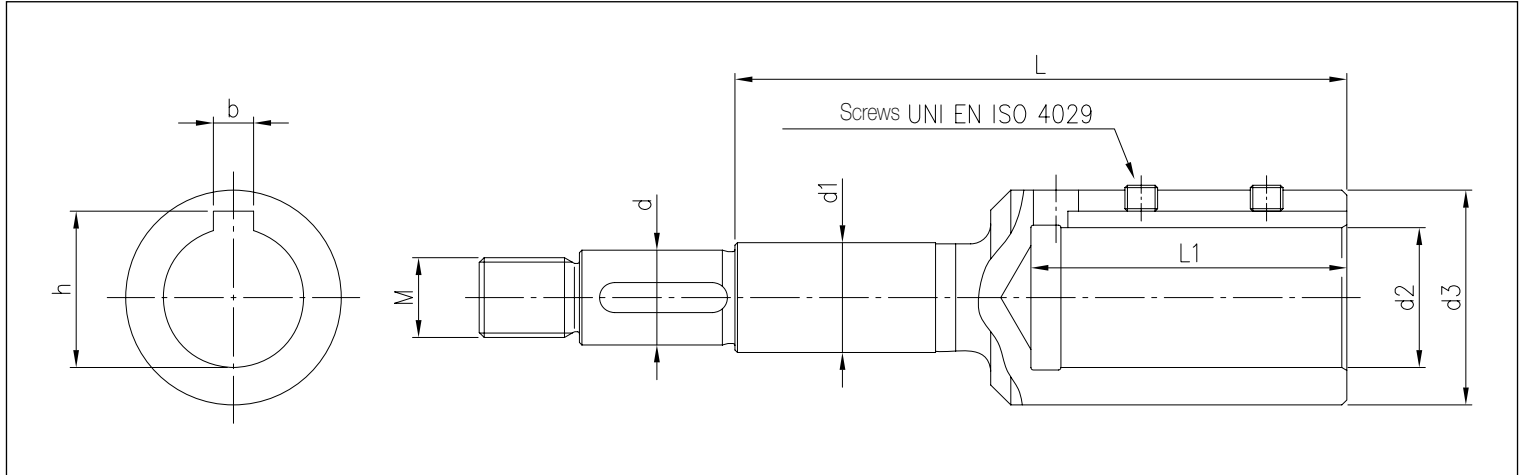

DIMENSIONAL TABLE

Model	[HP]	[kW]	Motor size	Dimensions [mm]									
				d	d1	d2	d3	M	L	L1	b	h	Screws
3DS 32-125/2.26	3	2.2	90	19	22	24	39	M16x1.5	110	53	8	27.3	M8x8
3DS 32-160/3.06	4	3	100	19	22	28	43	M16x1.5	122	63	8	31.3	M8x8
3DS 32-160/4.06	5.5	4	112	19	22	28	43	M16x1.5	122	63	8	31.3	M8x8
3DS 32-200/5.56	7.5	5.5	132	19	22	38	58	M16x1.5	145	84	10	41.3	M8x8
3DS 32-200/7.56	10	7.5	132	19	22	38	58	M16x1.5	145	84	10	41.3	M8x8
3DS 40-125/3.06	4	3	100	19	22	28	43	M16x1.5	122	63	8	31.3	M8x8
3DS 40-125/4.06	5.5	4	112	19	22	28	43	M16x1.5	122	63	8	31.3	M8x8
3DS 40-160/5.56	7.5	5.5	132	19	22	38	58	M16x1.5	145	84	10	41.3	M8x8
3DS 40-160/7.56	10	7.5	132	19	22	38	58	M16x1.5	145	84	10	41.3	M8x8
3DS 40-200/116	15	11	160	19	22	42	63	M16x1.5	178	114	12	45.3	M8x8
3DS 40-200/156	20	15	160	19	22	42	63	M16x1.5	178	114	12	45.3	M8x8
3DS 50-125/5.56	7.5	5.5	132	19	22	38	58	M16x1.5	145	84	10	41.3	M8x8
3DS 50-125/7.56	10	7.5	132	19	22	38	58	M16x1.5	145	84	10	41.3	M8x8
3DS 50-160/116	15	11	160	19	22	42	63	M16x1.5	178	114	12	45.3	M8x8
3DS 50-160/156	20	15	160	19	22	42	63	M16x1.5	178	114	12	45.3	M8x8
3DS 65-125/5.56	7.5	5.5	132	19	22	38	58	M16x1.5	145	84	10	41.3	M8x8
3DS 65-125/7.56	10	7.5	132	19	22	38	58	M16x1.5	145	84	10	41.3	M8x8
3DS 65-160/9.26	12.5	9.2	132	19	22	38	58	M16x1.5	145	84	10	41.3	M8x8
3DS 65-160/116	15	11	160	19	22	42	63	M16x1.5	178	114	12	45.3	M8x8
3DS 65-160/156	20	15	160	24	30	42	63	M20x1.5	184	114	12	45.3	M8x8
3DS 65-200/156	20	15	160	24	30	42	63	M20x1.5	184	114	12	45.3	M8x8
3DS 65-200/18.56	25	18.5	160	24	30	42	63	M20x1.5	184	114	12	45.3	M8x8
3DS 65-200/226	30	22	180	24	30	48	72	M20x1.5	184	114	14	51.8	M10x10

The contents of this publication must not be regarded as binding. EBARA Pumps Europe S.p.A. reserves the right to effect any modification it deems necessary, without prior notice.

3D SERIES

CENTRIFUGAL PUMPS CLOSE COUPLED AND STANDARDIZED EN 733

Joint for 3DP SERIES

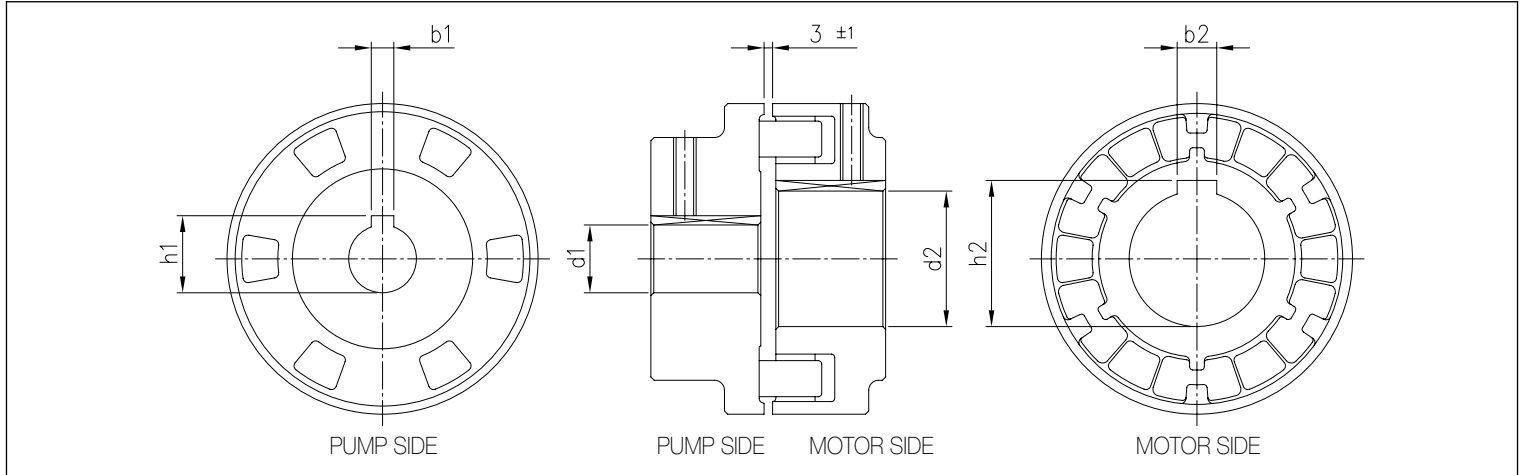

DIMENSIONAL TABLE

Model	[HP]	[kW]	Motor size	Dimensions [mm]					
				d1	b1	h1	d2	b2	h2
3DP 32-125/2.26	2,2	3	90	24	8	27.3	24	8	27.3
3DP 32-160/3.06	3	4	100	24	8	27.3	28	8	31.3
3DP 32-160/4.06	4	5,5	112	24	8	27.3	28	8	31.3
3DP 32-200/5.56	5,5	7,5	132	24	8	27.3	38	10	41.3
3DP 32-200/7.56	7,5	10	132	24	8	27.3	38	10	41.3
3DP 40-125/3.06	3	4	100	24	8	27.3	28	8	31.3
3DP 40-125/4.06	4	5,5	112	24	8	27.3	28	8	31.3
3DP 40-160/5.56	5,5	7,5	132	24	8	27.3	38	10	41.3
3DP 40-160/7.56	7,5	10	132	24	8	27.3	38	10	41.3
3DP 40-200/116	11	15	160	24	8	27.3	42	12	45.3
3DP 40-200/156	15	20	160	24	8	27.3	42	12	45.3
3DP 50-125/5.56	5,5	7,5	132	24	8	27.3	38	10	41.3
3DP 50-125/7.56	7,5	10	132	24	8	27.3	38	10	41.3
3DP 50-160/116	11	15	160	24	8	27.3	42	12	45.3
3DP 50-160/156	15	20	160	24	8	27.3	42	12	45.3
3DP 65-125/5.56	5,5	7,5	132	24	8	27.3	38	10	41.3
3DP 65-125/7.56	7,5	10	132	24	8	27.3	38	10	41.3
3DP 65-160/9.26	9,2	12,5	132	24	8	27.3	38	10	41.3
3DP 65-160/116	11	15	160	24	8	27.3	42	12	45.3
3DP 65-160/156	15	20	160	24	8	27.3	42	12	45.3
3DP 65-200/156	15	20	160	24	8	27.3	42	12	45.3
3DP 65-200/18.56	18,5	25	160	24	8	27.3	42	12	45.3
3DP 65-200/226	22	30	180	24	8	27.3	48	14	51.8

The contents of this publication must not be regarded as binding. EBARA Pumps Europe S.p.A. reserves the right to effect any modification it deems necessary without prior notice.

3D SERIES

CENTRIFUGAL PUMPS CLOSE COUPLED AND STANDARDIZED EN 733

SECTIONAL VIEW 3D SERIES 32, 40, 50, 65 - up to 11 kW

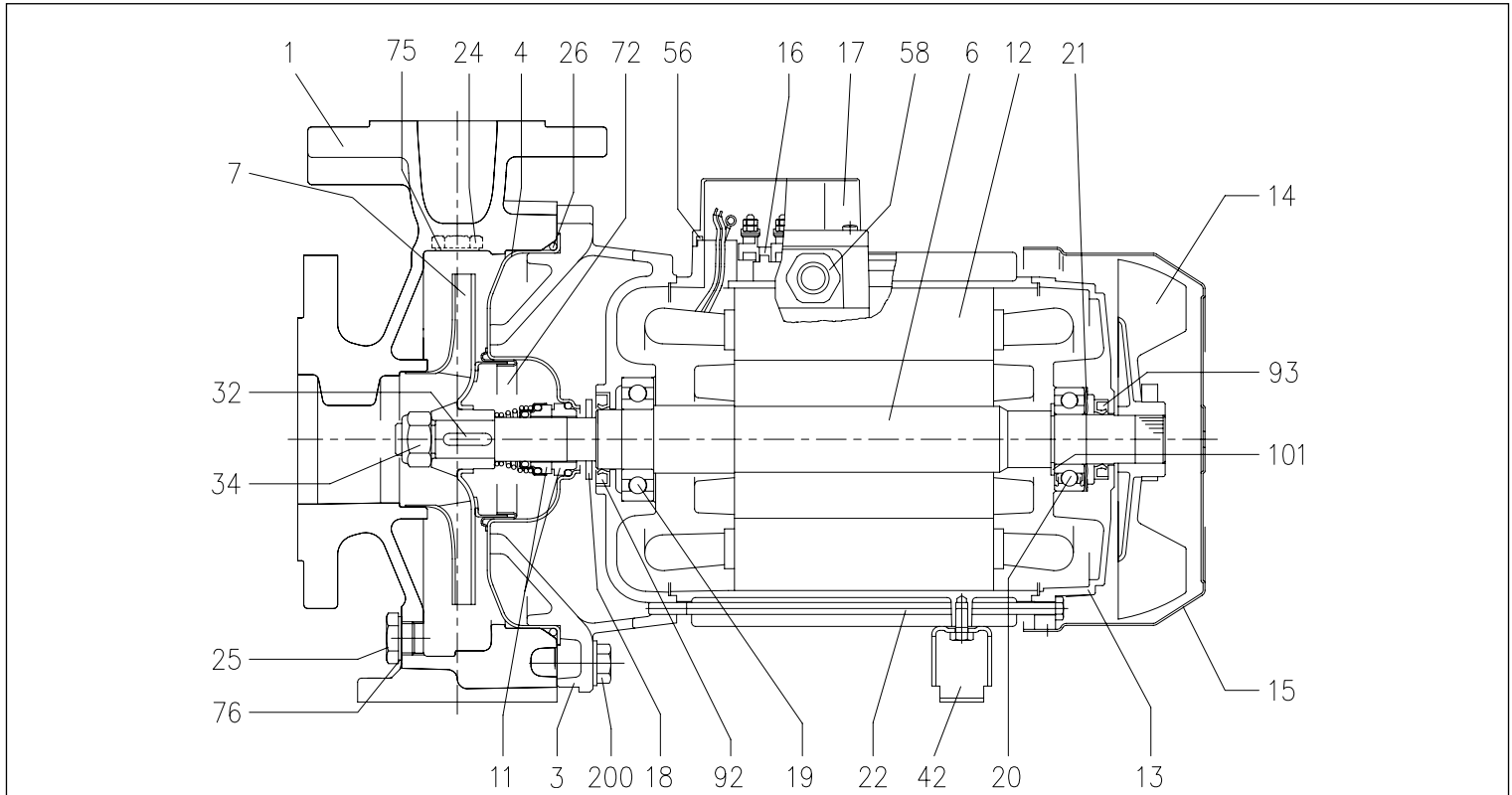

SECTIONAL VIEW 3D SERIES 32, 40, 50, 65 - from 15 kW and above

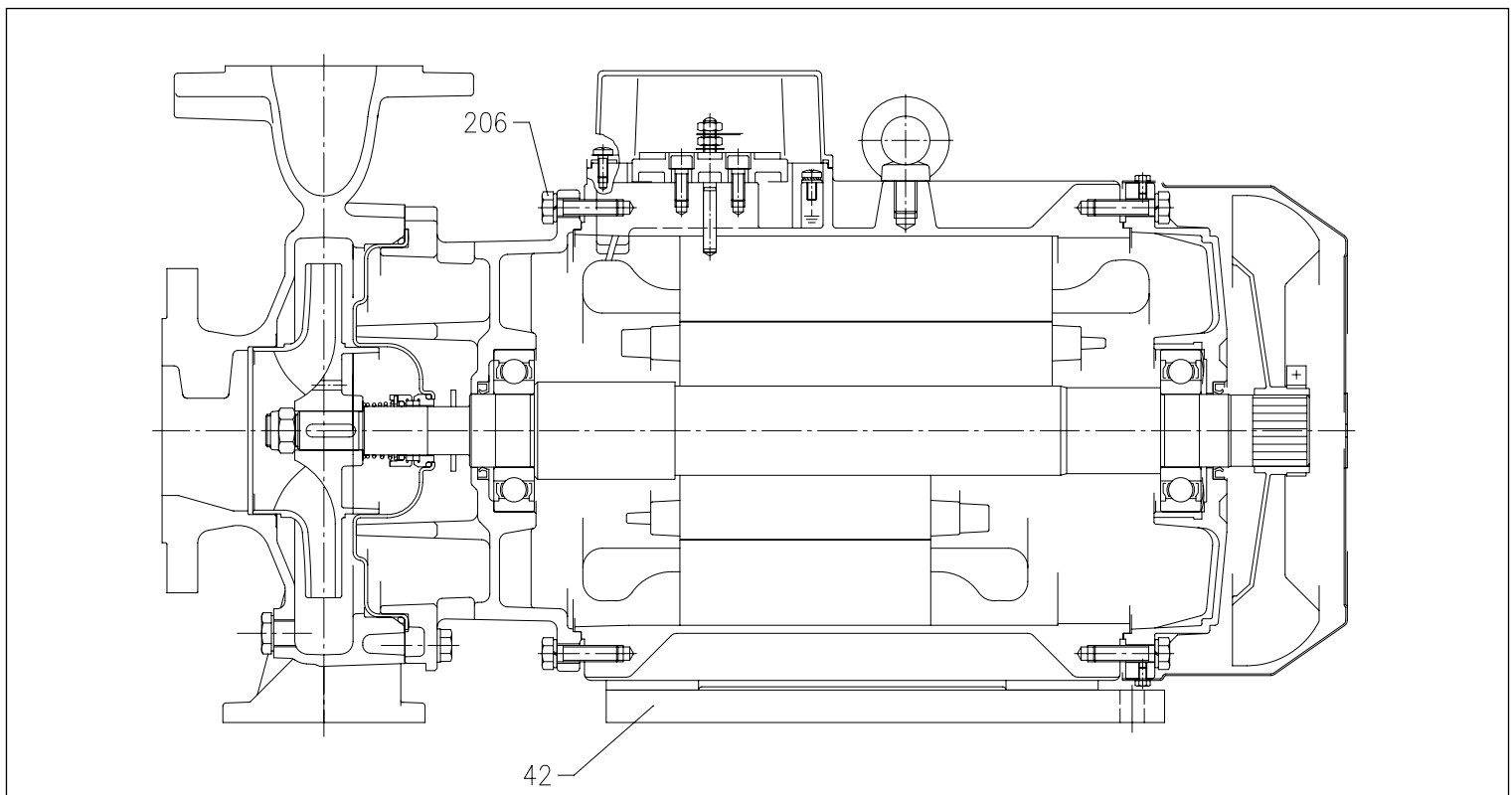

The contents of this publication must not be regarded as binding. EBARA Pumps Europe S.p.A. reserves the right to effect any modification it deems necessary, without prior notice.



3D SERIES

CENTRIFUGAL PUMPS CLOSE COUPLED AND STANDARDIZED EN 733

MATERIALS TABLE

Ref.	Name	Material
001	Pump casing	Cast iron EN-GJL-250-EN 1561
003	Motor bracket	[1]
004	Seal housing disc	EN 1.4301 (AISI 304)
006	Rotor shaft (part in contact with the liquid)	EN 1.4301 (AISI 304)
007	Impeller	[2]
011	Mechanical seal	Ceramic/Carbon/NBR
012	Motor frame	-
013	Motor cover	Aluminium
014	Fan	PA
015	Fan cover	Fe P04 Galvanized
016	Terminal box	-
017	Terminal box cover	Aluminium (three phase only)
018	Spray protector washer	NBR
019	Bearing (pump side)	-
020	Bearing (motor side)	-
021	Adjusting ring	Steel C70
022	Tie-rod	Fe 42 Galvanized
	Screw	Galvanized steel 8.8 class ISO 898-1
024	Plug	Brass
025	Plug	Brass
026	O-Ring	NBR [3]
032	Key	EN 1.4401 (AISI 304)
034	Impeller nut	EN 1.4301 (AISI 304)
042	Motor support	Aluminium / Galvanized steel
056	Terminal box gasket	NBR
058	Cable gland	-
072	Casing ring [4]	EN 1.4301 (AISI 304)
075	Washer	Aluminium
076	Washer	Aluminium
092	Seal ring	-
093	Seal ring	-
101	Seeger ring [5]	Carbon steel TC 80
200	Screw	Galvanized steel 8.8 class ISO 898-1
235	Washer	Galvanized steel
206	Screw (support) [6]	Galvanized steel 8.8 class ISO 898-1

[1]= Cast iron EN-GJL-200-EN 1561 for 3D SERIES 32-200/3 and models from 15, 18.5 and 22 kW; aluminium AL-EN-1706-AC-46000-D for the rest of the range

[2]= EN 1.4301 (AISI 304) for 3D SERIES 32, 40, 50; EN 1.4401 (AISI 316) for 3D SERIES 65

[3]= FPM for H, HS, HW, HSW versions; EDPM for E version

[4]= Only for 3D SERIES 32-200, 40-200, 50-160, 50-200

[5]= Only for 9,2 and 11 kW models

[6]= Only for 11 kW models

3D SERIES

CENTRIFUGAL PUMPS CLOSE COUPLED AND STANDARDIZED EN 733

SECTIONAL VIEW 3DS SERIES 32, 40, 50

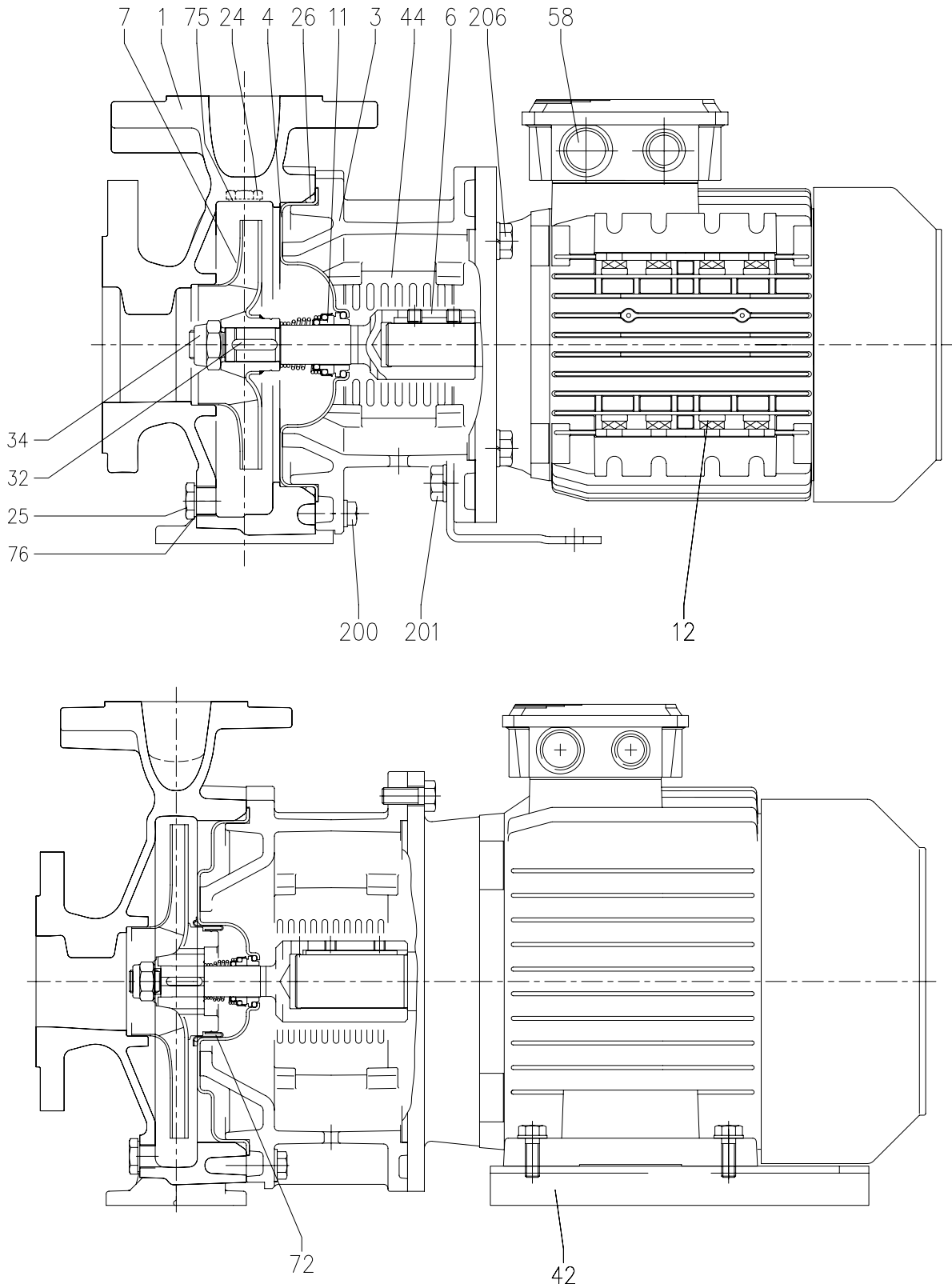

The contents of this publication must not be regarded as binding. EBARA Pumps Europe S.p.A. reserves the right to effect any modification it deems necessary, without prior notice.

3D SERIES

CENTRIFUGAL PUMPS CLOSE COUPLED AND STANDARDIZED EN 733

SECTIONAL VIEW 3DS SERIES 65

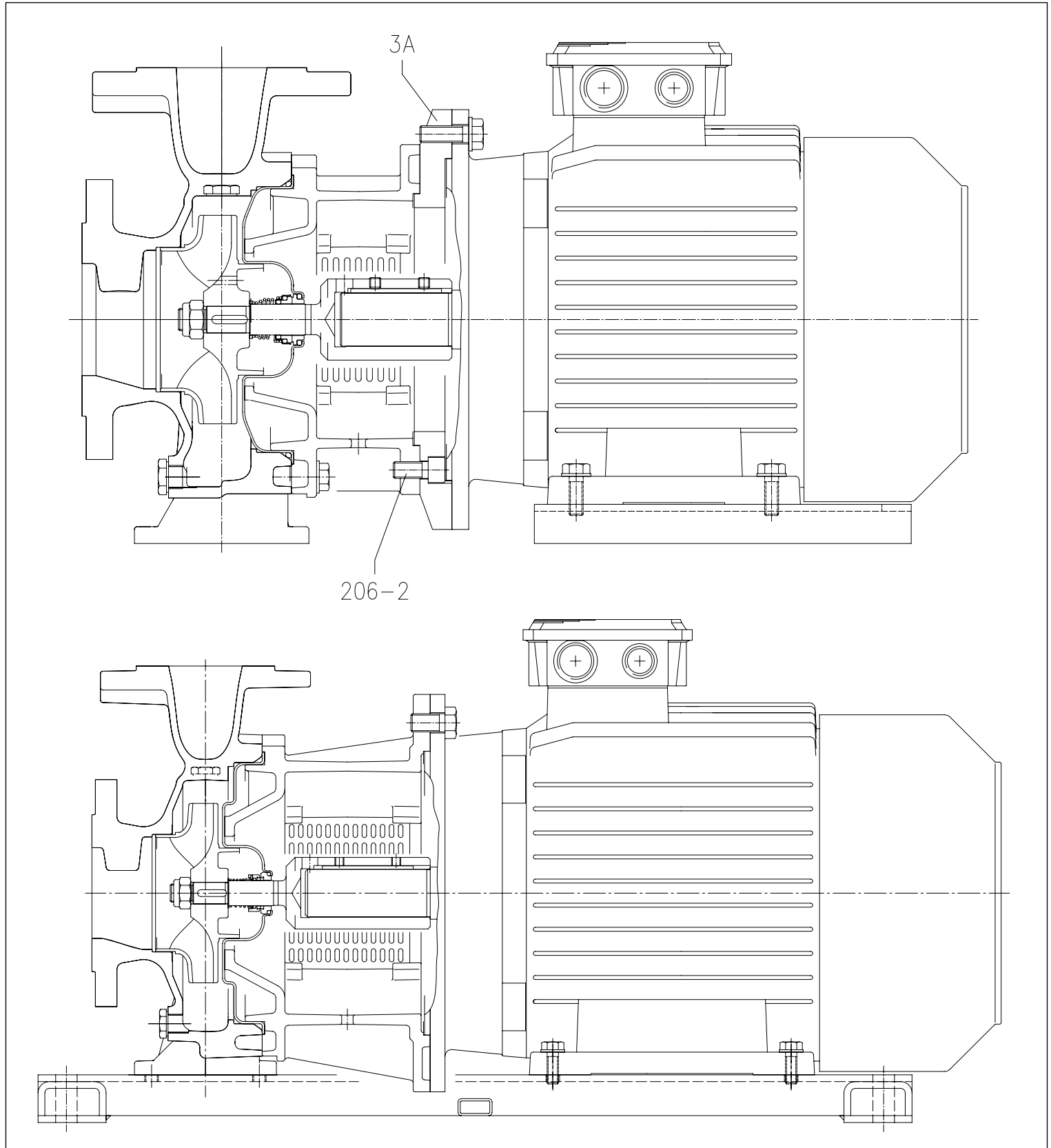

The contents of this publication must not be regarded as binding. EBARA Pumps Europe S.p.A. reserves the right to effect any modification it deems necessary without prior notice.



3D SERIES

CENTRIFUGAL PUMPS CLOSE COUPLED AND STANDARDIZED EN 733

MATERIALS TABLE

Ref.	Name	Material
001	Pump casing	Cast iron EN-GJL-250-EN 1561
003	Motor bracket	Cast iron EN-GJL-250-EN 1561
003A	Adapter ring [1]	Cast iron EN-GJL-250-EN 1561
004	Rotor shaft	EN 1.4301 (AISI 304)
006	Joint (part in contact with the liquid)	EN 1.4301 (AISI 304)
007	Impeller	[2]
011	Mechanical seal	Ceramic/Carbon/NBR
012	Motor	-
024	Plug	Brass
025	Plug	Brass
026	O-Ring	NBR [3]
032	Key	EN 1.4401 (AISI 304)
034	Impeller nut	EN 1.4301 (AISI 304)
042	Motor support	Galvanized steel
044	Support protection	EN 1.4301 (AISI 304)
058	Cable gland	-
072	Casing ring [4]	EN 1.4301 (AISI 304)
075	Washer	Aluminium
076	Washer	Aluminium
200	Screw	Galvanized steel 8.8 class ISO 898-1
201	Screw [5]	Galvanized steel 8.8 class ISO 898-1
206	Screw (support)	Galvanized steel 8.8 class ISO 898-1
206-2	Adapter ring screw	Galvanized steel 8.8 class ISO 898-1
235	Washer	Galvanized steel

[1]= Only for 3D SERIES 65-125/5.5 and 65-125/7.5 models

[2]= EN 1.4301 (AISI 304) for 3D SERIES 32, 40, 50; EN 1.4401 (AISI 316) for 3D SERIES 65

[3]= FPM for H, HS, HW, HSW versions; EPDM for E version

[4]= Only for 3D SERIES 32-200, 40-200, 50-160, 50-200

[5]= Only for 3D SERIES 32-125/1.1, 32-160/1.5, 32-160/2.2, 40-125/1.5, 40-125/2.2, 50-125/2.2

SECTIONAL VIEW 3DP SERIES 32, 40, 50, 65

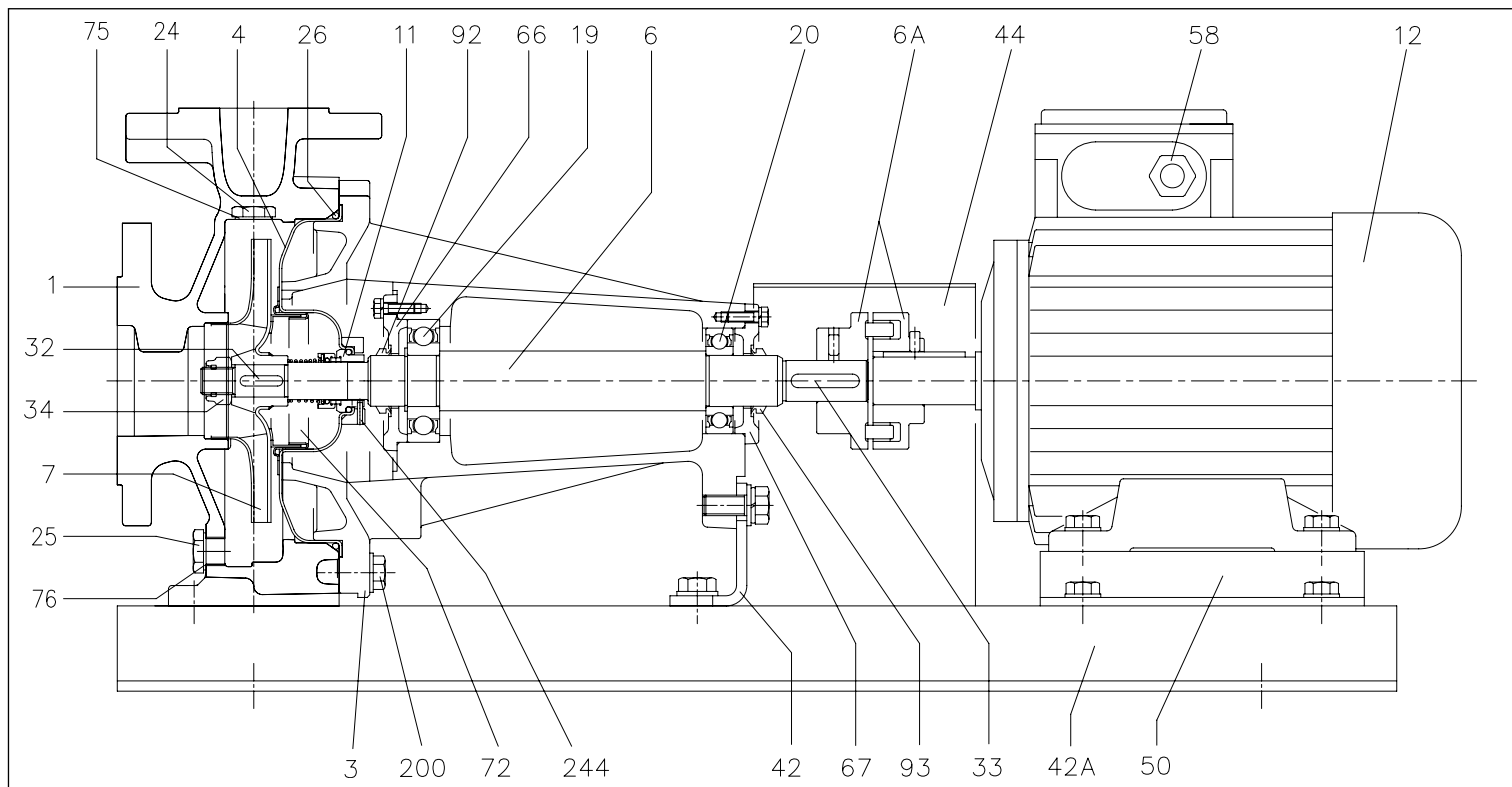

MATERIALS TABLE

Ref.	Name	Material
001	Pump casing	Cast iron EN-GJL-250-EN 1561
003	Motor bracket	Cast iron EN-GJL-250-EN 1561
004	Seal housing disc	EN 1.4301 (AISI 304)
006	Shaft (part in contact with the liquid)	EN 1.4301 (AISI 304)
006A	Flexible joint	Cast iron EN-GJL-250-EN 1561
007	Impeller	[1]
011	Mechanical seal	Ceramic/Carbon/NBR
012	Motor	-
019	Bearing	-
020	Bearing	-
024	Plug	Brass
025	Plug	Brass
026	O-Ring	NBR [2]
032	Key	EN 1.4401 (AISI 316)
033	Key	C 40
034	Impeller nut	EN 1.4301 (AISI 304)
042	Pump support	Fe 37 Galvanized
042A	Base	Fe 37 Galvanized
044	Support protection	Fe 37 Galvanized
050	Motor support	Aluminium / Galvanized steel
058	Cable gland	-
066	Bearing cover (impeller side)	Cast iron EN-GJL-250-EN 1561
067	Bearing cover (motor side)	Cast iron EN-GJL-250-EN 1561
072	Casing ring [3]	EN 1.4301 (AISI 304)
075	Washer	Aluminium
076	Washer	Aluminium
092	V ring	-
093	V ring	-
200	Screw	Galvanized steel 8.8 class ISO 898-1
235	Washer	Galvanized steel

[1]= EN 1.4301 (AISI 304) for 3D SERIES 32, 40, 50; EN 1.4401 (AISI 316) for 3D SERIES 65

[2]= FPM for H, HS, HW, HSW versions; EPDM for E version

[3]= Only for 3D SERIES 32-200, 40-200, 50-160, 50-200

3D SERIES

CENTRIFUGAL PUMPS CLOSE COUPLED AND STANDARDIZED EN 733

MECHANICAL SEAL standard version

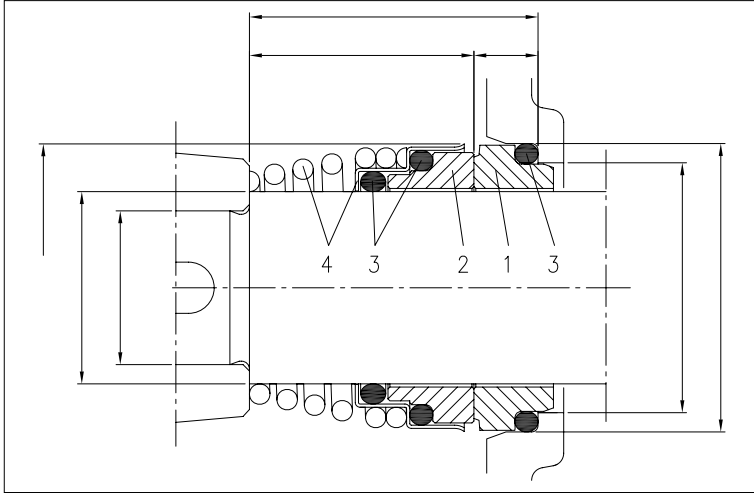

MATERIALS TABLE

Ref.	Name	Material
1	Fixed part	Carbon
2	Rotating part	Ceramic
3	Gasket	NBR
4	Frame + spring	EN 1.4401 (AISI 316)

SPECIAL MECHANICAL SEALS (on request)

Ref.	Name	H version	HS version	Material HW version	HSW version	E version
1	Fixed part	Carbon	SiC	Tungsten Carbide	Tungsten Carbide	Carbon
2	Rotating part	Ceramic	SiC	Tungsten Carbide	SiC	Ceramic
3	Gasket	FPM	FPM	FPM	FPM	EPDM
4	Frame + spring	EN 1.4401 (AISI 316)	EN 1.4571 (AISI 316Ti)	EN 1.4401 (AISI 316)	EN 1.4401 (AISI 316)	EN 1.4401 (AISI 316)

3D SERIES

CENTRIFUGAL PUMPS CLOSE COUPLED AND STANDARDIZED EN 733

ELECTRIC DATA TABLE 3D SERIES

Model	P ₂		Efficiency (%) Three phase (380V)			Efficiency (%) Three phase (460V)			Input [kW]	Absorbed current [A] Three phase			
	[HP]	[kW]	50%	η %		50%	η %			220V	380V	460V	660V
				75%	100%		75%	100%					
3D 32-125/2.26	3,0	2,2	80.5	83.3	83.5	77.3	82.4	84.1	2.9	7.0	4.1	4.1	-
3D 32-160/3.06	4,0	3,0	84.0	85.9	85.2	80.2	83.5	84.6	3.9	10.5	6.1	5.6	-
3D 32-160/4.06	5,5	4,0	83.2	85.8	86.1	81.0	85.1	86.7	5.1	14.7	8.5	8.0	-
3D 32-200/5.56	7,5	5,5	83.4	85.3	85.7	82.9	86.0	87.4	7.0	-	11.6	9.5	6.7
3D 32-200/7.56	10,0	7,5	83.1	85.4	85.8	82.6	86.1	87.5	9.4	-	14.9	12.7	8.6
3D 40-125/3.06	4,0	3,0	84.0	85.9	85.2	80.2	83.5	84.6	3.9	10.5	6.1	5.6	-
3D 40-125/4.06	5,5	4,0	83.2	85.8	86.1	81.0	85.1	86.7	5.1	14.7	8.5	8.0	-
3D 40-160/5.56	7,5	5,5	83.4	85.3	85.7	82.9	86.0	87.4	7.0	-	11.6	9.5	6.7
3D 40-160/7.56	10,0	7,5	83.1	85.4	85.8	82.6	86.1	87.5	9.4	-	14.9	12.7	8.6
3D 40-200/11.6	15,0	11,0	87.3	88.8	88.6	85.9	88.7	89.6	11.3	-	17.7	15.4	10.3
3D 40-200/15.6	20,0	15,0	90.9	91.5	91.0	89.4	91.3	91.8	17.9	-	28.7	25.0	16.6
3D 50-125/5.56	7,5	5,5	83.4	85.3	85.7	82.9	86.0	87.4	7.0	-	11.6	9.5	6.7
3D 50-125/7.56	10,0	7,5	83.1	85.4	85.8	82.6	86.1	87.5	9.4	-	14.9	12.7	8.6
3D 50-160/11.6	15,0	11,0	87.3	88.8	88.6	85.9	88.7	89.6	11.3	-	17.7	15.4	10.3
3D 50-160/15.6	20,0	15,0	90.9	91.5	91.0	89.4	91.3	91.8	17.9	-	28.7	25.0	16.6
3D 65-125/5.56	7,5	5,5	83.4	85.3	85.7	82.9	86.0	87.4	7.0	-	11.6	9.5	6.7
3D 65-125/7.56	10,0	7,5	83.1	85.4	85.8	82.6	86.1	87.5	9.4	-	14.9	12.7	8.6
3D 65-160/9.26	13,0	9,2	87.3	88.8	88.6	85.9	88.7	89.6	11.3	-	17.7	15.4	10.3
3D 65-160/11.6	15,0	11,0	91.9	91.8	91.2	90.9	92.0	91.9	13.2	-	18.3	18.3	10.5
3D 65-160/15.6	20,0	15,0	90.9	91.5	91.0	89.4	91.3	91.8	17.9	-	28.7	25.0	16.6
3D 65-200/15.6	20,0	15,0	90.9	91.5	91.0	89.4	91.3	91.8	17.9	-	28.7	25.0	16.6
3D 65-200/18.56	25,0	18,5	91.7	92.8	92.5	90.3	92.1	92.9	21.9	-	34.8	31.0	20.1
3D 65-200/22.6	30,0	22,0	89.7	91.2	91.3	88.4	91.0	91.7	26.4	-	41.7	36.4	24.0

3D SERIES

CENTRIFUGAL PUMPS CLOSE COUPLED AND STANDARDIZED EN 733

ELECTRIC DATA TABLE 3DS - 3DP SERIES

3DS	Model 3DP	P ₂		Input [kW]	Efficiency (%) Three phase			cos-φ	Absorbed current [A]	
		[HP]	[kW]		50%	η % 75%	100%		Three phase 265V	460V
3DS 32-125/2.26	3DP 32-125/2.26	3	2,2	2.65	79.6	83.2	84.3	0.81	7.1	4.1
3DS 32-160/3.06	3DP 32-160/3.06	4	3	3.56	80.7	84.4	85.5	0.86	9.0	5.2
3DS 32-160/4.06	3DP 32-160/4.06	5,5	4	4.70	81.3	84.2	85.0	0.83	12.3	7.1
3DS 32-200/5.56	3DP 32-200/5.56	7,5	5,5	6.22	83.5	86.6	87.8	0.84	-	9.3
3DS 32-200/7.56	3DP 32-200/7.56	10	7,5	8.36	86.3	88.7	89.3	0.86	-	12.2
3DS 40-125/3.06	3DP 40-125/3.06	4	3	3.56	80.7	84.4	85.5	0.86	9.0	5.2
3DS 40-125/4.06	3DP 40-125/4.06	5,5	4	4.70	81.3	84.2	85.0	0.83	12.3	7.1
3DS 40-160/5.56	3DP 40-160/5.56	7,5	5,5	6.22	83.5	86.6	87.8	0.84	-	9.3
3DS 40-160/7.56	3DP 40-160/7.56	10	7,5	8.36	86.3	88.7	89.3	0.86	-	12.2
3DS 40-200/116	3DP 40-200/116	15	11	12.15	85.2	88.0	90.0	0.82	-	18.6
3DS 40-200/156	3DP 40-200/156	20	15	16.71	88.2	90.1	90.2	0.90	-	23.3
3DS 50-125/5.56	3DP 50-125/5.56	7,5	5,5	6.22	83.5	86.6	87.8	0.84	-	9.3
3DS 50-125/7.56	3DP 50-125/7.56	10	7,5	8.36	86.3	88.7	89.3	0.86	-	12.2
3DS 50-160/116	3DP 50-160/116	15	11	12.15	85.2	88.0	90.0	0.82	-	18.6
3DS 50-160/156	3DP 50-160/156	20	15	16.71	88.2	90.1	90.2	0.90	-	23.3
3DS 65-125/5.56	3DP 65-125/5.56	7,5	5,5	6.22	83.5	86.6	87.8	0.84	-	9.3
3DS 65-125/7.56	3DP 65-125/7.56	10	7,5	8.36	86.3	88.7	89.3	0.86	-	12.2
3DS 65-160/9.26	3DP 65-160/9.26	12,5	9,2	10.40	86.5	88.9	89.5	0.90	-	14.5
3DS 65-160/116	3DP 65-160/116	15	11	12.15	85.2	88.0	90.0	0.82	-	18.6
3DS 65-160/156	3DP 65-160/156	20	15	16.71	88.2	90.1	90.2	0.90	-	23.3
3DS 65-200/156	3DP 65-200/156	20	15	16.71	88.2	90.1	90.2	0.90	-	23.3
3DS 65-200/18.56	3DP 65-200/18.56	25	18,5	20.32	88.7	90.8	90.9	0.82	-	31.1
3DS 65-200/226	3DP 65-200/226	30	22	24.11	-	-	91.3	0.89	-	34.0

3D SERIES

CENTRIFUGAL PUMPS CLOSE COUPLED AND STANDARDIZED EN 733

NOISE DATA TABLES 3D SERIES

Model	P ₂		L _{pa} - dB(A)*
	[HP]	[kW]	
3D 32-125/2.26	3,0	2,2	68
3D 32-160/3.06	4,0	3,0	75
3D 32-160/4.06	5,5	4,0	
3D 32-200/5.56	7,5	5,5	
3D 32-200/7.56	10,0	7,5	78
3D 40-125/3.06	4,0	3,0	75
3D 40-125/4.06	5,5	4,0	
3D 40-160/5.56	7,5	5,5	
3D 40-160/7.56	10,0	7,5	78
3D 40-200/116	15,0	11,0	82
3D 40-200/156	20,0	15,0	
3D 50-125/5.56	7,5	5,5	
3D 50-125/7.56	10,0	7,5	
3D 50-160/116	15,0	11,0	
3D 50-160/156	20,0	15,0	82
3D 65-125/5.56	7,5	5,5	78
3D 65-125/7.56	10,0	7,5	
3D 65-160/9.26	13,0	9,2	
3D 65-160/116	15,0	11,0	82
3D 65-160/156	20,0	15,0	
3D 65-200/156	20,0	15,0	
3D 65-200/18.56	25,0	18,5	
3D 65-200/226	30,0	22,0	

* Mean value of several measures at 1m distance around the pump.
Tolerance ± 2.5 dB.

NOISE DATA TABLES 3DS - 3DP SERIES

Model		P ₂		L _{pa} - dB(A)*
3DS	3DP	[HP]	[kW]	
3DS 32-125/2.26	3DP 32-125/2.26	3	2,2	70
3DS 32-160/3.06	3DP 32-160/3.06	4	3	74
3DS 32-160/4.06	3DP 32-160/4.06	5,5	4	78
3DS 32-200/5.56	3DP 32-200/5.56	7,5	5,5	82
3DS 32-200/7.56	3DP 32-200/7.56	10	7,5	
3DS 40-125/3.06	3DP 40-125/3.06	4	3	74
3DS 40-125/4.06	3DP 40-125/4.06	5,5	4	78
3DS 40-160/5.56	3DP 40-160/5.56	7,5	5,5	82
3DS 40-160/7.56	3DP 40-160/7.56	10	7,5	
3DS 40-200/116	3DP 40-200/116	15	11	84
3DS 40-200/156	3DP 40-200/156	20	15	
3DS 50-125/5.56	3DP 50-125/5.56	7,5	5,5	
3DS 50-125/7.56	3DP 50-125/7.56	10	7,5	
3DS 50-160/116	3DP 50-160/116	15	11	
3DS 50-160/156	3DP 50-160/156	20	15	84
3DS 65-125/5.56	3DP 65-125/5.56	7,5	5,5	
3DS 65-125/7.56	3DP 65-125/7.56	10	7,5	
3DS 65-160/9.26	3DP 65-160/9.26	12,5	9,2	
3DS 65-160/116	3DP 65-160/116	15	11	84
3DS 65-160/156	3DP 65-160/156	20	15	
3DS 65-200/156	3DP 65-200/156	20	15	
3DS 65-200/18.56	3DP 65-200/18.56	25	18,5	
3DS 65-200/226	3DP 65-200/226	30	22	

* Mean value of several measures at 1m distance around the pump.
Tolerance ± 2.5 dB.

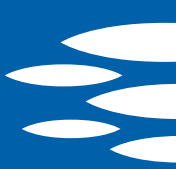

SPECIFIC PERFORMANCE

The specifications below qualify the curves shown in our catalogues and Data Book (see www.ebaraeurope.com). All the performance curves are calculated according to ISO 9906 Attachment A.

Tolerance according to ISO 9906 Attachment A. The curves refer to an effective speed of the 50 Hz asynchronous motors. The measurements are made with water temperature of 20°C and cinematic viscosity of $\nu = 1 \text{ mm}^2/\text{s}$ (1 cSt). During the pump selection, consider to get a safety margin of at least 0.5 m.

The continuous curves indicate the recommended working range. The dotted curve is only a guide.

In order to prevent the risk of overheating, the pumps must not be used at a flow rate below 10% of the maximum efficiency flow rate.

During selection of the pumps, there is a safety margin of at least 1 m.

Symbols:

- Q = Volume flow rate [m^3/h]
- H = Total head [m]
- P¹ = Power absorbed by the electric line
- P² = Pump power input (shaft power)
- η = Pump efficiency
- NPSH = Net positive suction head required by the pump
- MEI = Minimum Efficiency Index

The minimum efficiency index (MEI) is a measure of the quality of a pump size in respect to its mean efficiency. The minimum efficiency index is based on the hydraulic efficiency and on the head at the best efficiency point.

The efficiency of a pump with trimmed impeller is usually lower than that of a pump with the full impeller diameter. The trimming of the impeller will adapt the pump to a fixed duty point, leading to reduced energy consumption. The minimum efficiency index (MEI) is based on the full impeller diameter.

The operation of these water pumps with variable duty points may be more efficient and economic when controlled, for example, by the use of a variable speed drive that matches the pump duty to the system.



DNV

DNV BUSINESS ASSURANCE MANAGEMENT SYSTEM CERTIFICATE

Certificato No. / Certificate No.

INCERT

EBARA PUMPS EUROPE S.p.A.
Sede e Stabilimento
Stabilimento di Cles
Filiale di Palermo
Filiale di Cagliari

(VI) - Italy
(TN) - Italy
(PA) - Italy
(CA) - Italy



Data Prima Emissione/Initial Certification Date:

2006-10-13

Il Certificato è valido fino al:
This Certificate is valid until:

2015-10-10

L'audit è stato eseguito sotto la supervisione di:
The audit has been performed under the supervision of

Michele Gaiba
Lead Auditor



SGQ N°003 A PRD N°003 B
SGA N°003 D SSI N°002 G
SCR N°004 F FSM N°001 I

Membro di MLA EA per gli schemi di accreditamento SGQ, SGA, PRD, PRS, ISP e LAB di MLA IAF per gli schemi di accreditamento SGQ, SGA, SSI, FSM e PRD e di IIRA ILAC per gli schemi di accreditamento LAB

Luogo e Data/Place and Date:

Agrate Brianza (MB), 2012-10-02

Per l'Organismo di Certificazione:
For the Accredited Unit:

Zeno Beltrami

Zeno Beltrami
Management Representative

La validità del presente Certificato è subordinata al rispetto delle condizioni contenute nel Contratto di Certificazione.
Lack of fulfilment of conditions as set out in the Certification Agreement may render this Certificate invalid.

DET NORSKE VERITAS ITALIA SRL - CENTRO DIREZIONALE COLLEONI - PALAZZO SIRIO - V.LE COLLEONI, 9 - 20864 AGRATE BRIANZA (MB) - ITALY - TEL. 039 68 99 905 - WWW.DNVBA.COM/IT

EBARA Pumps Europe network

HEAD OFFICE

EBARA Pumps Europe S.p.A.

Via Pacinotti, 32
36040 Brendola (VI), Italy
Phone +39 0444 706811 - Fax +39 0444 405811

Italian Sales (for order only):
e-mail: ordini@ebaraeurope.com

Export Sales (for order only):
e-mail: exportsales@ebaraeurope.com

Technical Customer Service (TCS):
e-mail: technical_customer_service@ebaraeurope.com
Phone +39 0444 706869/902/923

Marketing & Marketing Communication:
e-mail: marketing@ebaraeurope.com

ITALIAN SALES NETWORK

NORTH-EAST Region:

(Trentino Alto Adige, Veneto, Friuli Venezia Giulia, Emilia Romagna)
Regional Manager mobile: +39 335 6423308
e-mail: nord@ebaraeurope.com
Phone +39 0444 706811 - Fax +39 0444 405811

NORTH-WEST Region:

(Valle d'Aosta, Piemonte, Lombardia, Liguria)
Regional Manager mobile: +39 335 5327276
e-mail: mrtgmi@ebaraeurope.com
Phone +39 0444 706811 - Fax +39 0444 405975

CENTRAL Region:

(Toscana, Umbria, Marche, Lazio, Abruzzo, Molise)
Regional Manager mobile: +39 335 6423286
e-mail: centro@ebaraeurope.com
Phone +39 0444 706811 - Fax +39 0444 405811

SOUTH Region:

(Campania, Basilicata, Puglia, Calabria, Sicilia)
Regional Manager mobile: +39 335 6423316
e-mail: sud@ebaraeurope.com
Phone +39 0444 706811 - Fax +39 0444 405811

INDUSTRIAL Division:

Manager mobile: +39 335 6423302
e-mail: industry@ebaraeurope.com
Phone +39 0444 706811 - Fax +39 0444 405811

WASTEWATER Division:

Manager mobile: +39 335 6423290
e-mail: ses@ebaraeurope.com
Phone +39 0444 706811 - Fax +39 0444 405811

CAGLIARI Branch:

Via del Fangario, 29
09122 Cagliari
Phone +39 070 274281 - Fax +39 0444 405960
Branch Manager mobile: +39 335 6423320
e-mail: mktgca@ebaraeurope.com

PALERMO Branch:

Via Don L. Sturzo, 181/183
Z.I. - 90044 Carini (PA)
Phone +39 091 8668790 - Fax +39 0444 405980
Branch Manager mobile: +39 335 6423316
e-mail: mktgpa@ebaraeurope.com

EXPORT NETWORK

EBARA Pumps Europe S.p.A. UNITED KINGDOM

Unit 7 - Zodiac Business Park
High Road - Cowley Uxbridge
Middlesex - UB8 2GU, United Kingdom
Phone +44 1895 439027 - Fax +44 1895 439028
e-mail: mktguk@ebaraeurope.com

EBARA ESPAÑA BOMBAS S.A.

C/Cormoranes 6 Y 8
Poligono Ind. La Estación
28320 Pinto (Madrid), Spain
Phone +34 916.923.630 - Fax +34 916.910.818
e-mail: marketing@ebara.es

EBARA Pumps Europe S.p.A. FRANCE

555, Rue Juliette Recamier
69970 Chaponnay, France
Phone +33 4 72769482 - Fax +33 805101071
e-mail: mktgfr@ebaraeurope.com

EBARA Pumps Europe S.p.A. GERMANY

Ferdinand-Porsche-Ring 7
63110 Rodgau-Jügesheim, Germany
Phone +49 (0) 6106-660 99-0
Fax +49 (0) 6106-660 99-45
e-mail: mktgde@ebaraeurope.com

EBARA POMPY POLSKA Sp. z o.o.

ul. Działkowa 115
02-234 Warszawa, Poland
Phone +48 22 3909920 - Fax +48 22 3909929
e-mail: mktgpl@ebaraeurope.com

EBARA Pumps Europe S.p.A. MIDDLE EAST

P.O. Box 54515
Dubai Airport Free Zone
Dubai, United Arab Emirates
Phone +971 4 609 1040 - Fax +971 4 609 1038
e-mail: mktgme@ebaraeurope.com

EBARA Pumps Europe S.p.A. SAUDI ARABIA

Phone +966 11 810 4561
Fax +966 11 810 4562

EBARA Pumps Europe S.p.A. INDIA LIAISON OFFICE

1503, Bhumiraj Costarica,
Sector-18, Palm Beach Rd.
Sanpada, Navi Mumbai
Maharashtra, Pin: 400705 - India
Phone +91 22 2781 2862
Fax +91 22 2781 2865
e-mail: mktgind@ebaraeurope.com

EBARA Pumps Europe S.p.A. RUSSIA

Phone +7 985 7672672
e-mail: mktgrus@ebaraeurope.com



EBARA Pumps Europe S.p.A.

Via Pacinotti, 32
36040 Brendola (Vicenza), Italy
Phone +39 0444 706811 - Fax +39 0444 405811
e-mail: marketing@ebaraeurope.com
www.ebaraeurope.com



EBARA Corporation

11-1, Haneda Asahi-cho, Ohta-ku,
Tokyo 144-8510
Japan
Phone +81 3 6275 7598 - Fax +81 3 5736 3193
www.ebara.com

